

116 Elizabeth Drive, Blacksburg, Cherokee County, South Carolina, United States, 29702

Gross Living Area: 1593 sq. ft

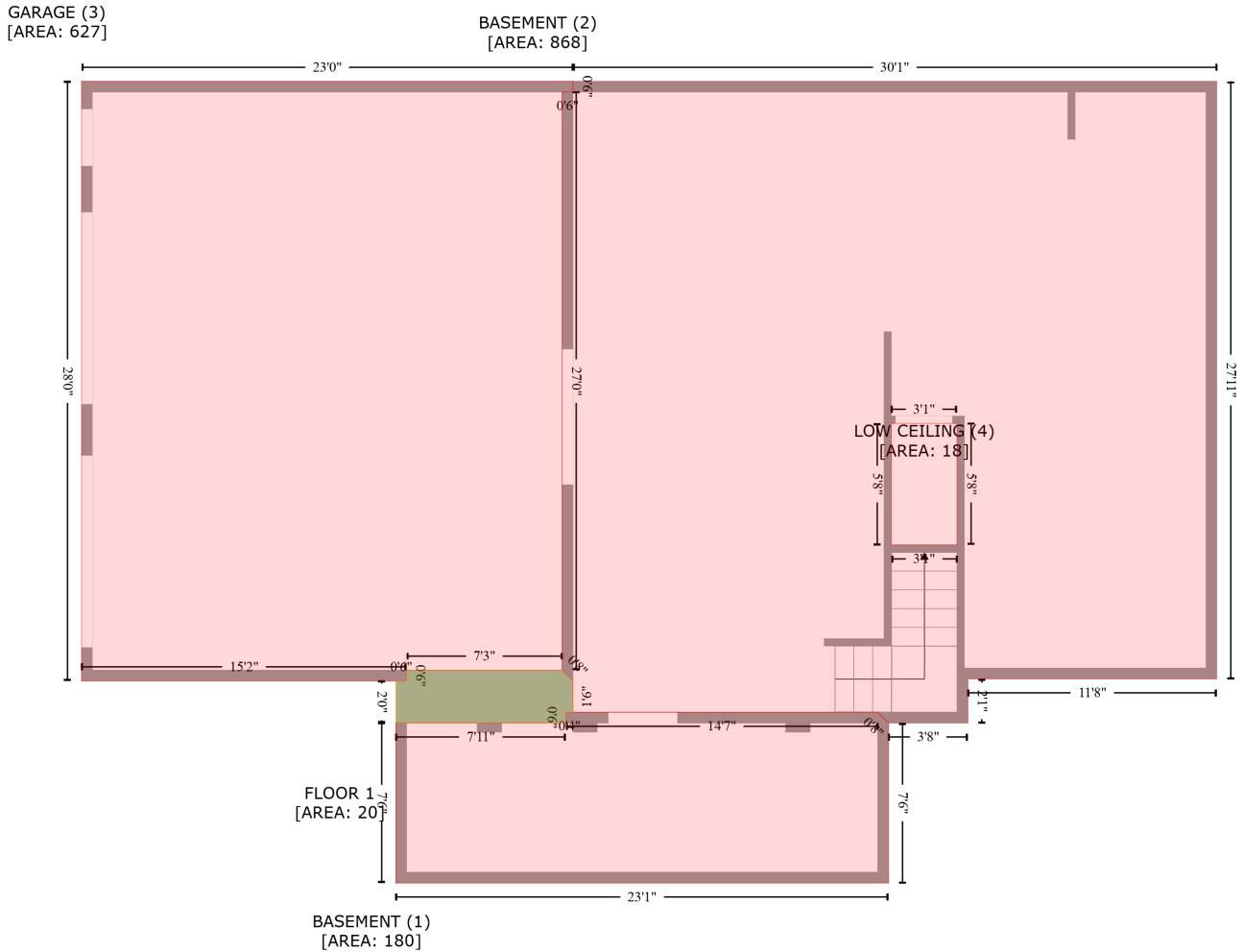

Space	Area (sq. ft)	Calculation <small>Coordinate Polygon Area Algorithm using inches</small>
FLOOR 1 (Living area)	20	$-\left((353.1 + 359.1) * (503.5 - 509.5) + (359.1 + 359.1) * (509.5 - 527.2) + (359.1 + 355.1) * (527.2 - 527.2) + (355.1 + 355.1) * (527.2 - 533.2) + (355.1 + 259.7) * (533.2 - 533.2) + (259.7 + 259.7) * (533.2 - 509.5) + (259.7 + 265.7) * (509.5 - 509.5) + (265.7 + 265.7) * (509.5 - 503.5) + (265.7 + 353.1) * (503.5 - 503.5)\right) * 0.5 + 0.00694$
BASEMENT (Non-living area)	180	$-\left((530.3 + 536.3) * (527.2 - 533.2) + (536.3 + 536.3) * (533.2 - 622.9) + (536.3 + 259.7) * (622.9 - 622.9) + (259.7 + 259.7) * (622.9 - 533.2) + (259.7 + 355.1) * (533.2 - 533.2) + (355.1 + 355.1) * (533.2 - 527.2) + (355.1 + 530.3) * (527.2 - 527.2)\right) * 0.5 + 0.00694$
BASEMENT (Non-living area)	868	$-\left((720.6 + 720.6) * (173.1 - 508.4) + (720.6 + 580.8) * (508.4 - 508.4) + (580.8 + 580.8) * (508.4 - 533.2) + (580.8 + 536.3) * (533.2 - 533.2) + (536.3 + 530.3) * (533.2 - 527.2) + (530.3 + 359.1) * (527.2 - 527.2) + (359.1 + 359.1) * (527.2 - 509.5) + (359.1 + 353.1) * (509.5 - 503.5) + (353.1 + 353.1) * (503.5 - 179.1) + (353.1 + 359.1) * (179.1 - 179.1) + (359.1 + 359.1) * (179.1 - 173.1) + (359.1 + 720.6) * (173.1 - 173.1)\right) * 0.5 + 0.00694 - \left((574.8 + 537.9) * (365 - 365) + (537.9 + 537.9) * (365 - 433.2) + (537.9 + 574.8) * (433.2 - 433.2) + (574.8 + 574.8) * (433.2 - 365)\right) * 0.5 + 0.00694$

116 Elizabeth Drive, Blacksburg, Cherokee County, South Carolina, United States, 29702

Gross Living Area: 1593 sq. ft

Space	Area (sq. ft)	Calculation <small>Coordinate Polygon Area Algorithm using inches</small>
GARAGE (Non-living area)	627	$-\left((359.1 + 359.1) * (173.1 - 179.1) + (359.1 + 353.1) * (179.1 - 179.1) + (353.1 + 353.1) * (179.1 - 503.5) + (353.1 + 265.7) * (503.5 - 503.5) + (265.7 + 265.7) * (503.5 - 509.5) + (265.7 + 83.4) * (509.5 - 509.5) + (83.4 + 83.4) * (509.5 - 173.1) + (83.4 + 359.1) * (173.1 - 173.1)\right) * 0.5 * 0.00694$
LOW CEILING (Non-living area)	18	$-\left((574.8 + 574.8) * (365 - 433.2) + (574.8 + 537.9) * (433.2 - 433.2) + (537.9 + 537.9) * (433.2 - 365) + (537.9 + 574.8) * (365 - 365)\right) * 0.5 * 0.00694$

116 Elizabeth Drive, Blacksburg, Cherokee County, South Carolina, United States, 29702

Gross Living Area: 1593 sq. ft



Space	Area (sq. ft)	Calculation <small>Coordinate Polygon Area Algorithm using inches</small>
FLOOR 2 (Living area)	1593	$-((724 + 724) * (131.7 - 491.7) + (724 + 86.6) * (491.7 - 491.7) + (86.6 + 86.6) * (491.7 - 131.7) + (86.6 + 724) * (131.7 - 131.7)) * 0.5 * 0.00694$
DECK (Non-living area)	215	$-((493.1 + 493.1) * (-7.5 - 131.6) + (493.1 + 270.3) * (131.6 - 131.7) + (270.3 + 270.3) * (131.7 - -7.5) + (270.3 + 493.1) * (-7.5 - -7.5)) * 0.5 * 0.00694$
PORCH (Non-living area)	224	$-((535.5 + 535.5) * (491.7 - 691.6) + (535.5 + 464.6) * (691.6 - 691.6) + (464.6 + 464.6) * (691.6 - 582.7) + (464.6 + 266.2) * (582.7 - 582.7) + (266.2 + 266.2) * (582.7 - 491.7) + (266.2 + 535.5) * (491.7 - 491.7)) * 0.5 * 0.00694$

116 Elizabeth Drive, Blacksburg, Cherokee County, South Carolina, United States, 29702

Gross Living Area: 1593 sq. ft

Space	Area (sq. ft)	Calculation <small>Coordinate Polygon Area Algorithm using inches</small>
		$(491.7 - 491.7) * 0.5 * 0.00694$