

1374 Playmoor Drive, Innisbrook, Palm Harbor, Pinellas County, Florida, United States, 34683

Gross Living Area: 4784 sq. ft

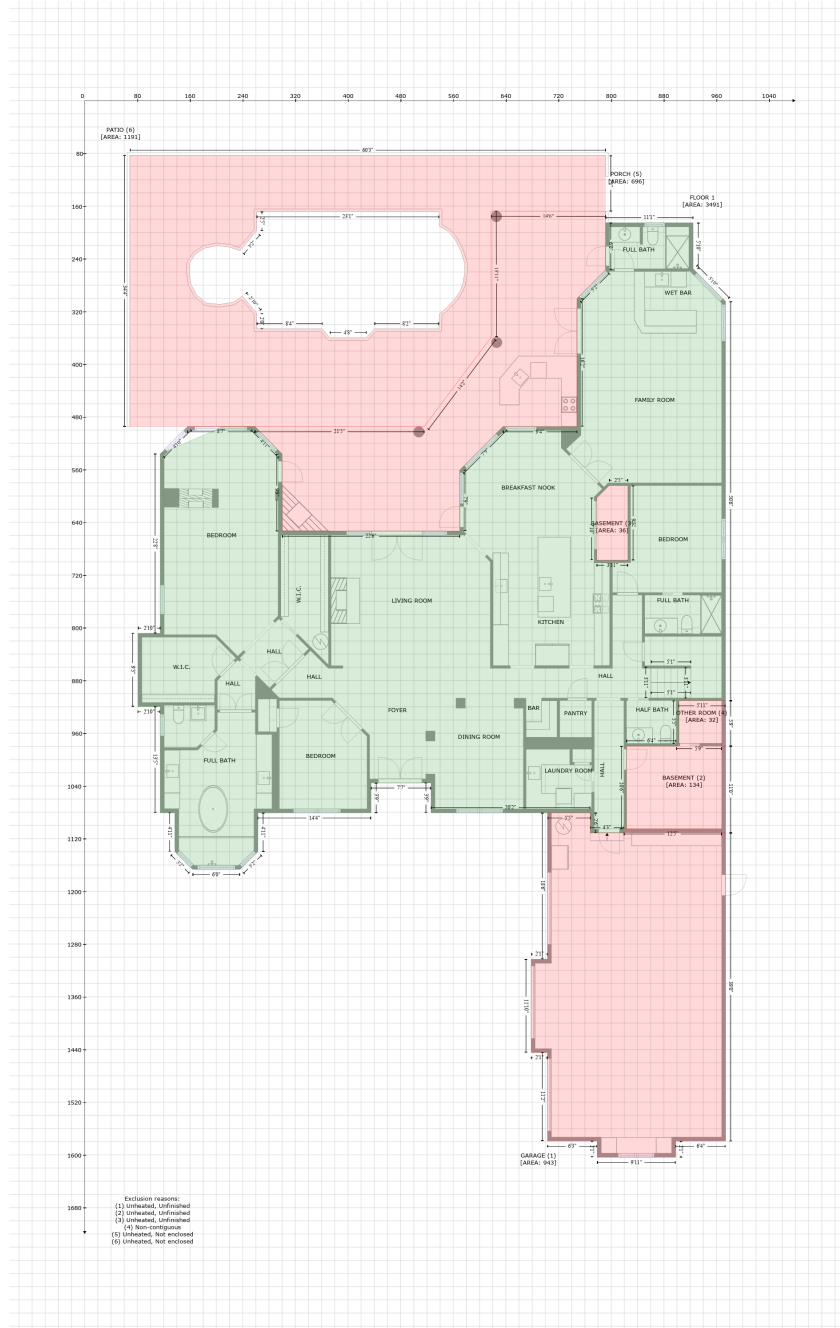

Space	Area (sq. ft)	Calculation
FLOOR 1 (Living area)	3491	Coordinate Polygon Area Algorithm using inches $ \begin{aligned} & -((924.4 + 924.4) * (185.4 - 255.2) + (924.4 + 924.6) * (255.2 - 255.3) + (924.6 + 973.8) * (255.3 - 304.8) \\ & + (973.8 + 973.8) * (304.8 - 910.5) + (973.8 + 902.8) * (910.5 - 910.5) + (902.8 + 902.8) * (910.5 - 975.6) \\ & + (902.8 + 898.8) * (975.6 - 975.6) + (898.8 + 898.8) * (975.6 - 979.6) + (898.8 + 823.2) * (979.6 - 979.6) \\ & + (823.2 + 823.2) * (979.6 - 1105.2) + (823.2 + 819.2) * (1105.2 - 1105.2) + (819.2 + 819.2) * (1105.2 - 1111.2) \\ & + (819.2 + 768.4) * (1111.2 - 1111.2) + (768.4 + 768.4) * (1111.2 - 1080.9) + (768.4 + 526.4) * (1080.9 - 1080.9) \\ & + (526.4 + 526.4) * (1080.9 - 1035.4) + (526.4 + 435.1) * (1035.4 - 1035.4) + (435.1 + 435.1) * (1035.4 - 1080.9) \\ & + (435.1 + 263.2) * \end{aligned} $

1374 Playmoor Drive, Innisbrook, Palm Harbor, Pinellas County, Florida, United States, 34683

Gross Living Area: 4784 sq. ft

Space	Area (sq. ft)	Calculation <small>Coordinate Polygon Area Algorithm using inches</small>
		$(1080.9 - 1080.9) + (263.2 + 263.2) * (1080.9 - 1139.7) + (263.2 + 236) * (1139.7 - 1166.8) + (236 + 164.1) * (1166.8 - 1166.8) + (164.1 + 137) * (1166.8 - 1139.7) + (137 + 137) * (1139.7 - 1080.8) + (137 + 114.8) * (1080.8 - 1080.8) + (114.8 + 114.8) * (1080.8 - 919.6) + (114.8 + 80.9) * (919.6 - 919.6) + (80.9 + 80.9) * (919.6 - 808.5) + (80.9 + 114.8) * (808.5 - 808.5) + (114.8 + 114.8) * (808.5 - 536) + (114.8 + 211.1) * (536 - 494.7) + (211.1 + 258.8) * (494.7 - 494.6) + (258.8 + 299.8) * (494.6 - 536.2) + (299.8 + 299.8) * (536.2 - 653.3) + (299.8 + 570.2) * (653.3 - 653.5) + (570.2 + 570) * (653.5 - 560.6) + (570 + 602.9) * (560.6 - 527.7) + (602.9 + 635.6) * (527.7 - 494.7) + (635.6 + 748.1) * (494.7 - 494.7) + (748.1 + 748.1) * (494.7 - 300.5) + (748.1 + 769.8) * (300.5 - 278.9) + (769.8 + 791.5) * (278.9 - 256.9) + (791.5 + 791.5) * (256.9 - 185.4) + (791.5 + 924.4) * (185.4 - 185.4) * 0.5 * 0.00694 + -(825.4 + 796.9) * (584.2 - 584.2) + (796.9 + 789.1) * (584.2 - 591.9) + (789.1 + 778) * (591.9 - 603) + (778 + 778) * (603 - 697.3) + (778 + 825.4) * (697.3 - 697.3) + (825.4 + 825.4) * (697.3 - 584.2) * 0.5 * 0.00694$
GARAGE (Non-living area)	943	$-((768.4 + 768.4) * (1080.9 - 1111.2) + (768.4 + 819.2) * (1111.2 - 1111.2) + (819.2 + 819.2) * (1111.2 - 1105.2) + (819.2 + 967.8) * (1105.2 - 1105.2) + (967.8 + 967.8) * (1105.2 - 1111.2) + (967.8 + 973.8) * (1111.2 - 1111.2) + (973.8 + 973.8) * (1111.2 - 1578.9) + (973.8 + 898) * (1578.9 - 1578.9) + (898 + 898) * (1578.9 - 1603.6) + (898 + 778.7) * (1603.6 - 1603.6) + (778.7 + 778.7) * (1603.6 - 1578.9) + (778.7 + 703.3) * (1578.9 - 1578.9) + (703.3 + 703.3) * (1578.9 - 1444.7) + (703.3 + 678.4) * (1444.7 - 1444.7) + (678.4 + 678.4) * (1444.7 - 1303.2) + (678.4 + 703.3) * (1303.2 - 1303.2) + (703.3 + 703.3) * (1303.2 - 1080.9) + (703.3 + 768.4) * (1080.9 - 1080.9)) * 0.5 * 0.00694$
BASEMENT (Non-living area)	134	$-((967.8 + 967.8) * (975.6 - 979.6) + (967.8 + 973.8) * (979.6 - 979.6) + (973.8 + 973.8) * (979.6 - 1111.2) + (973.8 + 967.8) * (1111.2 - 1111.2) + (967.8 + 967.8) * (1111.2 - 1105.2) + (967.8 + 823.2) * (1105.2 - 1105.2) + (823.2 + 823.2) * (1105.2 - 979.6) + (823.2 + 898.8) * (979.6 - 979.6) + (898.8 + 898.8) * (979.6 - 975.6) + (898.8 + 967.8) * (975.6 - 975.6)) * 0.5 * 0.00694$
BASEMENT (Non-living area)	36	$-((825.4 + 825.4) * (584.2 - 697.3) + (825.4 + 778) * (697.3 - 697.3) + (778 + 778) * (697.3 - 603) + (778 + 789.1) * (603 - 591.9) + (789.1 + 796.9) * (591.9 - 584.2) + (796.9 + 825.4) * (584.2 - 584.2)) * 0.5 * 0.00694$
OTHER ROOM (Non-living area)	32	$-((973.8 + 973.8) * (910.5 - 979.6) + (973.8 + 967.8) * (979.6 - 979.6) + (967.8 + 967.8) * (979.6 - 975.6) + (967.8 + 902.8) * (975.6 - 975.6) + (902.8 + 902.8) * (975.6 - 910.5) + (902.8 + 973.8) * (910.5 - 910.5)) * 0.5 * 0.00694$
PORCH (Non-living area)	696	$-((617.4 + 791.5) * (167.6 - 167.8) + (791.5 + 791.5) * (167.8 - 256.9) + (791.5 + 748.1) * (256.9 - 300.5) + (748.1 + 748.1) * (300.5 - 494.7) + (748.1 + 635.6) * (494.7 - 494.7) + (635.6 + 570) * (494.7 - 560.6) + (570 + 570.2) * (560.6 - 653.5) + (570.2 + 299.8) * (653.5 - 653.3) + (299.8 + 299.8) * (653.3 - 536.2) + (299.8 + 258.9) * (536.2 - 494.7) + (258.9 + 258.6) * (494.7 - 494.6) + (258.6 + 515.9) * (494.6 - 494.5) + (515.9 + 617.8) * (494.5 - 358.7) + (617.8 + 617.4) * (358.7 - 167.6)) * 0.5 * 0.00694$
PATIO (Non-living area)	1191	$-((791.5 + 791.5) * (83.1 - 167.8) + (791.5 + 617.4) * (167.8 - 167.6) + (617.4 + 617.8) * (167.6 - 358.7) + (617.8 + 515.9) * (358.7 - 494.5) + (515.9 + 156.1) * (494.5 - 494.6) + (156.1 + 258.6) * (494.6 - 494.6) + (258.6 + 68.5) * (494.6 - 494.9) + (68.5 + 68.5) * (494.9 - 83.1) + (68.5 + 791.5) * (83.1 - 83.1) * 0.5 * 0.00694 + -(538.8 + 261.4) * (168.5 - 168.5) + (261.4 + 261.4) * (168.5 - 197.3) + (261.4 + 260.4) * (197.3 - 198.4) + (260.4 + 235.9) * (198.4 - 227.7) + (235.9 + 218.6) * (227.7 - 222) + (218.6 + 200.5) * (222 - 220.1) + (200.5 + 182.7) * (220.1 - 223.8) + (182.7 + 168.3) * (223.8 - 232.7) + (168.3 + 159) * (232.7 - 247) + (159 + 158.8) * (247 - 261.4) + (158.8 + 161.6) * (261.4 - 279.1) + (161.6 + 169.9) * (279.1 - 294.8) + (169.9 + 184.8) * (294.8 - 307.1) + (184.8 + 205.2) * (307.1 - 309.2) + (205.2 + 225.8) * (309.2 - 306) + (225.8 + 239.6) * (306 - 296.6) + (239.6 + 261.4) * (296.6 - 322.6) + (261.4 + 261.4) * (322.6 - 346.3) + (261.4 + 360.9) * (346.3 - 346.3) + (360.9 + 372.4) * (346.3 - 360) + (372.4 + 427.9) * (360 - 360) + (427.9 + 440.3) * (360 - 346.3) + (440.3 + 538.3) * (346.3 - 346.3) + (538.3 + 539) * (346.3 - 323.6) + (539 + 549.4) * (323.6 - 314.9) + (549.4 + 561.9) * (314.9 - 301.4) + (561.9 + 570.6) * (301.4 - 289.1) + (570.6 + 574.6) * (289.1 - 278.2) + (574.6 + 577.6) * (278.2 - 260.4) + (577.6 + 577.6) * (260.4 - 247.2) + (577.6 + 571.4) * (247.2 - 227.4) + (571.4 + 562.5) * (227.4 - 210.4) + (562.5 + 552.3) * (210.4 - 198.3) + (552.3 + 538.8) * (198.3 - 190.5) + (538.8 + 538.8) * (190.5 - 168.5)) * 0.5 * 0.00694$

1374 Playmoor Drive, Innisbrook, Palm Harbor, Pinellas County, Florida, United States, 34683

Gross Living Area: 4784 sq. ft

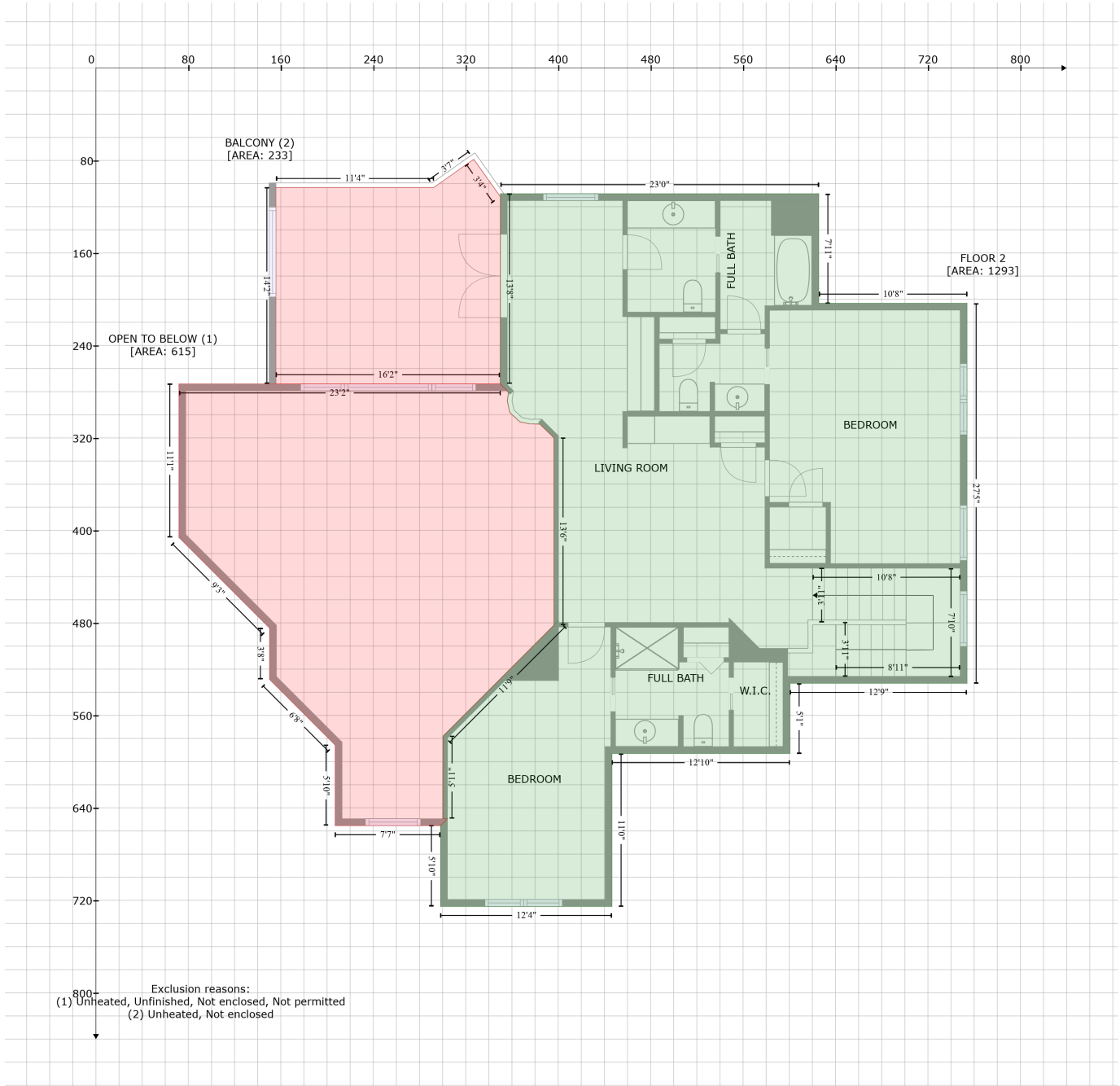

Space	Area (sq. ft)	Calculation
FLOOR 2 (Living area)	1293	Coordinate Polygon Area Algorithm using inches $-((625.5 + 625.5) * (108.8 - 203.5) + (625.5 + 753.8) * (203.5 - 203.5) + (753.8 + 753.8) * (203.5 - 532.2) + (753.8 + 600.7) * (532.2 - 532.2) + (600.7 + 600.7) * (532.2 - 593) + (600.7 + 446.6) * (593 - 593) + (446.6 + 446.6) * (593 - 725.2) + (446.6 + 298.2) * (725.2 - 725.2) + (298.2 + 298.2) * (725.2 - 655.4) + (298.2 + 304.2) * (655.4 - 649.4) + (304.2 + 300.2) * (649.4 - 649.4) + (300.2 + 300.3) * (649.4 - 578) + (300.3 + 393.6) * (578 - 484.5) + (393.6 + 400.3) * (484.5 - 477.9) + (400.3 + 396.4) * (477.9 - 482) + (396.4 + 396.4) * (482 - 320) + (396.4 + 394.8) * (320 - 318.3) + (394.8 + 384.1) * (318.3 - 308.2) + (384.1 + 375.5) * (308.2 - 307.9) + (375.5 + 366.8) * (307.9 -$

1374 Playmoor Drive, Innisbrook, Palm Harbor, Pinellas County, Florida, United States, 34683

Gross Living Area: 4784 sq. ft

Space	Area (sq. ft)	Calculation <small>Coordinate Polygon Area Algorithm using inches</small>
		$306.1 + (366.8 + 358.1) * (306.1 - 297.9) + (358.1 + 356) * (297.9 - 288) + (356 + 356.9) * (288 - 280.8) + (356.9 + 358.5) * (280.8 - 282.1) + (358.5 + 356.5) * (282.1 - 280) + (356.5 + 355.9) * (280 - 279.2) + (355.9 + 350) * (279.2 - 273.3) + (350 + 350) * (273.3 - 108.8) + (350 + 625.5) * (108.8 - 108.8)) * 0.5 * 0.00694$
OPEN TO BELOW (Non-living area)	615	$-((350 + 355.9) * (273.3 - 279.2) + (355.9 + 356.9) * (279.2 - 280.8) + (356.9 + 356) * (280.8 - 288) + (356 + 358.1) * (288 - 297.9) + (358.1 + 366.8) * (297.9 - 306.1) + (366.8 + 375.5) * (306.1 - 307.9) + (375.5 + 384.1) * (307.9 - 308.2) + (384.1 + 396.4) * (308.2 - 320) + (396.4 + 396.4) * (320 - 482.1) + (396.4 + 300.3) * (482.1 - 578) + (300.3 + 300.2) * (578 - 649.4) + (300.2 + 304.2) * (649.4 - 649.4) + (304.2 + 298.2) * (649.4 - 655.4) + (298.2 + 207) * (655.4 - 655.4) + (207 + 207) * (655.4 - 585.7) + (207 + 150.2) * (585.7 - 528.9) + (150.2 + 150.2) * (528.9 - 484.5) + (150.2 + 71.8) * (484.5 - 406.1) + (71.8 + 71.8) * (406.1 - 273.3) + (71.8 + 350) * (273.3 - 273.3)) * 0.5 * 0.00694$
BALCONY (Non-living area)	233	$-((327 + 350) * (78.9 - 111.4) + (350 + 349.7) * (111.4 - 273.3) + (349.7 + 155.8) * (273.3 - 273.2) + (155.8 + 155.8) * (273.2 - 103.5) + (155.8 + 292.2) * (103.5 - 103.5) + (292.2 + 327) * (103.5 - 78.9)) * 0.5 * 0.00694$