

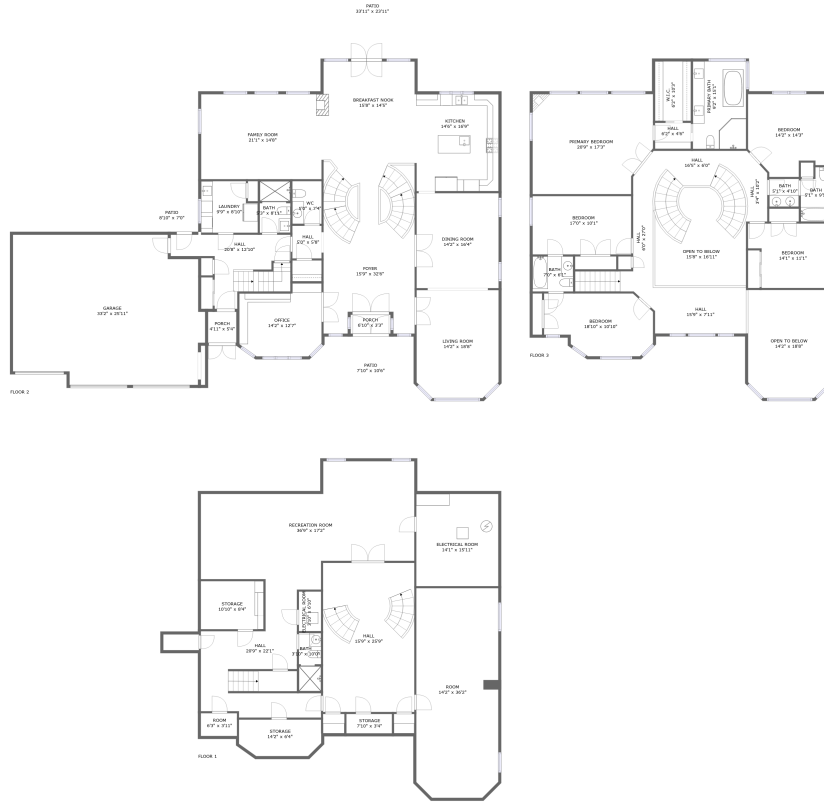



# 2 Waterford Ln,Whitchurch-Stouffville,Ontario,Canada



## Property Summary

 **1** garages      **5** bedrooms      **5** bathrooms      **1** half baths

 **3** floors      **6,596** Gross Living Area sqft      **9,162** total sqft

# 2 Waterford Ln,Whitchurch-Stouffville,Ontario,Canada

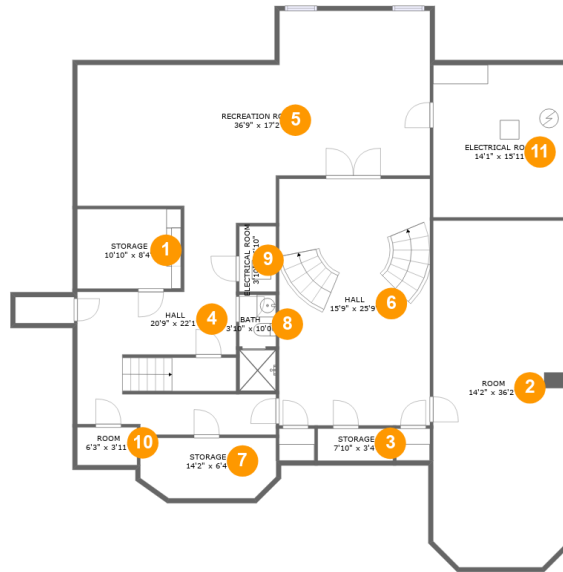

## Room Dimensions

Floor 1

Total sqft: 2543

Living area: 2060

#	Room name	Dimensions	Area (sqft)	Counted as Living Area
1	Storage	10'10" x 8'4"	90 sq. ft	No
2	Room	14'2" x 36'2"	500 sq. ft	Yes
3	Storage	7'10" x 3'4"	26 sq. ft	No
4	Hall	20'9" x 22'1"	288 sq. ft	Yes
5	Recreation Room	36'9" x 17'2"	596 sq. ft	Yes
6	Hall	15'9" x 25'9"	405 sq. ft	Yes
7	Storage	14'2" x 6'4"	84 sq. ft	No
8	Bath	3'10" x 10'0"	38 sq. ft	Yes
9	Electrical Room	3'10" x 6'10"	26 sq. ft	No
10	Room	6'3" x 3'11"	25 sq. ft	Yes
11	Electrical Room	14'1" x 15'11"	225 sq. ft	No

## 2 Waterford Ln,Whitchurch-Stouffville,Ontario,Canada

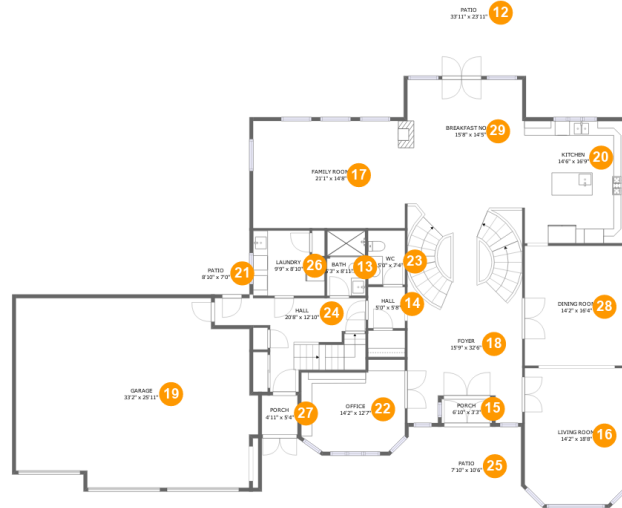

## Room Dimensions

Floor 2

Total sqft: 4103

Living area: 2493

#	Room name	Dimensions	Area (sqft)	Counted as Living Area
12	Patio	33'11" x 23'11"	587 sq. ft	No
13	Bath	5'3" x 8'11"	47 sq. ft	Yes
14	Hall	5'0" x 5'8"	28 sq. ft	Yes
15	Porch	6'10" x 3'3"	22 sq. ft	No
16	Living Room	14'2" x 18'8"	256 sq. ft	Yes
17	Family Room	21'1" x 14'8"	311 sq. ft	Yes
18	Foyer	15'9" x 32'6"	481 sq. ft	Yes
19	Garage	33'2" x 25'11"	789 sq. ft	No
20	Kitchen	14'6" x 16'9"	241 sq. ft	Yes
21	Patio	8'10" x 7'0"	45 sq. ft	No
22	Office	14'2" x 12'7"	157 sq. ft	Yes

Scan captured on Fri, 13 Sep 2024 20:30:39 GMT

Information is calculated by CubiCasa technology; deemed highly reliable but not guaranteed.

## 2 Waterford Ln,Whitchurch- Stouffville,Ontario,Canada

#	Room name	Dimensions	Area (sqft)	Counted as Living Area
23	Wc	5'0" x 7'4"	37 sq. ft	Yes
24	Hall	20'8" x 12'10"	165 sq. ft	Yes
25	Patio	7'10" x 10'6"	82 sq. ft	No
26	Laundry	9'9" x 8'10"	79 sq. ft	Yes
27	Porch	4'11" x 5'4"	26 sq. ft	No
28	Dining Room	14'2" x 16'4"	231 sq. ft	Yes
29	Breakfast Nook	15'8" x 14'5"	223 sq. ft	Yes

# 2 Waterford Ln,Whitchurch-Stouffville,Ontario,Canada

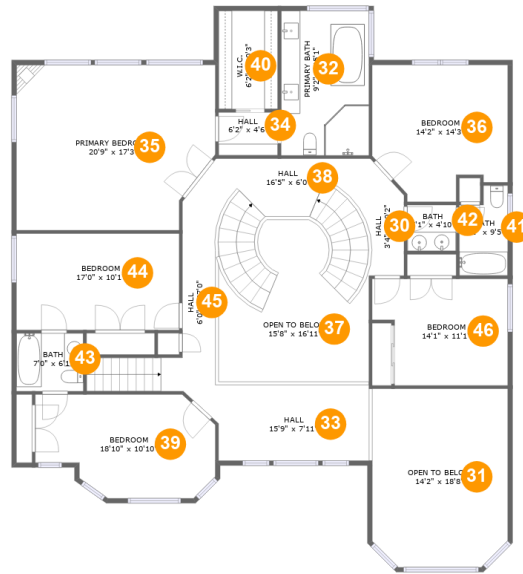

## Room Dimensions

Floor 3

Total sqft: 2516

Living area: 2043

#	Room name	Dimensions	Area (sqft)	Counted as Living Area
30	Hall	3'4" x 10'2"	34 sq. ft	Yes
31	Open To Below	14'2" x 18'8"	256 sq. ft	No
32	Primary Bath	9'2" x 15'1"	138 sq. ft	Yes
33	Hall	15'9" x 7'11"	127 sq. ft	Yes
34	Hall	6'2" x 4'6"	28 sq. ft	Yes
35	Primary Bedroom	20'9" x 17'3"	337 sq. ft	Yes
36	Bedroom	14'2" x 14'3"	179 sq. ft	Yes
37	Open To Below	15'8" x 16'11"	196 sq. ft	No
38	Hall	16'5" x 6'0"	186 sq. ft	Yes
39	Bedroom	18'10" x 10'10"	175 sq. ft	Yes
40	W.i.c.	6'2" x 10'3"	64 sq. ft	Yes

## 2 Waterford Ln,Whitchurch-Stouffville,Ontario,Canada

#	Room name	Dimensions	Area (sqft)	Counted as Living Area
41	Bath	5'1" x 9'5"	42 sq. ft	Yes
42	Bath	5'1" x 4'10"	25 sq. ft	Yes
43	Bath	7'0" x 6'1"	42 sq. ft	Yes
44	Bedroom	17'0" x 10'1"	171 sq. ft	Yes
45	Hall	6'0" x 27'0"	117 sq. ft	Yes
46	Bedroom	14'1" x 11'1"	141 sq. ft	Yes

## 2 Waterford Ln,Whitchurch-Stouffville,Ontario,Canada

### 1 Floor 1 - Storage

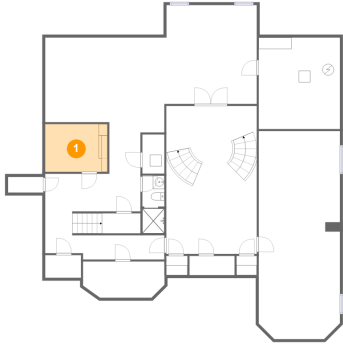

Dimensions: 10'10" x 8'4"  
Area: 90 sq. ft  
Counted as Living Area: No

Heated: No  
Finished: No  
Enclosed: No  
Contiguous: Yes  
Permitted: Yes  
Wet Space: No  
Addition: No  
Conversion: No

### 2 Floor 1 - Room

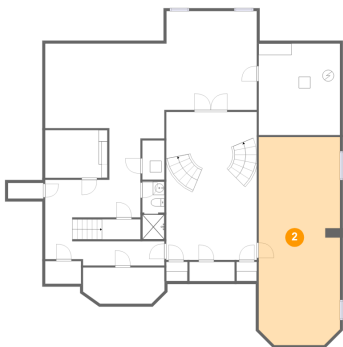

Dimensions: 14'2" x 36'2"  
Area: 500 sq. ft  
Counted as Living Area:  
Yes

Heated: Yes  
Finished: Yes  
Enclosed: Yes  
Contiguous:  
Yes  
Permitted: Yes  
Wet Space: No  
Addition: No  
Conversion: No

## 2 Waterford Ln,Whitchurch-Stouffville,Ontario,Canada

### 3 Floor 1 - Storage

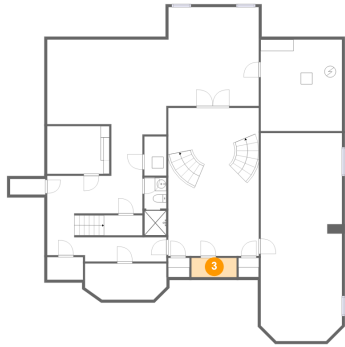

Dimensions: 7'10" x 3'4"  
Area: 26 sq. ft  
Counted as Living Area: No

Heated: No  
Finished: No  
Enclosed: No  
Contiguous: Yes  
Permitted: Yes  
Wet Space: No  
Addition: No  
Conversion: No

### 4 Floor 1 - Hall

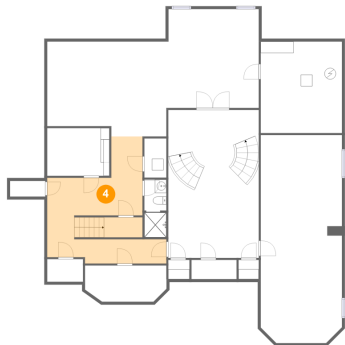

Dimensions: 20'9" x 22'1"  
Area: 288 sq. ft  
Counted as Living Area: Yes

Heated: Yes  
Finished: Yes  
Enclosed: Yes  
Contiguous: Yes  
Permitted: Yes  
Wet Space: No  
Addition: No  
Conversion: No

### 5 Floor 1 - Recreation Room

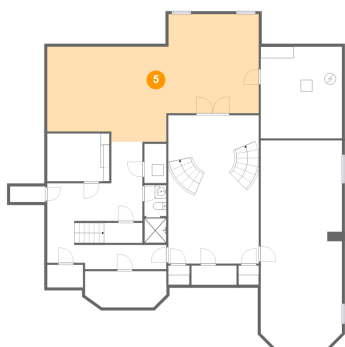

Dimensions: 36'9" x 17'2"  
Area: 596 sq. ft  
Counted as Living Area: Yes

Heated: Yes  
Finished: Yes  
Enclosed: Yes  
Contiguous: Yes  
Permitted: Yes  
Wet Space: No  
Addition: No  
Conversion: No



## 2 Waterford Ln,Whitchurch-Stouffville,Ontario,Canada

### 6 Floor 1 - Hall

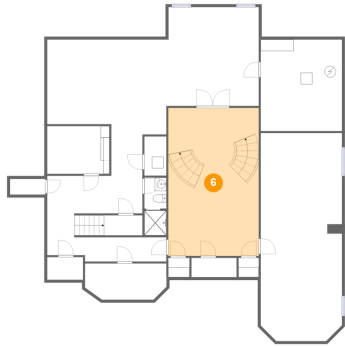

Dimensions: 15'9" x 25'9"  
Area: 405 sq. ft  
Counted as Living Area:  
Yes

Heated: Yes  
Finished: Yes  
Enclosed: Yes  
Contiguous:  
Yes  
Permitted: Yes  
Wet Space: No  
Addition: No  
Conversion: No

### 7 Floor 1 - Storage

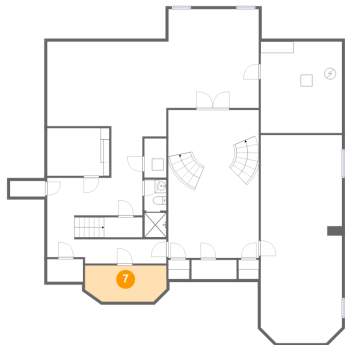

Dimensions: 14'2" x 6'4"  
Area: 84 sq. ft  
Counted as Living Area: No

Heated: No  
Finished: No  
Enclosed: No  
Contiguous: Yes  
Permitted: Yes  
Wet Space: No  
Addition: No  
Conversion: No

### 8 Floor 1 - Bath

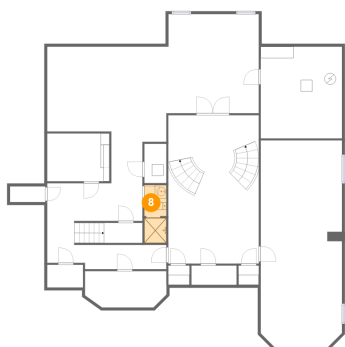

Dimensions: 3'10" x 10'0"  
Area: 38 sq. ft  
Counted as Living Area:  
Yes

Heated: Yes  
Finished: Yes  
Enclosed: Yes  
Contiguous:  
Yes  
Permitted: Yes  
Wet Space: Yes  
Addition: No  
Conversion: No

## 2 Waterford Ln,Whitchurch-Stouffville,Ontario,Canada

### 9 Floor 1 - Electrical Room

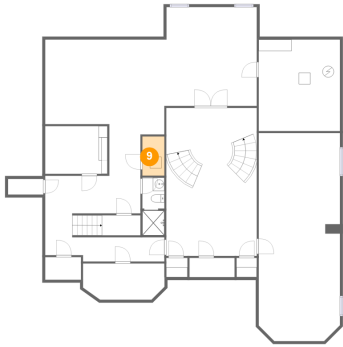

Dimensions: 3'10" x 6'10"  
Area: 26 sq. ft  
Counted as Living Area: No

Heated: No  
Finished: No  
Enclosed: Yes  
Contiguous: Yes  
Permitted: Yes  
Wet Space: No  
Addition: No  
Conversion: No

### 10 Floor 1 - Room

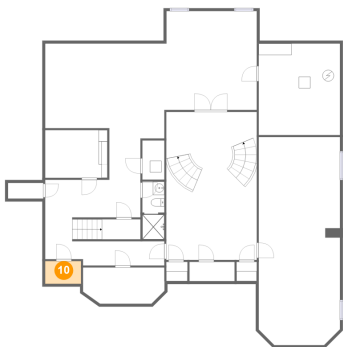

Dimensions: 6'3" x 3'11"  
Area: 25 sq. ft  
Counted as Living Area: Yes

Heated: Yes  
Finished: Yes  
Enclosed: Yes  
Contiguous: Yes  
Permitted: Yes  
Wet Space: No  
Addition: No  
Conversion: No

### 11 Floor 1 - Electrical Room

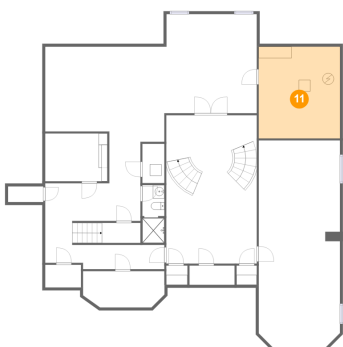

Dimensions: 14'1" x 15'11"  
Area: 225 sq. ft  
Counted as Living Area: No

Heated: No  
Finished: No  
Enclosed: Yes  
Contiguous: Yes  
Permitted: Yes  
Wet Space: No  
Addition: No  
Conversion: No

## 2 Waterford Ln,Whitchurch-Stouffville,Ontario,Canada

### 12 Floor 2 - Patio

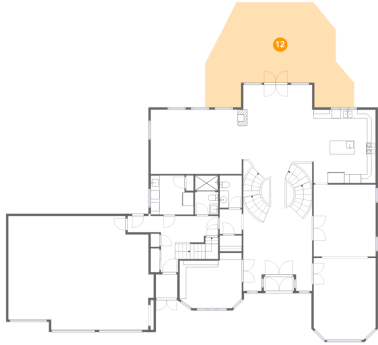

Dimensions: 33'11" x 23'11"  
Area: 587 sq. ft  
Counted as Living Area: No

Heated: No  
Finished: Yes  
Enclosed: No  
Contiguous: Yes  
Permitted: Yes  
Wet Space: No  
Addition: No  
Conversion: No

### 13 Floor 2 - Bath

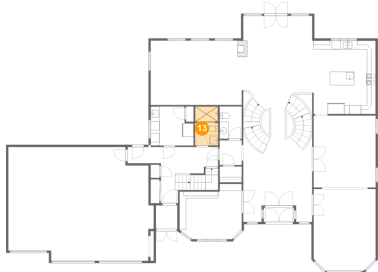

Dimensions: 5'3" x 8'11"  
Area: 47 sq. ft  
Counted as Living Area:  
Yes

Heated: Yes  
Finished: Yes  
Enclosed: Yes  
Contiguous:  
Yes  
Permitted: Yes  
Wet Space: Yes  
Addition: No  
Conversion: No

### 14 Floor 2 - Hall

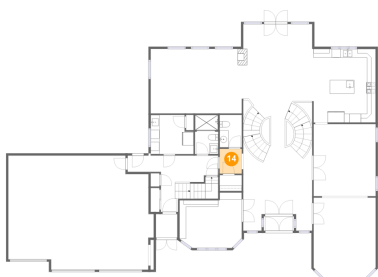

Dimensions: 5'0" x 5'8"  
Area: 28 sq. ft  
Counted as Living Area:  
Yes

Heated: Yes  
Finished: Yes  
Enclosed: Yes  
Contiguous:  
Yes  
Permitted: Yes  
Wet Space: No  
Addition: No  
Conversion: No

## 2 Waterford Ln,Whitchurch-Stouffville,Ontario,Canada

### 15 Floor 2 - Porch

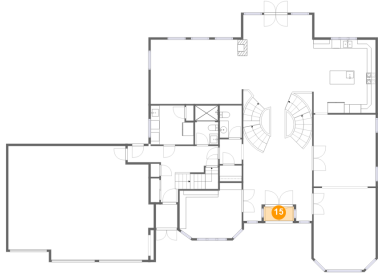

Dimensions: 6'10" x 3'3"  
Area: 22 sq. ft  
Counted as Living Area: No

Heated: No  
Finished: Yes  
Enclosed: No  
Contiguous: Yes  
Permitted: Yes  
Wet Space: No  
Addition: No  
Conversion: No

### 16 Floor 2 - Living Room

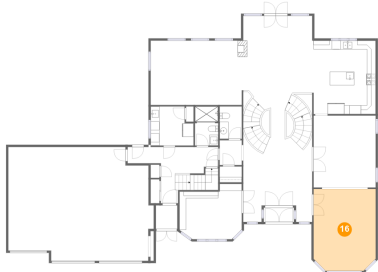

Dimensions: 14'2" x 18'8"  
Area: 256 sq. ft  
Counted as Living Area: Yes

Heated: Yes  
Finished: Yes  
Enclosed: Yes  
Contiguous: Yes  
Permitted: Yes  
Wet Space: No  
Addition: No  
Conversion: No

### 17 Floor 2 - Family Room

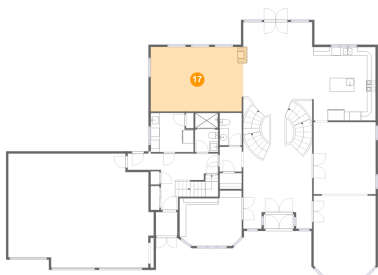

Dimensions: 21'1" x 14'8"  
Area: 311 sq. ft  
Counted as Living Area: Yes

Heated: Yes  
Finished: Yes  
Enclosed: Yes  
Contiguous: Yes  
Permitted: Yes  
Wet Space: No  
Addition: No  
Conversion: No

## 2 Waterford Ln,Whitchurch-Stouffville,Ontario,Canada

### 18 Floor 2 - Foyer

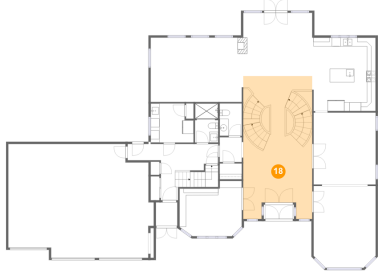

Dimensions: 15'9" x 32'6"  
Area: 481 sq. ft  
Counted as Living Area:  
Yes

Heated: Yes  
Finished: Yes  
Enclosed: Yes  
Contiguous:  
Yes  
Permitted: Yes  
Wet Space: No  
Addition: No  
Conversion: No

### 19 Floor 2 - Garage

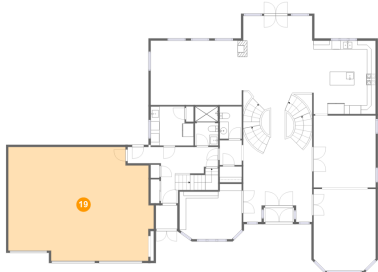

Dimensions: 33'2" x 25'11"  
Area: 789 sq. ft  
Counted as Living Area: No

Heated: No  
Finished: No  
Enclosed: Yes  
Contiguous: Yes  
Permitted: Yes  
Wet Space: No  
Addition: No  
Conversion: No

### 20 Floor 2 - Kitchen

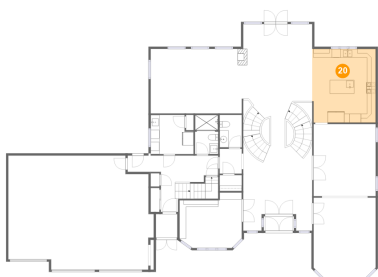

Dimensions: 14'6" x 16'9"  
Area: 241 sq. ft  
Counted as Living Area:  
Yes

Heated: Yes  
Finished: Yes  
Enclosed: Yes  
Contiguous:  
Yes  
Permitted: Yes  
Wet Space: No  
Addition: No  
Conversion: No

## 2 Waterford Ln,Whitchurch-Stouffville,Ontario,Canada

### 21 Floor 2 - Patio

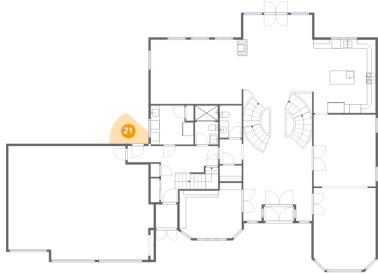

Dimensions: 8'10" x 7'0"  
Area: 45 sq. ft  
Counted as Living Area: No

Heated: No  
Finished: Yes  
Enclosed: No  
Contiguous: Yes  
Permitted: Yes  
Wet Space: No  
Addition: No  
Conversion: No

### 22 Floor 2 - Office

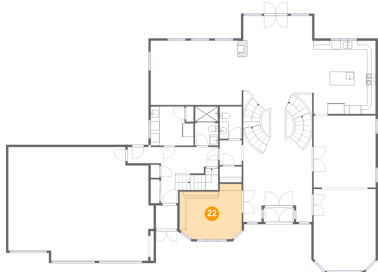

Dimensions: 14'2" x 12'7"  
Area: 157 sq. ft  
Counted as Living Area: Yes

Heated: Yes  
Finished: Yes  
Enclosed: Yes  
Contiguous: Yes  
Permitted: Yes  
Wet Space: No  
Addition: No  
Conversion: No

### 23 Floor 2 - Wc

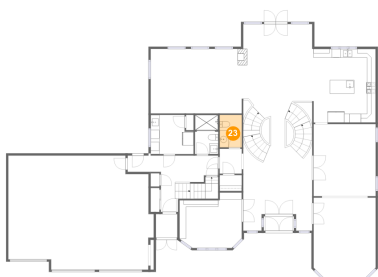

Dimensions: 5'0" x 7'4"  
Area: 37 sq. ft  
Counted as Living Area: Yes

Heated: Yes  
Finished: Yes  
Enclosed: Yes  
Contiguous: Yes  
Permitted: Yes  
Wet Space: Yes  
Addition: No  
Conversion: No

## 2 Waterford Ln,Whitchurch-Stouffville,Ontario,Canada

### 24 Floor 2 - Hall

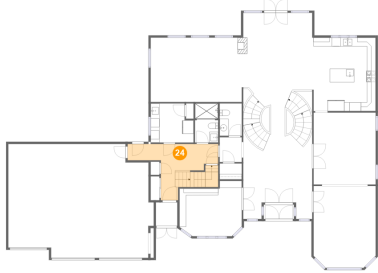

Dimensions: 20'8" x 12'10"  
Area: 165 sq. ft  
Counted as Living Area:  
Yes

Heated: Yes  
Finished: Yes  
Enclosed: Yes  
Contiguous:  
Yes  
Permitted: Yes  
Wet Space: No  
Addition: No  
Conversion: No

### 25 Floor 2 - Patio

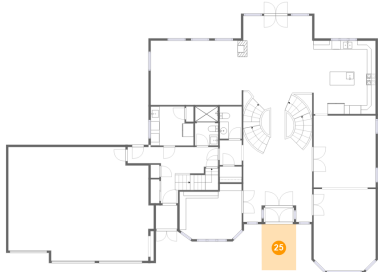

Dimensions: 7'10" x 10'6"  
Area: 82 sq. ft  
Counted as Living Area: No

Heated: No  
Finished: Yes  
Enclosed: No  
Contiguous: Yes  
Permitted: Yes  
Wet Space: No  
Addition: No  
Conversion: No

### 26 Floor 2 - Laundry

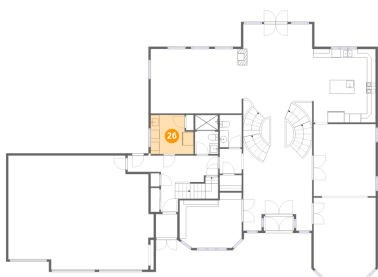

Dimensions: 9'9" x 8'10"  
Area: 79 sq. ft  
Counted as Living Area:  
Yes

Heated: Yes  
Finished: Yes  
Enclosed: Yes  
Contiguous:  
Yes  
Permitted: Yes  
Wet Space: No  
Addition: No  
Conversion: No

## 2 Waterford Ln,Whitchurch-Stouffville,Ontario,Canada

### 27 Floor 2 - Porch

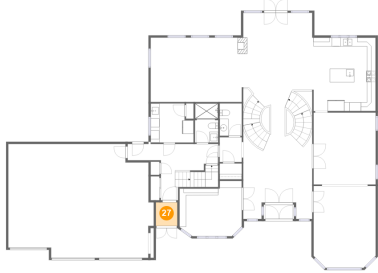

Dimensions: 4'11" x 5'4"  
Area: 26 sq. ft  
Counted as Living Area: No

Heated: No  
Finished: Yes  
Enclosed: No  
Contiguous: Yes  
Permitted: Yes  
Wet Space: No  
Addition: No  
Conversion: No

### 28 Floor 2 - Dining Room

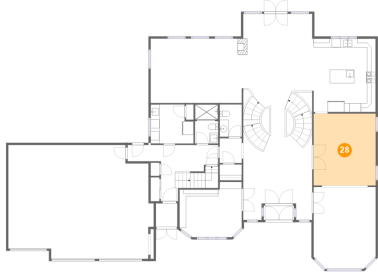

Dimensions: 14'2" x 16'4"  
Area: 231 sq. ft  
Counted as Living Area: Yes

Heated: Yes  
Finished: Yes  
Enclosed: Yes  
Contiguous: Yes  
Permitted: Yes  
Wet Space: No  
Addition: No  
Conversion: No

### 29 Floor 2 - Breakfast Nook

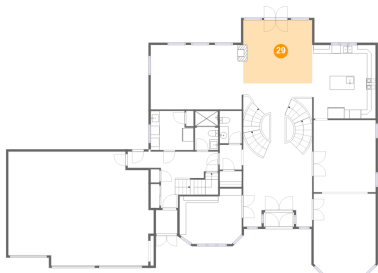

Dimensions: 15'8" x 14'5"  
Area: 223 sq. ft  
Counted as Living Area: Yes

Heated: Yes  
Finished: Yes  
Enclosed: Yes  
Contiguous: Yes  
Permitted: Yes  
Wet Space: No  
Addition: No  
Conversion: No



## 2 Waterford Ln,Whitchurch-Stouffville,Ontario,Canada

### 30 Floor 3 - Hall

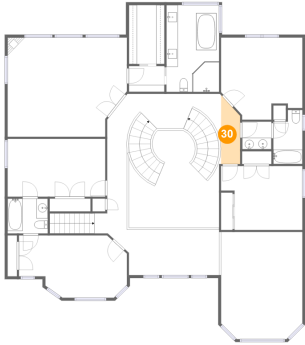

Dimensions: 3'4" x 10'2"  
Area: 34 sq. ft  
Counted as Living Area:  
Yes

Heated: Yes  
Finished: Yes  
Enclosed: Yes  
Contiguous:  
Yes  
Permitted: Yes  
Wet Space: No  
Addition: No  
Conversion: No

### 31 Floor 3 - Open To Below

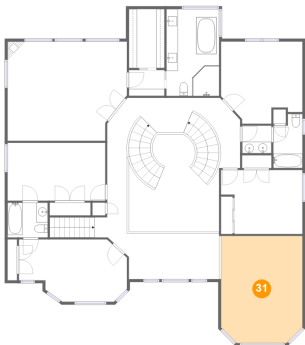

Dimensions: 14'2" x 18'8"  
Area: 256 sq. ft  
Counted as Living Area: No

Heated: No  
Finished: No  
Enclosed: No  
Contiguous: Yes  
Permitted: No  
Wet Space: No  
Addition: No  
Conversion: No

### 32 Floor 3 - Primary Bath

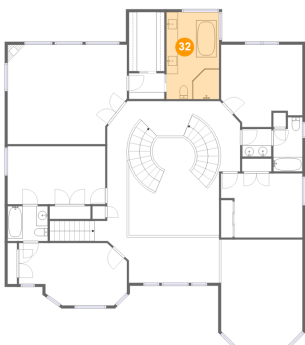

Dimensions: 9'2" x 15'1"  
Area: 138 sq. ft  
Counted as Living Area:  
Yes

Heated: Yes  
Finished: Yes  
Enclosed: Yes  
Contiguous:  
Yes  
Permitted: Yes  
Wet Space: Yes  
Addition: No  
Conversion: No

## 2 Waterford Ln,Whitchurch-Stouffville,Ontario,Canada

### 33 Floor 3 - Hall

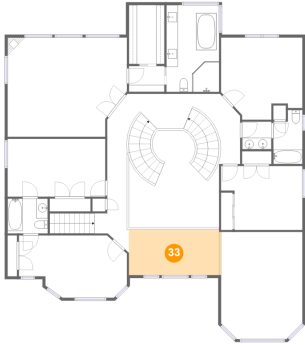

Dimensions: 15'9" x 7'11"  
Area: 127 sq. ft  
Counted as Living Area:  
Yes

Heated: Yes  
Finished: Yes  
Enclosed: Yes  
Contiguous:  
Yes  
Permitted: Yes  
Wet Space: No  
Addition: No  
Conversion: No

### 34 Floor 3 - Hall

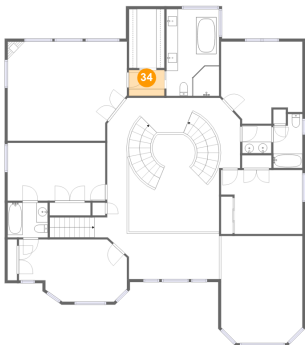

Dimensions: 6'2" x 4'6"  
Area: 28 sq. ft  
Counted as Living Area:  
Yes

Heated: Yes  
Finished: Yes  
Enclosed: Yes  
Contiguous:  
Yes  
Permitted: Yes  
Wet Space: No  
Addition: No  
Conversion: No

### 35 Floor 3 - Primary Bedroom

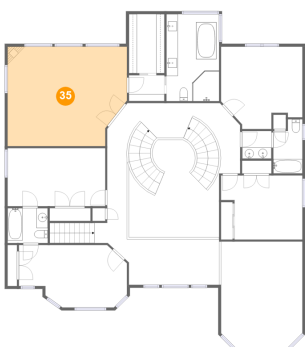

Dimensions: 20'9" x 17'3"  
Area: 337 sq. ft  
Counted as Living Area:  
Yes

Heated: Yes  
Finished: Yes  
Enclosed: Yes  
Contiguous:  
Yes  
Permitted: Yes  
Wet Space: No  
Addition: No  
Conversion: No

## 2 Waterford Ln,Whitchurch-Stouffville,Ontario,Canada

### 36 Floor 3 - Bedroom

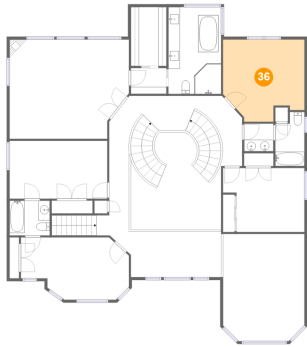

Dimensions: 14'2" x 14'3"  
Area: 179 sq. ft  
Counted as Living Area:  
Yes

Heated: Yes  
Finished: Yes  
Enclosed: Yes  
Contiguous:  
Yes  
Permitted: Yes  
Wet Space: No  
Addition: No  
Conversion: No

### 37 Floor 3 - Open To Below

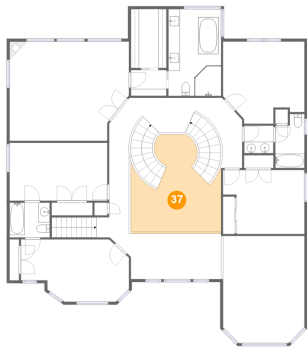

Dimensions: 15'8" x 16'11"  
Area: 196 sq. ft  
Counted as Living Area: No

Heated: No  
Finished: No  
Enclosed: No  
Contiguous: Yes  
Permitted: No  
Wet Space: No  
Addition: No  
Conversion: No

### 38 Floor 3 - Hall

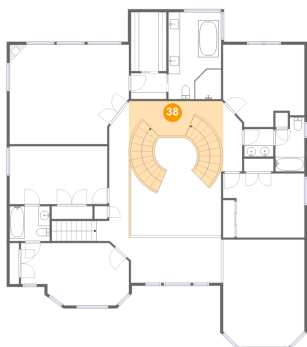

Dimensions: 16'5" x 6'0"  
Area: 186 sq. ft  
Counted as Living Area:  
Yes

Heated: Yes  
Finished: Yes  
Enclosed: Yes  
Contiguous:  
Yes  
Permitted: Yes  
Wet Space: No  
Addition: No  
Conversion: No

## 2 Waterford Ln,Whitchurch-Stouffville,Ontario,Canada

### 39 Floor 3 - Bedroom

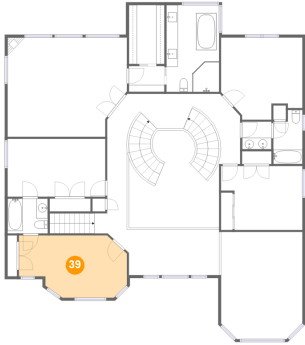

**Dimensions:** 18'10" x 10'10"  
**Area:** 175 sq. ft  
**Counted as Living Area:**  
Yes

**Heated:** Yes  
**Finished:** Yes  
**Enclosed:** Yes  
**Contiguous:**  
Yes  
**Permitted:** Yes  
**Wet Space:** No  
**Addition:** No  
**Conversion:** No

### 40 Floor 3 - W.i.c.

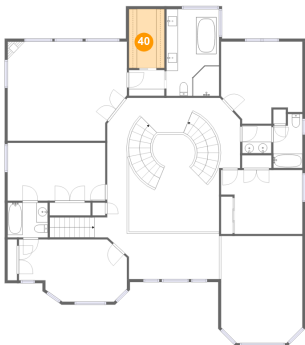

**Dimensions:** 6'2" x 10'3"  
**Area:** 64 sq. ft  
**Counted as Living Area:**  
Yes

**Heated:** Yes  
**Finished:** Yes  
**Enclosed:** Yes  
**Contiguous:**  
Yes  
**Permitted:** Yes  
**Wet Space:** No  
**Addition:** No  
**Conversion:** No

### 41 Floor 3 - Bath

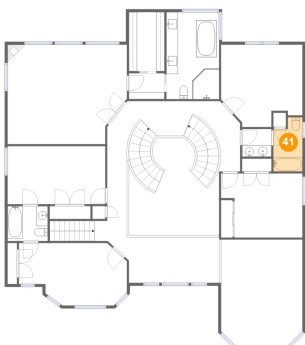

**Dimensions:** 5'1" x 9'5"  
**Area:** 42 sq. ft  
**Counted as Living Area:**  
Yes

**Heated:** Yes  
**Finished:** Yes  
**Enclosed:** Yes  
**Contiguous:**  
Yes  
**Permitted:** Yes  
**Wet Space:** Yes  
**Addition:** No  
**Conversion:** No

## 2 Waterford Ln,Whitchurch-Stouffville,Ontario,Canada

### 42 Floor 3 - Bath

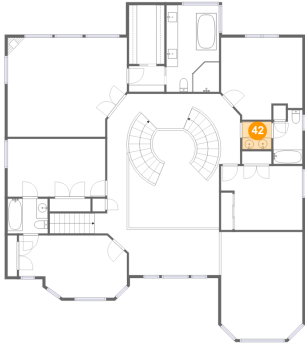

Dimensions: 5'1" x 4'10"  
Area: 25 sq. ft  
Counted as Living Area:  
Yes

Heated: Yes  
Finished: Yes  
Enclosed: Yes  
Contiguous:  
Yes  
Permitted: Yes  
Wet Space: Yes  
Addition: No  
Conversion: No

### 43 Floor 3 - Bath

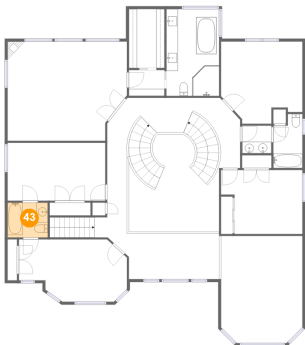

Dimensions: 7'0" x 6'1"  
Area: 42 sq. ft  
Counted as Living Area:  
Yes

Heated: Yes  
Finished: Yes  
Enclosed: Yes  
Contiguous:  
Yes  
Permitted: Yes  
Wet Space: Yes  
Addition: No  
Conversion: No

### 44 Floor 3 - Bedroom

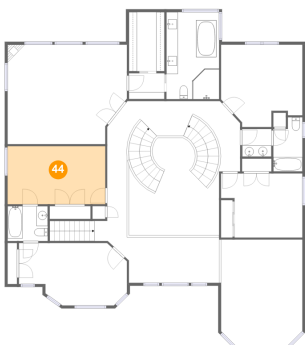

Dimensions: 17'0" x 10'1"  
Area: 171 sq. ft  
Counted as Living Area:  
Yes

Heated: Yes  
Finished: Yes  
Enclosed: Yes  
Contiguous:  
Yes  
Permitted: Yes  
Wet Space: No  
Addition: No  
Conversion: No

## 2 Waterford Ln,Whitchurch-Stouffville,Ontario,Canada

### 45 Floor 3 - Hall

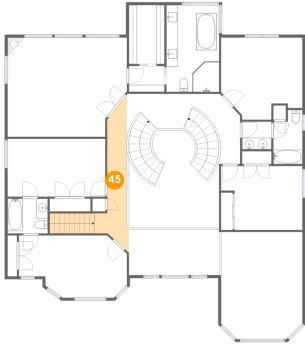

Dimensions: 6'0" x 27'0"  
Area: 117 sq. ft  
Counted as Living Area:  
Yes

Heated: Yes  
Finished: Yes  
Enclosed: Yes  
Contiguous:  
Yes  
Permitted: Yes  
Wet Space: No  
Addition: No  
Conversion: No

### 46 Floor 3 - Bedroom

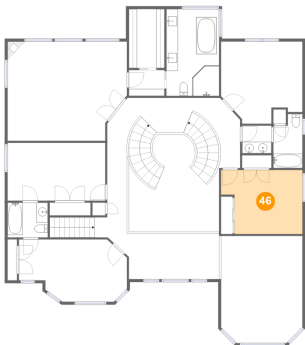

Dimensions: 14'1" x 11'1"  
Area: 141 sq. ft  
Counted as Living Area:  
Yes

Heated: Yes  
Finished: Yes  
Enclosed: Yes  
Contiguous:  
Yes  
Permitted: Yes  
Wet Space: No  
Addition: No  
Conversion: No