

723 Chestnut Ridge Church Road (1359.5 sf HLA)

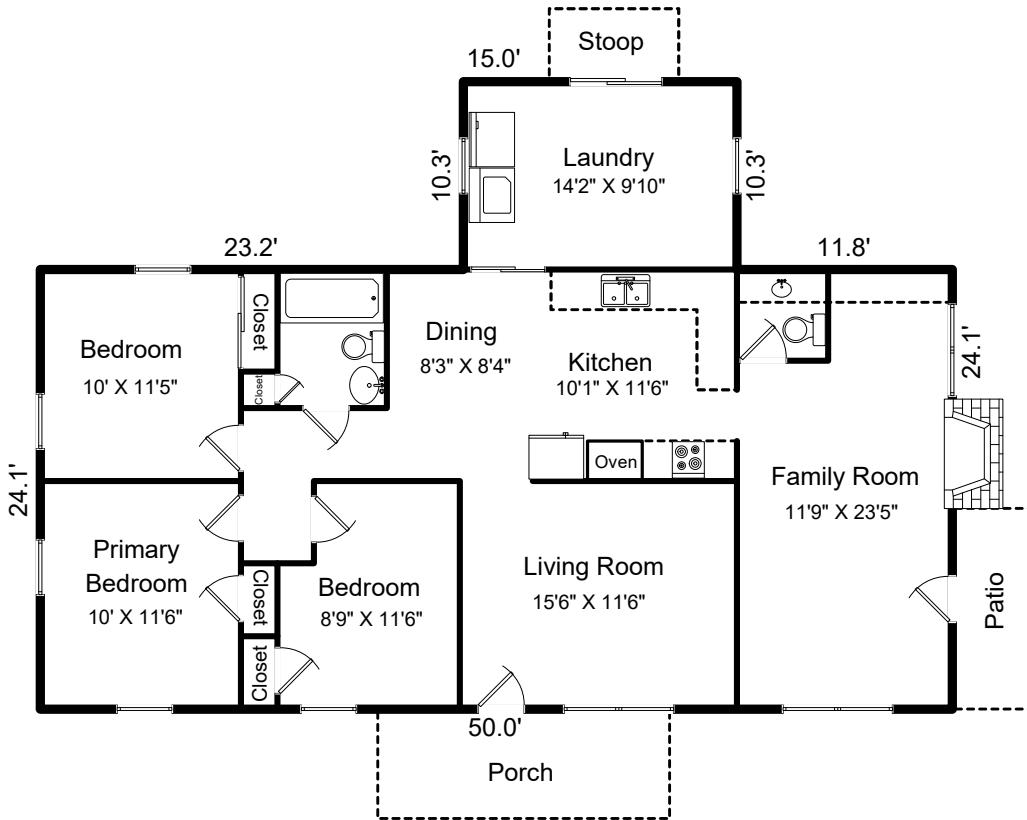

Heated Living Area  
1359.5sf

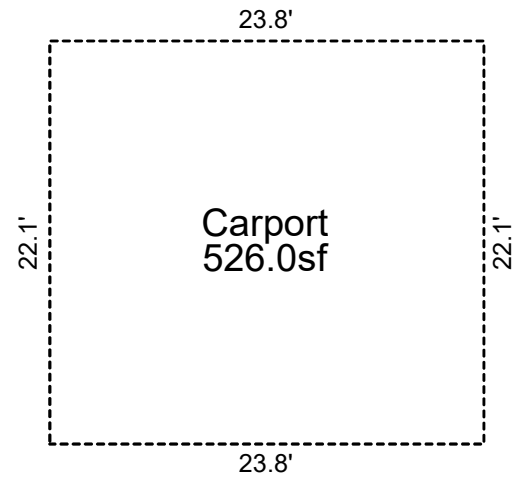

**SKETCH/AREA TABLE ADDENDUM**

**SUBJECT INFO**

File No.:	Parcel No.:		
Property Address:			
City:	County:	State:	ZipCode:
Owner:			
Client:	Client Address:		
Appraiser Name:	Inspection Date:		

**SKETCH**

Heated Living Area (GLA1)  
15.00 x 10.30 = 154.50  
50.00 x 24.10 = 1205.00  
Stoop (P/P)  
7.10 x 4.00 = 28.40  
Patio (P/P)  
11.00 x 4.50 = 49.50  
Porch (P/P)  
16.00 x 6.00 = 96.00  
Carport (GAR)  
23.80 x 22.10 = 525.98