

Building Sketch

Borrower/Client				
Property Address 126 Division Ave				
City Salisbury	County	State NC	Zip Code 28144	
Lender				

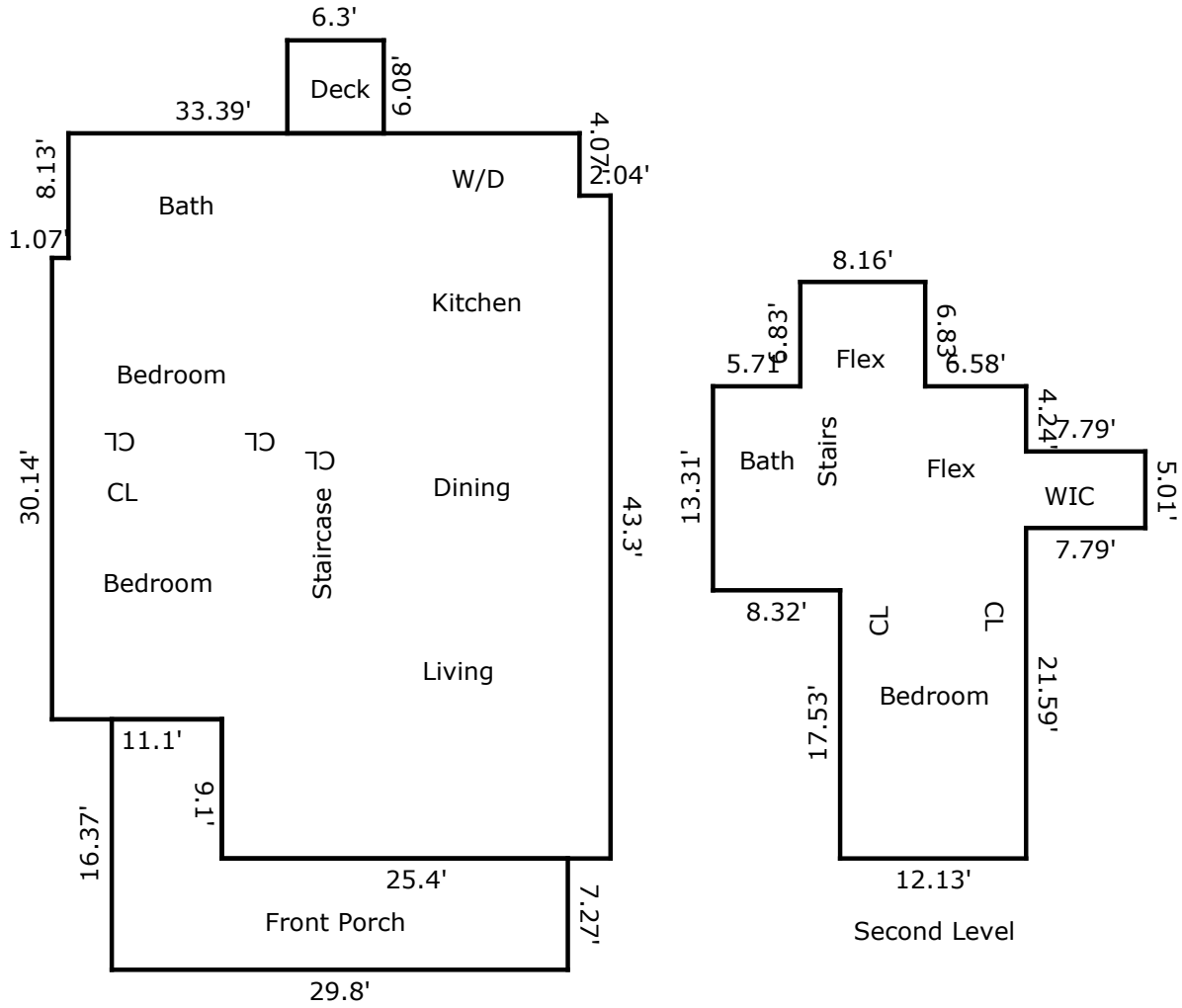

TOTAL Sketch by a la mode

Area Calculations Summary

Living Area	Calculation Details	
Main Living Area	1610.99 Sq ft	$25.4 \times 9.1 = 231.14$ $36.5 \times 30.14 = 1100.11$ $4.06 \times 2.04 = 8.28$ $8.13 \times 33.39 = 271.46$
Second Level	579.59 Sq ft	$8.16 \times 6.83 = 55.73$ $5.01 \times 7.79 = 39.03$ $12.13 \times 17.53 = 212.64$ $13.31 \times 20.45 = 272.19$
Total Living Area (Rounded):		2191 Sq ft
Non-living Area		
Deck	38.3 Sq ft	$6.3 \times 6.08 = 38.3$
Porch	282.17 Sq ft	$7.2 \times 9.1 = 65.52$ $29.8 \times 7.27 = 216.65$