

## Sketch

Case Number: 20240910-1  
 Address: 209 Democracy Place  
 City / State: Apex / NC  
 Borrower:  
 Lender or Client: Eric Andrews  
 Prepared By: Laura Fuelleman

File Number: 202409  
 Zip / County: 27523 /  
 Address:  
 Prepared By A...

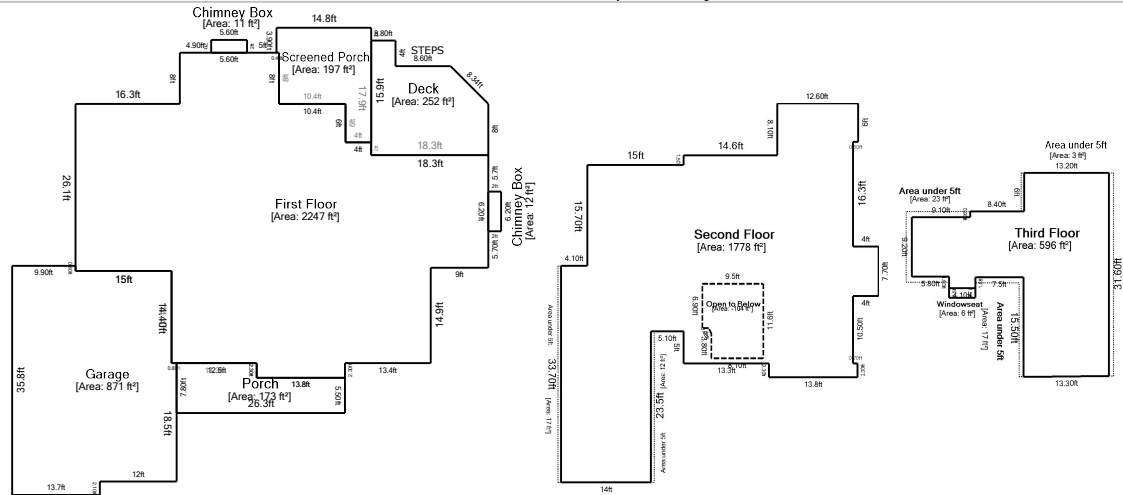

Living Area	Nonliving Area	
First Floor	2247.49 ft <sup>2</sup>	Garage 870.70 ft <sup>2</sup>
Second Floor	1777.60 ft <sup>2</sup>	Chimney Box 11.20 ft <sup>2</sup>
Open to Below	-103.80 ft <sup>2</sup>	Chimney Box 12.40 ft <sup>2</sup>
Third Floor	596.39 ft <sup>2</sup>	Deck 252.16 ft <sup>2</sup>
		Screened Porch 196.92 ft <sup>2</sup>
		Porch 173.40 ft <sup>2</sup>
		Area under 5ft 16.85 ft <sup>2</sup>
		Area under 5ft 11.74 ft <sup>2</sup>
		Area under 5ft 22.12 ft <sup>2</sup>
		Area under 5ft 2.69 ft <sup>2</sup>
		Area under 5ft 22.63 ft <sup>2</sup>
		Area under 5ft 16.97 ft <sup>2</sup>
		Windowseat 6.15 ft <sup>2</sup>
<b>Total Living Area (rounded):</b>	<b>4518 ft<sup>2</sup></b>	<b>Total Non-Living Area (rounded): 1616 ft<sup>2</sup></b>

This document is designed to be a record of total finished square feet to aid the listing agent in gathering the square feet facts of the property. Measurements are obtained by physical observation of the property by a certified Home Measurement Specialist. The method of measuring the subject home is in accordance with the NC Residential Square Footage Guidelines and those approved by the American National Standards Institute, Inc (ANSI), which are recognized by the North Carolina Real Estate Commission as comparable standards. Within every measurement project, some degree of art of opinion may be applied as well as rounding as set forth in the standards. Final finished square footage will be rounded to the nearest whole number with the goal of being within a 5% margin of error. Information deemed reliable, but not guaranteed.