

Building Sketch

Borrower/Client			
Property Address			
City	County	State	Zip Code
Lender			

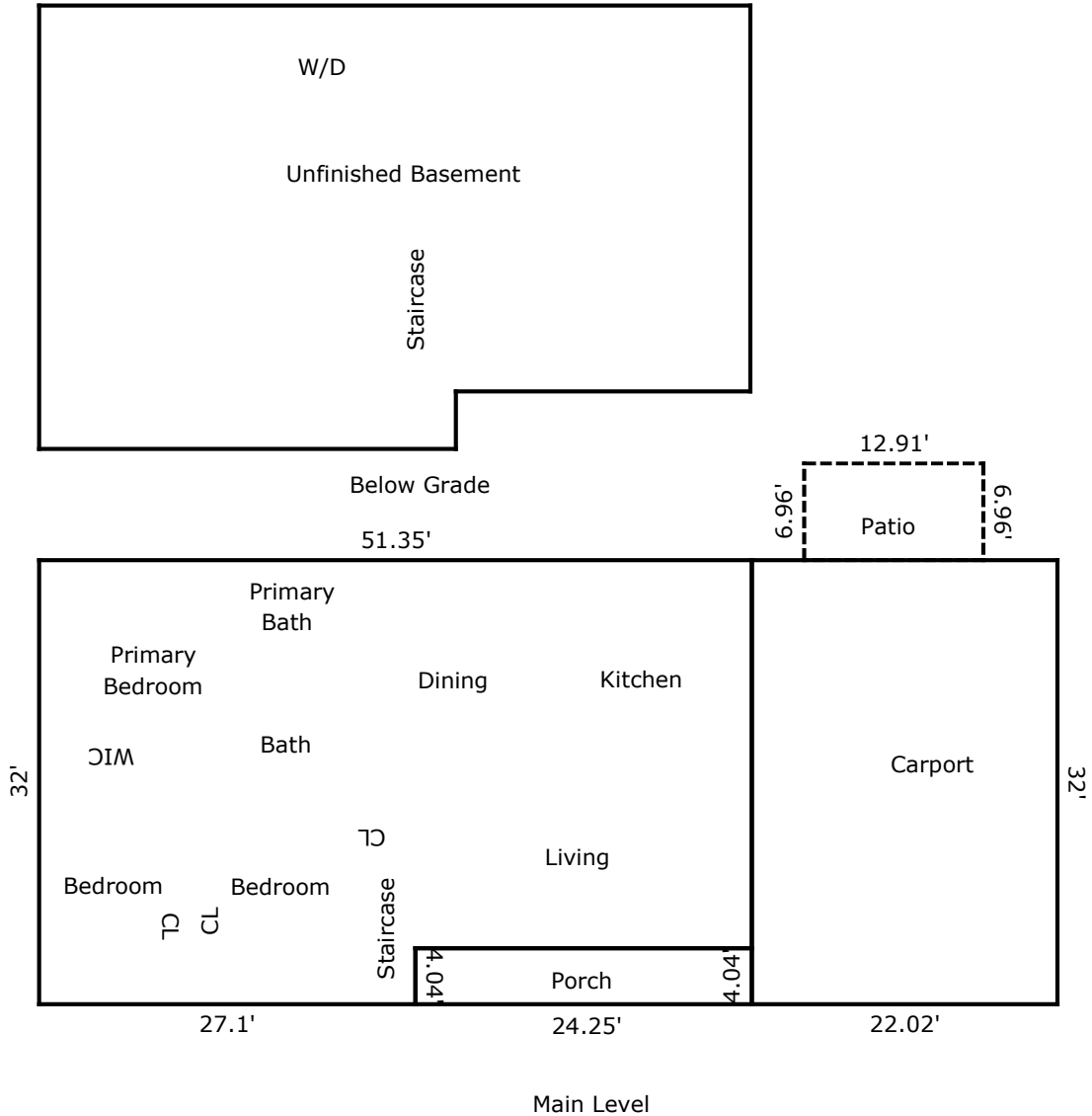

TOTAL Sketch by a la mode

Area Calculations Summary

Living Area	
Main Level	1545.23 Sq ft
Total Living Area (Rounded):	1545 Sq ft
Non-living Area	
Porch	97.97 Sq ft
Patio	89.85 Sq ft
Carport	704.64 Sq ft
Below Grade	1549.68 Sq ft