

G. ZARTMAN  
 4. VAN AVAILABILITY APPROVED  
 C. FERGUSON CHECKED  
 C. FERGUSON DRAWN  
 S. P. DESIGN  
 LANDSCAPE  
 2019.03.29 11:21 AM  
 LEI ENGINEERING & SURVEYING OF OREGON

PACIFIC HIGHWAY (99E)  
ROW = 80'

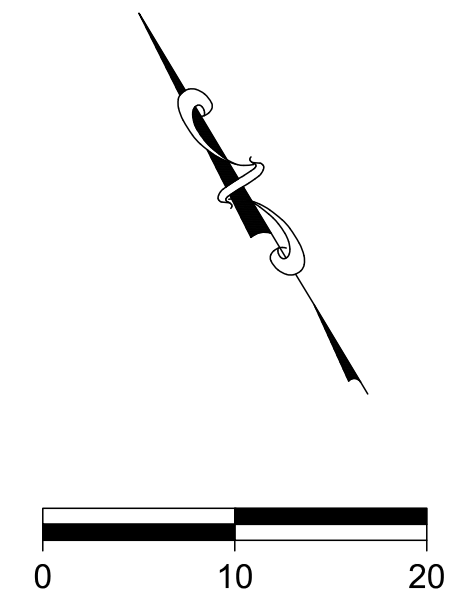
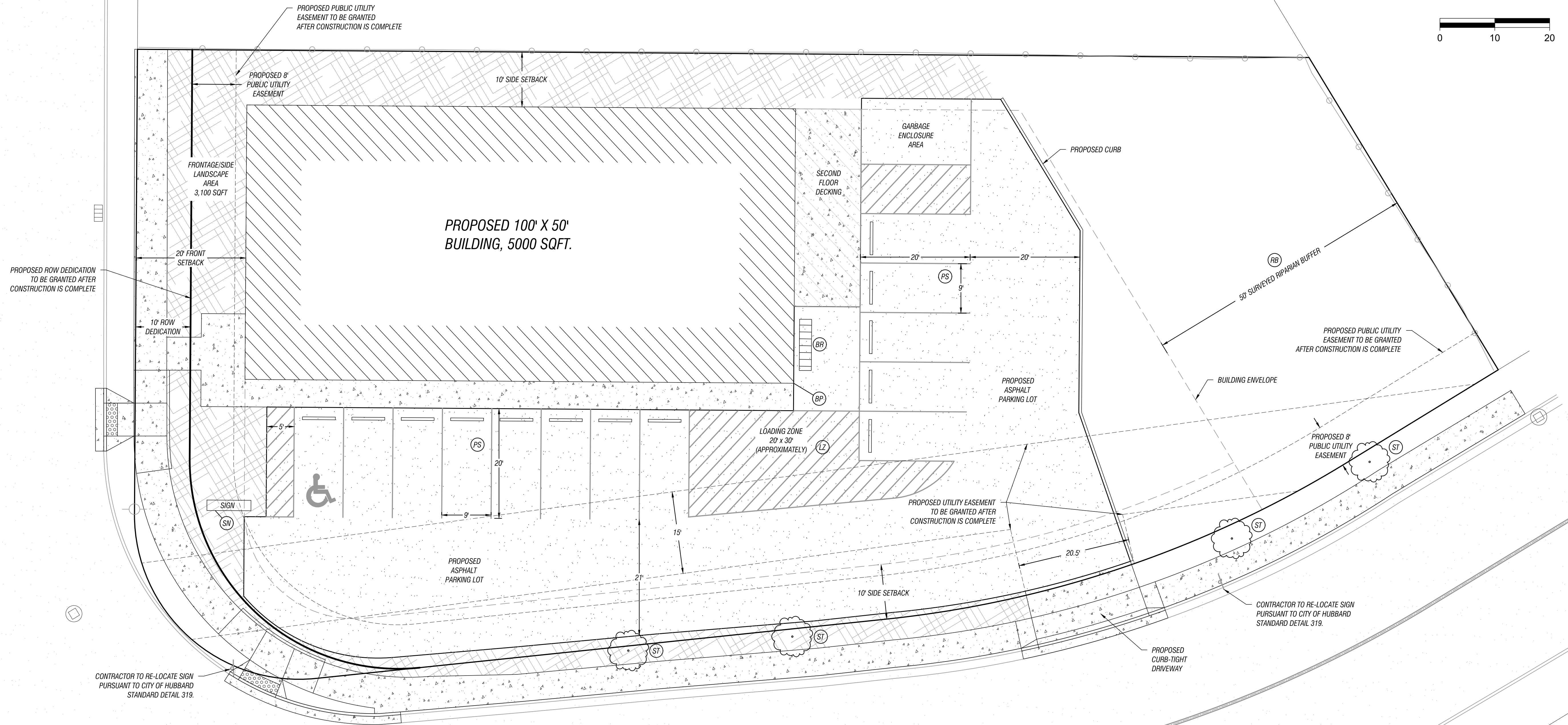

- CONSTRUCTION NOTES:**
- (SW) PROPOSED SIGN LOCATION, THE SIZE, LOCATION, AND CITY APPROVAL IS TO BE PROVIDED BY OTHERS.
  - (ST) PROPOSED STREET TREES SHALL CONFORM TO CITY STANDARDS FOR SIZE, LOCATION, QUANTITY, AND SPECIES. TREES ARE SHOWN GRAPHICALLY, AS THE LANDSCAPE PLAN SHALL BE PROVIDED BY OTHERS.
  - (RB) CONTRACTOR SHALL MAINTAIN A 50' RIPARIAN NO-TOUCH BUFFER MEASURED FROM TOP OF BANK, AS SHOWN.
  - (PS) PROPOSED PARKING STALLS SHALL BE 9' X 20' AND FINISHED WITH A WHEEL STOP, AS SHOWN, PURSUANT TO DETAIL ON SHEET 10. STALLS SHALL BE MARKED WITH 4" WHITE LINES AND SHALL CONFORM TO ODOT STANDARD DRAWING TMS00 SHOWN ON SHEET 12.
  - (LZ) PROPOSED LOADING ZONE SHALL BE STRIPED, AS SHOWN, WITH 4" WHITE LINES AND SHALL CONFORM TO ODOT STANDARD DRAWING TMS00 SHOWN ON SHEET 12.
  - (BR) CONTRACTOR SHALL INSTALL A SINGLE SIDED GRID BIKE RACK, AS SHOWN, OR EQUIVALENT, PURSUANT TO MANUFACTURERS SPECIFICATIONS. REFERENCE PRODUCT INFORMATION ON SHEET 12.
  - (BP) CONTRACTOR SHALL HANG BICYCLE PARKING SIGN ON CORNER OF BUILDING, AS SHOWN.

REGISTERED PROFESSIONAL ENGINEER  
 55022  
 GREG J. ZARTMAN  
 EXPIRES: 6-30-2020  
 REVISION BY DATE CITY ENG. COMMENTS  
 1 9-27-19

2335 INDUSTRIAL AVE.  
 PREPARED FOR:

2564 19TH ST SE  
 Salem, Oregon 97302  
 (503) 399-3828  
 www.leiengineering.com

**LEI** ENGINEERING & SURVEYING  
 OF OREGON

SCALE	1" = 10'
PROJECT NO.	14-62
TOTAL SHEETS	12
PROPOSED SITE PLAN	08