

#121-3333 Dewdney Trunk Rd

Port Moody BC V3H 2E4

Lower Level Area: 71 SQ.FT.
Main Level Area: 620 SQ.FT.
Upper Level Area: 590 SQ.FT.
Total Area 1,281 SQ.FT.

3



BEDROOMS

3



BATHROOMS

1,281



TOTAL SQ.FT.

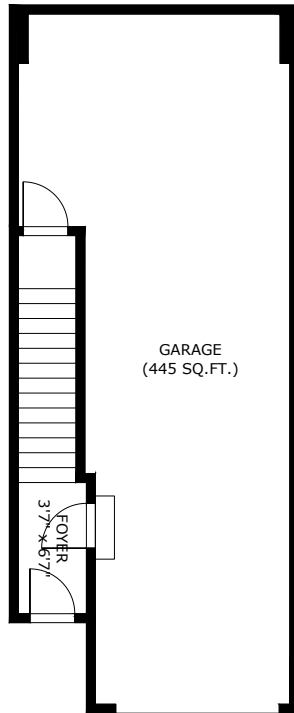

Lower Level Area:
Ceiling Height: 8'7"

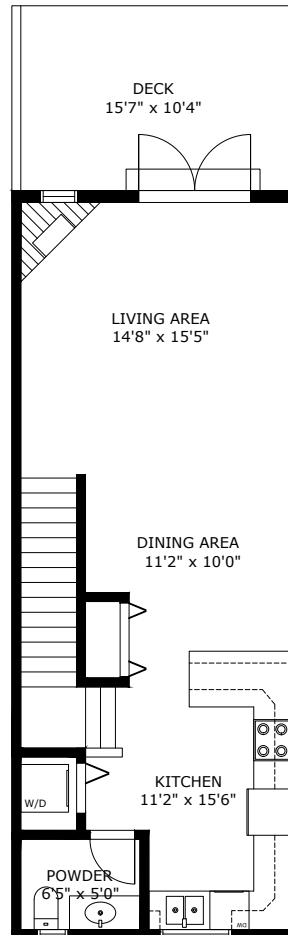

Main Level Area:
Ceiling Height: 9'0"

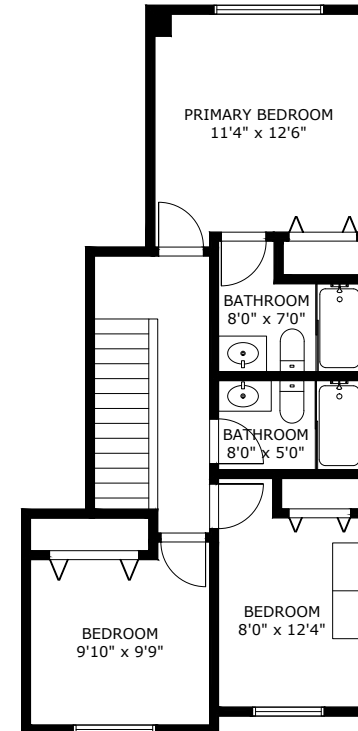

Upper Level Area:
Ceiling Height: 8'0"

#121-3333 Dewdney Trunk Rd, Port Moody, BC V3H 2E4

Measurements are approximate and may not be to scale. Gross measurements provided by agent.
The floor plan illustration is not suitable for construction/architectural purposes.
This communication is not intended to cause or induce breach of an existing agency agreement

3D IMMERSIVE
Tours Photos Floor Plans

Professionally measured by 3D Immersive Marketing Ltd.

Lead Floor Planner: *Sara Alexander*
Quality Assurance: *Dianne Graham*