

# Building Sketch

Borrower/Client				
Property Address 1318 Poppy Way				
City	Stallings	County	State NC	Zip Code 28104
Lender				

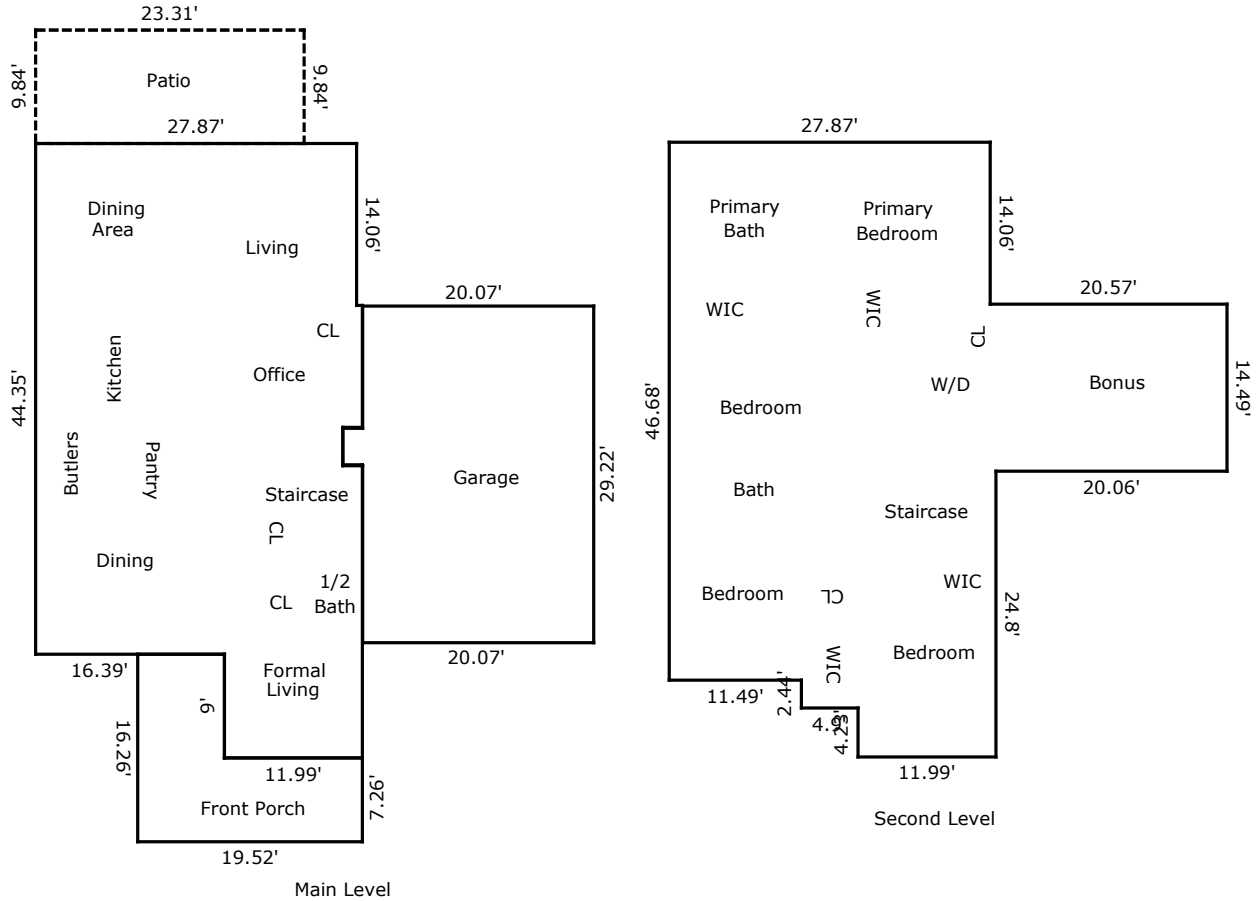

TOTAL Sketch by a la mode

### Area Calculations Summary

<b>Living Area</b>	
Main Level	1353.82 Sq ft
Second Level	1700.21 Sq ft
<b>Total Living Area (Rounded):</b>	<b>3054 Sq ft</b>
<b>Non-living Area</b>	
Porch	209.49 Sq ft
Garage	592.02 Sq ft
Patio	229.37 Sq ft