

1 S Pine Cir, Belleair, FL, United States

Gross Living Area: 2776 sq. ft

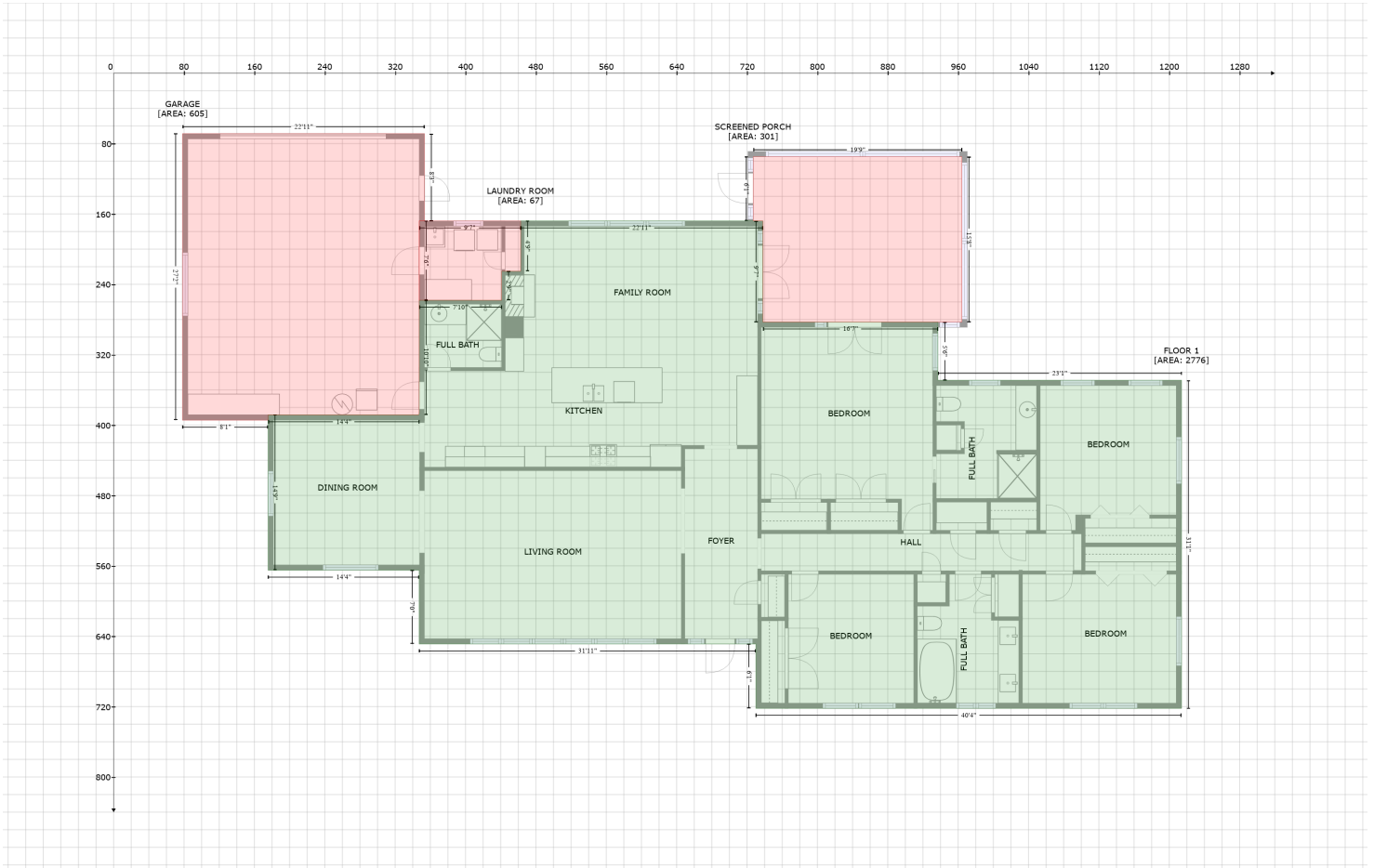

Space	Area (sq. ft)	Calculation
FLOOR 1 (Living area)	2776	$-(738.1 + 738.1) * (167.9 - 282.8) + (738.1 + 937) * (282.8 - 282.8) + (937 + 937) * (282.8 - 349) + (937 + 1214) * (349 - 349) + (1214 + 1214) * (349 - 722.1) + (1214 + 730) * (722.1 - 722.1) + (730 + 730) * (722.1 - 648.8) + (730 + 347.3) * (648.8 - 648.8) + (347.3 + 347.3) * (648.8 - 565) + (347.3 + 175.6) * (565 - 565) + (175.6 + 175.6) * (565 - 388.4) + (175.6 + 347.3) * (388.4 - 388.4) + (347.3 + 347.3) * (388.4 - 258.2) + (347.3 + 441) * (258.2 - 258.2) + (441 + 441) * (258.2 - 225.1) + (441 + 462.7) * (225.1 - 225.1) + (462.7 + 462.7) * (225.1 - 167.9) + (462.7 + 738.1) * (167.9 - 167.9) * 0.5 * 0.00694$
LAUNDRY ROOM (Non-living area)	67	$-(462.7 + 462.7) * (167.9 - 225.1) + (462.7 + 441) * (225.1 - 225.1) + (441 + 441) * (225.1 - 258.2) + (441 + 347.3) * (258.2 - 258.2) + (347.3 + 347.3) * (258.2 - 167.9) + (347.3 + 462.7) * (167.9 - 167.9) * 0.5 * 0.00694$
SCREENED PORCH (Non-living area)	301	$-(964.4 + 964.4) * (94.9 - 282.8) + (964.4 + 738.1) * (282.8 - 282.8) + (738.1 + 738.1) * (282.8 - 167.9) + (738.1 + 727.1) * (167.9 - 167.9) + (727.1 + 727.1) * (167.9 - 94.9) + (727.1 + 964.4) * (94.9 - 94.9) * 0.5 * 0.00694$
GARAGE (Non-living area)	605	$-(353.3 + 353.3) * (68.7 - 167.9) + (353.3 + 347.3) * (167.9 - 167.9) + (347.3 + 347.3) * (167.9 - 386.7) + (347.3 + 346.8) * (386.7 - 386.7) + (346.8 + 346.8) * (386.7 - 388.4) + (346.8 + 175.6) * (388.4 - 388.4) + (175.6 + 175.6) * (388.4 - 394.4) + (175.6 + 78.3) * (394.4 - 394.4) + (78.3 + 78.3) * (394.4 - 68.7) + (78.3 + 353.3) * (68.7 - 68.7) * 0.5 * 0.00694$