

TOTAL: 4408 sq. ft

BELOW GROUND: 744 sq. ft, FLOOR 2: 2777 sq. ft, FLOOR 3: 887 sq. ft
EXCLUDED AREAS: STORAGE: 396 sq. ft, ROOM: 403 sq. ft, ELECTRICAL ROOM: 105 sq. ft,
LAUNDRY: 75 sq. ft, UNDEFINED: 53 sq. ft, HALL: 178 sq. ft,
RECREATION ROOM: 895 sq. ft, GARAGE: 903 sq. ft



TOTAL: 4408 sq. ft

BELOW GROUND: 744 sq. ft, FLOOR 2: 2777 sq. ft, FLOOR 3: 887 sq. ft
 EXCLUDED AREAS: STORAGE: 396 sq. ft, ROOM: 403 sq. ft, ELECTRICAL ROOM: 105 sq. ft,
 LAUNDRY: 75 sq. ft, UNDEFINED: 53 sq. ft, HALL: 178 sq. ft,
 RECREATION ROOM: 895 sq. ft, GARAGE: 903 sq. ft

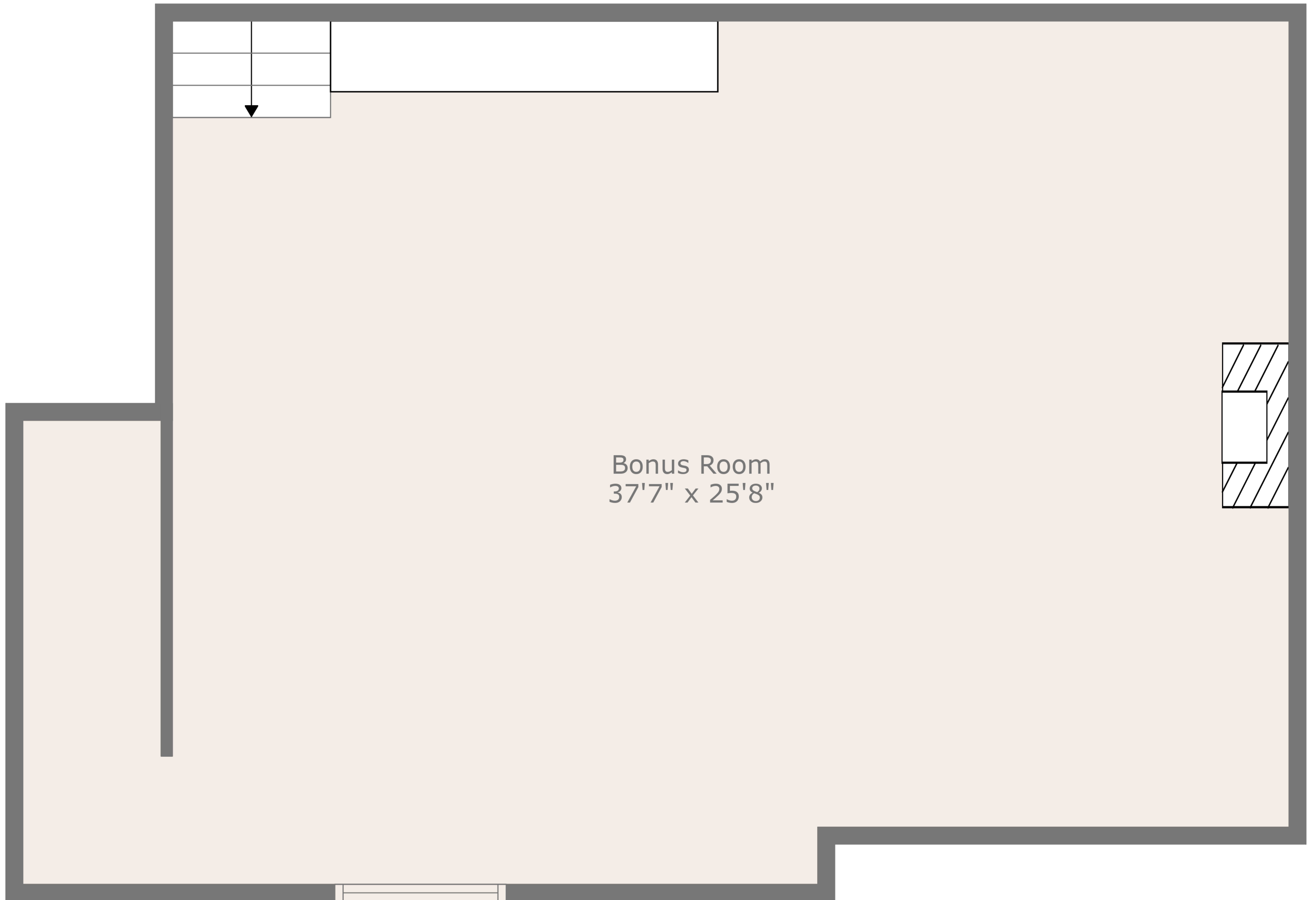

Bonus Room
37'7" x 25'8"

TOTAL: 4408 sq. ft

BELOW GROUND: 744 sq. ft, FLOOR 2: 2777 sq. ft, FLOOR 3: 887 sq. ft
EXCLUDED AREAS: STORAGE: 396 sq. ft, ROOM: 403 sq. ft, ELECTRICAL ROOM: 105 sq. ft,
LAUNDRY: 75 sq. ft, UNDEFINED: 53 sq. ft, HALL: 178 sq. ft,
RECREATION ROOM: 895 sq. ft, GARAGE: 903 sq. ft



Floor 2

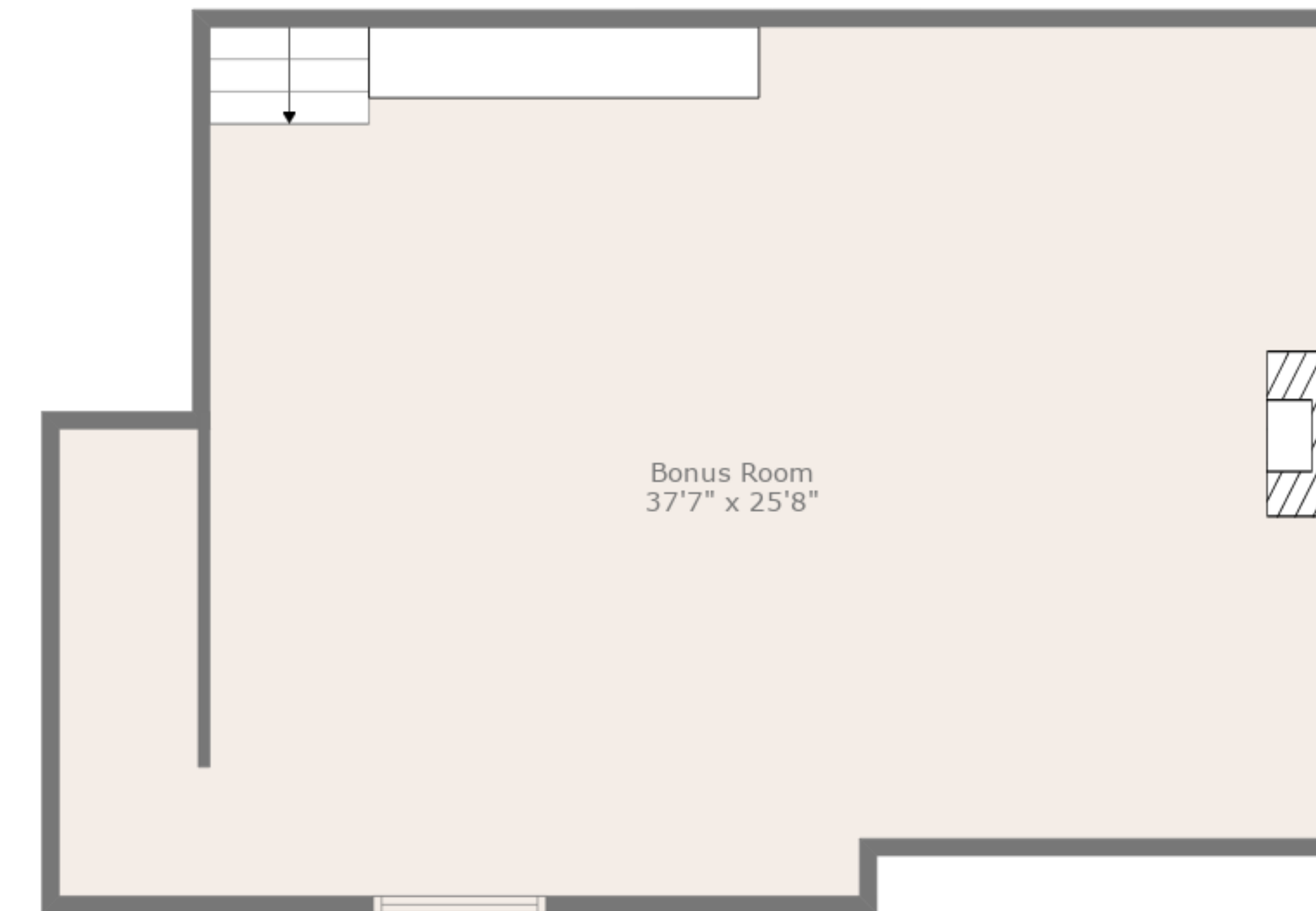

Floor 3



Floor 1

TOTAL: 4408 sq. ft

BELOW GROUND: 744 sq. ft, FLOOR 2: 2777 sq. ft, FLOOR 3: 887 sq. ft

EXCLUDED AREAS: STORAGE: 396 sq. ft, ROOM: 403 sq. ft, ELECTRICAL ROOM: 105 sq. ft,

LAUNDRY: 75 sq. ft, UNDEFINED: 53 sq. ft, HALL: 178 sq. ft,

RECREATION ROOM: 895 sq. ft, GARAGE: 903 sq. ft