

Building Sketch

Borrower/Client				
Property Address 6321 E Lawyers Road				
City	Marchville	County	State NC	Zip Code 28103
Lender				

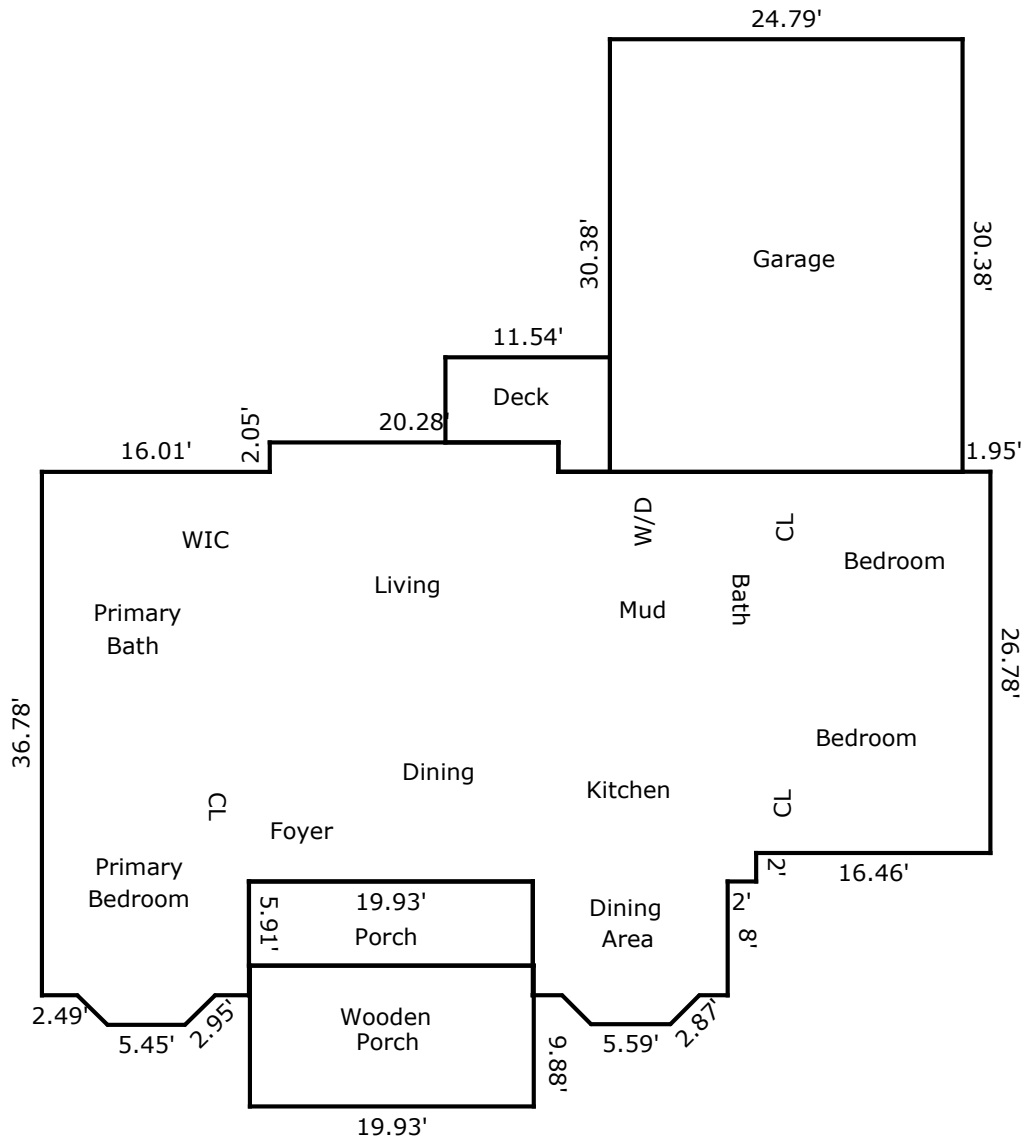

TOTAL Sketch by a la mode

Area Calculations Summary

Living Area	
Main Level	2183.49 Sq ft
Total Living Area (Rounded):	2183 Sq ft
Non-living Area	
Porch	196.91 Sq ft
Deck	76.62 Sq ft
Porch	117.79 Sq ft
Garage	753.12 Sq ft