

# Building Sketch

Borrower/Client				
Property Address 1001 N 6th Street				
City	Bessemer City	County	State NC	Zip Code 28016
Lender				

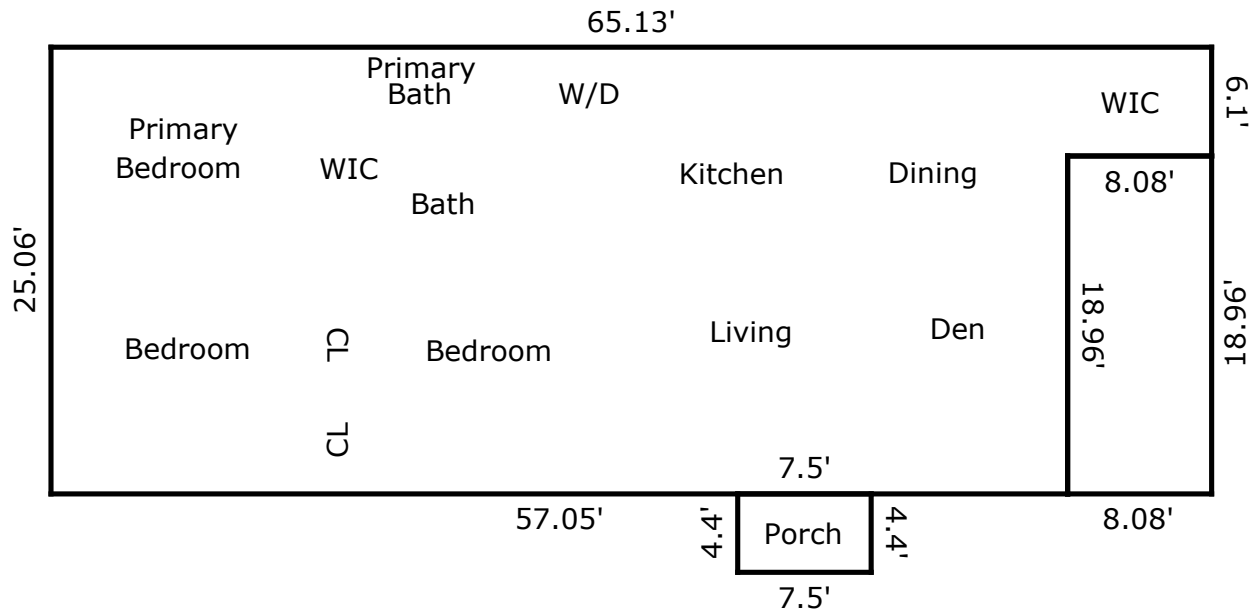

TOTAL Sketch by a la mode

### Area Calculations Summary

<b>Living Area</b>	
Main Level	1478.96 Sq ft
<b>Total Living Area (Rounded):</b>	<b>1479 Sq ft</b>
<b>Non-living Area</b>	
Porch	33 Sq ft
Porch	153.2 Sq ft