

2631 Westerham Way, Thompsons Station, Williamson County, Tennessee, United States, 37179

Gross Living Area: 2404 sq. ft

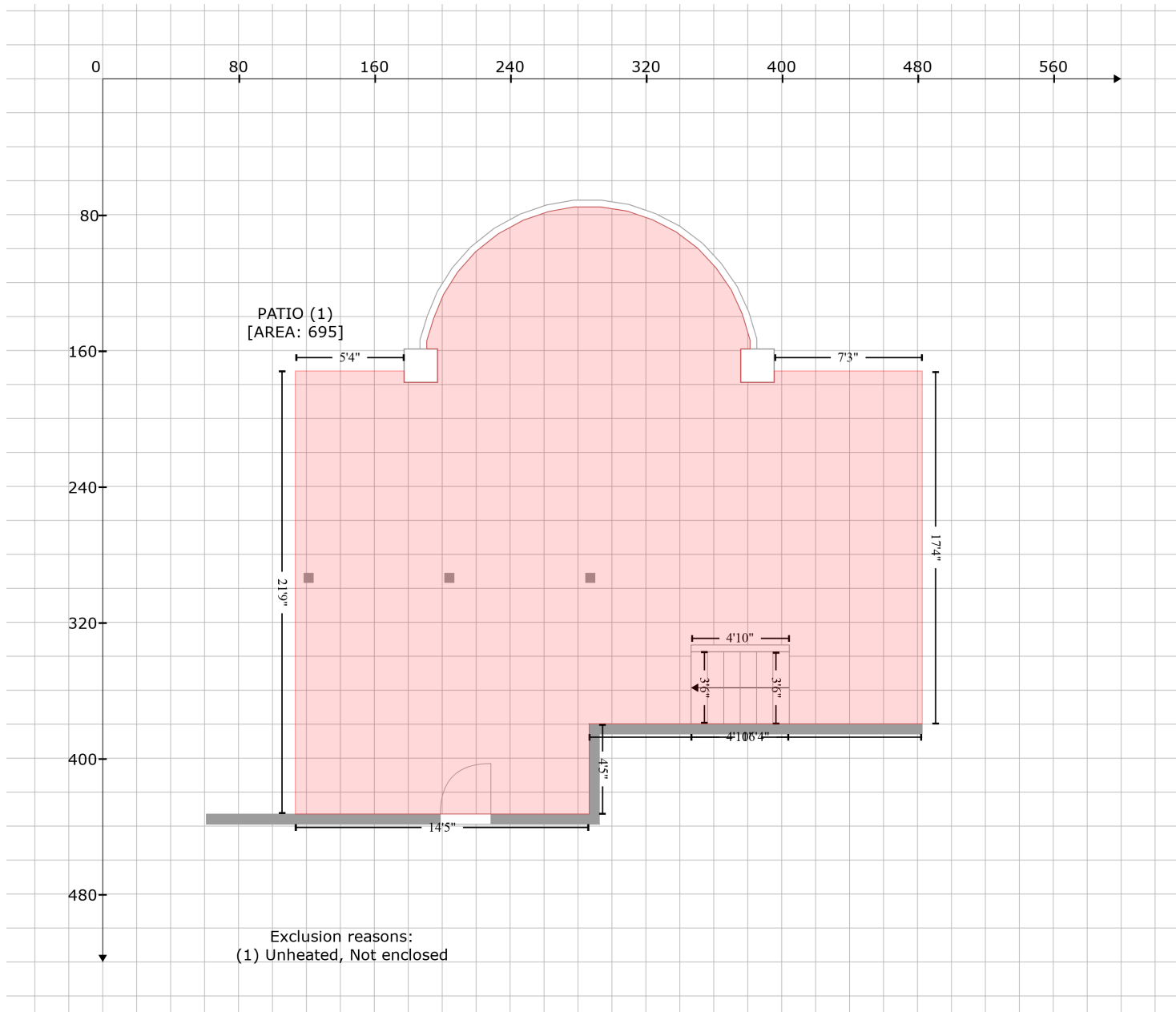

Space	Area (sq. ft)	Calculation <small>Coordinate Polygon Area Algorithm using inches</small>
PATIO (Non-living area)	695	$ \begin{aligned} & -((293.4 + 308.9) * (75.5 - 77.9) + (308.9 + 323.9) * (77.9 - 83) + (323.9 + 337.9) * (83 - 90.2) + \\ & (337.9 + 350.6) * (90.2 - 99.8) + (350.6 + 361.3) * (99.8 - 111.3) + (361.3 + 370.3) * (111.3 - \\ & 124.3) + (370.3 + 376.9) * (124.3 - 138.8) + (376.9 + 381.4) * (138.8 - 153.8) + (381.4 + 381.4) * \\ & (153.8 - 159.1) + (381.4 + 375.9) * (159.1 - 159.1) + (375.9 + 375.9) * (159.1 - 178.7) + (375.9 + \\ & 395.6) * (178.7 - 178.7) + (395.6 + 395.6) * (178.7 - 172.1) + (395.6 + 482.8) * (172.1 - 172.1) + \\ & (482.8 + 482.8) * (172.1 - 379.8) + (482.8 + 286.6) * (379.8 - 379.8) + (286.6 + 286.6) * (379.8 - \\ & 432.9) + (286.6 + 113.5) * (432.9 - 432.9) + (113.5 + 113.5) * (432.9 - 172.1) + (113.5 + 177.6) * \\ & (172.1 - 172.1) + (177.6 + 177.6) * (172.1 - 178.7) + (177.6 + 197.2) * (178.7 - 178.7) + (197.2 + \\ & 197.2) * (178.7 - 159.1) + (197.2 + 190.9) * (159.1 - 159.1) + (190.9 + 190.9) * (159.1 - 154.3) + \\ & (190.9 + 195) * (154.3 - 140.9) + (195 + 200.7) * (140.9 - 127.1) + (200.7 + 209.1) * (127.1 - \end{aligned} $

2631 Westerham Way, Thompsons Station, Williamson County, Tennessee, United States, 37179

Gross Living Area: 2404 sq. ft

Space	Area (sq. ft)	Calculation <small>Coordinate Polygon Area Algorithm using inches</small>
		$\frac{113.8 + (209.1 + 219.5) * (113.8 - 102) + (219.5 + 232.9) * (102 - 91.3) + (232.9 + 247.6) * (91.3 - 83.3) + (247.6 + 262.5) * (83.3 - 78.2) + (262.5 + 277.7) * (78.2 - 75.5) + (277.7 + 293.4) * (75.5 - 75.5)}{2} * 0.5 * 0.00694$

2631 Westerham Way, Thompsons Station, Williamson County, Tennessee, United States, 37179

Gross Living Area: 2404 sq. ft

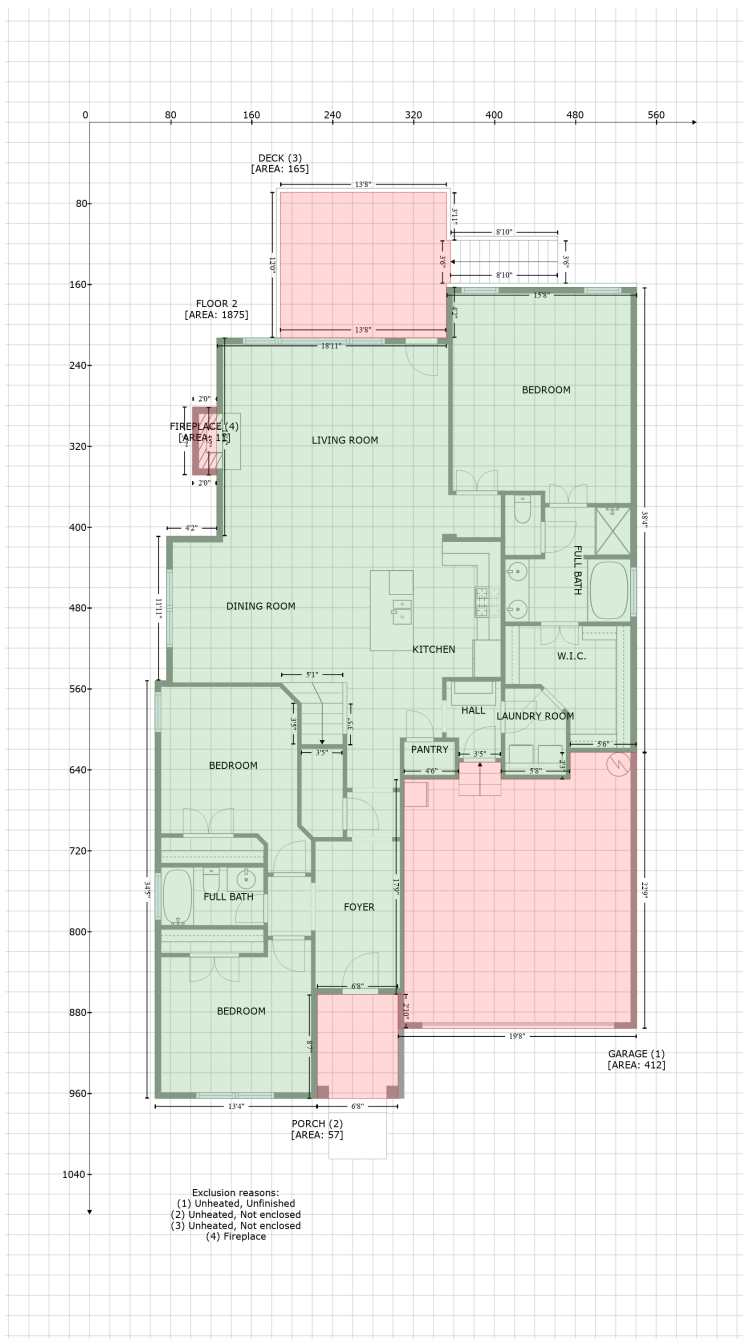

Space

Area (sq. ft)

Calculation Coordinate Polygon Area Algorithm using inches

FLOOR 2
(Living area)

1875

$$\begin{aligned}
 & -((540.8 + 540.8) * (163.2 - 623) + (540.8 + 475.1) * (623 - 623) + (475.1 + 475.1) * (623 - 649.6) \\
 & + (475.1 + 406.7) * (649.6 - 649.6) + (406.7 + 406.7) * (649.6 - 632.7) + (406.7 + 365.2) * (632.7 - \\
 & 632.7) + (365.2 + 365.2) * (632.7 - 649.6) + (365.2 + 310.9) * (649.6 - 649.6) + (310.9 + 310.9) * \\
 & (649.6 - 862.4) + (310.9 + 306.9) * (862.4 - 862.4) + (306.9 + 306.9) * (862.4 - 860.6) + (306.9 + \\
 & 304.9) * (860.6 - 862.4) + (304.9 + 225.1) * (862.4 - 862.4) + (225.1 + 225.1) * (862.4 - 965.4) + \\
 & (225.1 + 64.7) * (965.4 - 965.4) + (64.7 + 64.7) * (965.4 - 552.2) + (64.7 + 76.1) * (552.2 - 552.2) \\
 & + (76.1 + 76.1) * (552.2 - 409.3) + (76.1 + 125.7) * (409.3 - 409.3) + (125.7 + 125.7) * (409.3 -
 \end{aligned}$$

2631 Westerham Way, Thompsons Station, Williamson County, Tennessee, United States, 37179

Gross Living Area: 2404 sq. ft

Space	Area (sq. ft)	Calculation <small>Coordinate Polygon Area Algorithm using inches</small>
		$213.3 + (125.7 + 352.7) * (213.3 - 213.3) + (352.7 + 352.7) * (213.3 - 163.2) + (352.7 + 540.8) * (163.2 - 163.2) * 0.5 * 0.00694$
GARAGE (Non-living area)	412	$-((540.8 + 540.8) * (623 - 896.1) + (540.8 + 304.9) * (896.1 - 896.1) + (304.9 + 304.9) * (896.1 - 862.4) + (304.9 + 306.9) * (862.4 - 860.6) + (306.9 + 306.9) * (860.6 - 862.4) + (306.9 + 310.9) * (862.4 - 862.4) + (310.9 + 310.9) * (862.4 - 649.6) + (310.9 + 365.2) * (649.6 - 649.6) + (365.2 + 365.2) * (649.6 - 632.7) + (365.2 + 406.7) * (632.7 - 632.7) + (406.7 + 406.7) * (632.7 - 649.6) + (406.7 + 475.1) * (649.6 - 649.6) + (475.1 + 475.1) * (649.6 - 623) + (475.1 + 540.8) * (623 - 623)) * 0.5 * 0.00694$
PORCH (Non-living area)	57	$-((304.9 + 304.9) * (862.4 - 965.4) + (304.9 + 225.1) * (965.4 - 965.4) + (225.1 + 225.1) * (965.4 - 862.4) + (225.1 + 304.9) * (862.4 - 862.4)) * 0.5 * 0.00694$
DECK (Non-living area)	165	$-((352.7 + 352.7) * (69.3 - 116.7) + (352.7 + 356.7) * (116.7 - 116.7) + (356.7 + 356.7) * (116.7 - 159.2) + (356.7 + 352.7) * (159.2 - 159.2) + (352.7 + 352.7) * (159.2 - 213.3) + (352.7 + 188.6) * (213.3 - 213.3) + (188.6 + 188.6) * (213.3 - 69.3) + (188.6 + 352.7) * (69.3 - 69.3)) * 0.5 * 0.00694$
FIREPLACE (Non-living area)	11	$-((125.7 + 125.7) * (281.5 - 348.9) + (125.7 + 101.7) * (348.9 - 348.9) + (101.7 + 101.7) * (348.9 - 281.5) + (101.7 + 125.7) * (281.5 - 281.5)) * 0.5 * 0.00694$

2631 Westerham Way, Thompsons Station, Williamson County, Tennessee, United States, 37179

Gross Living Area: 2404 sq. ft

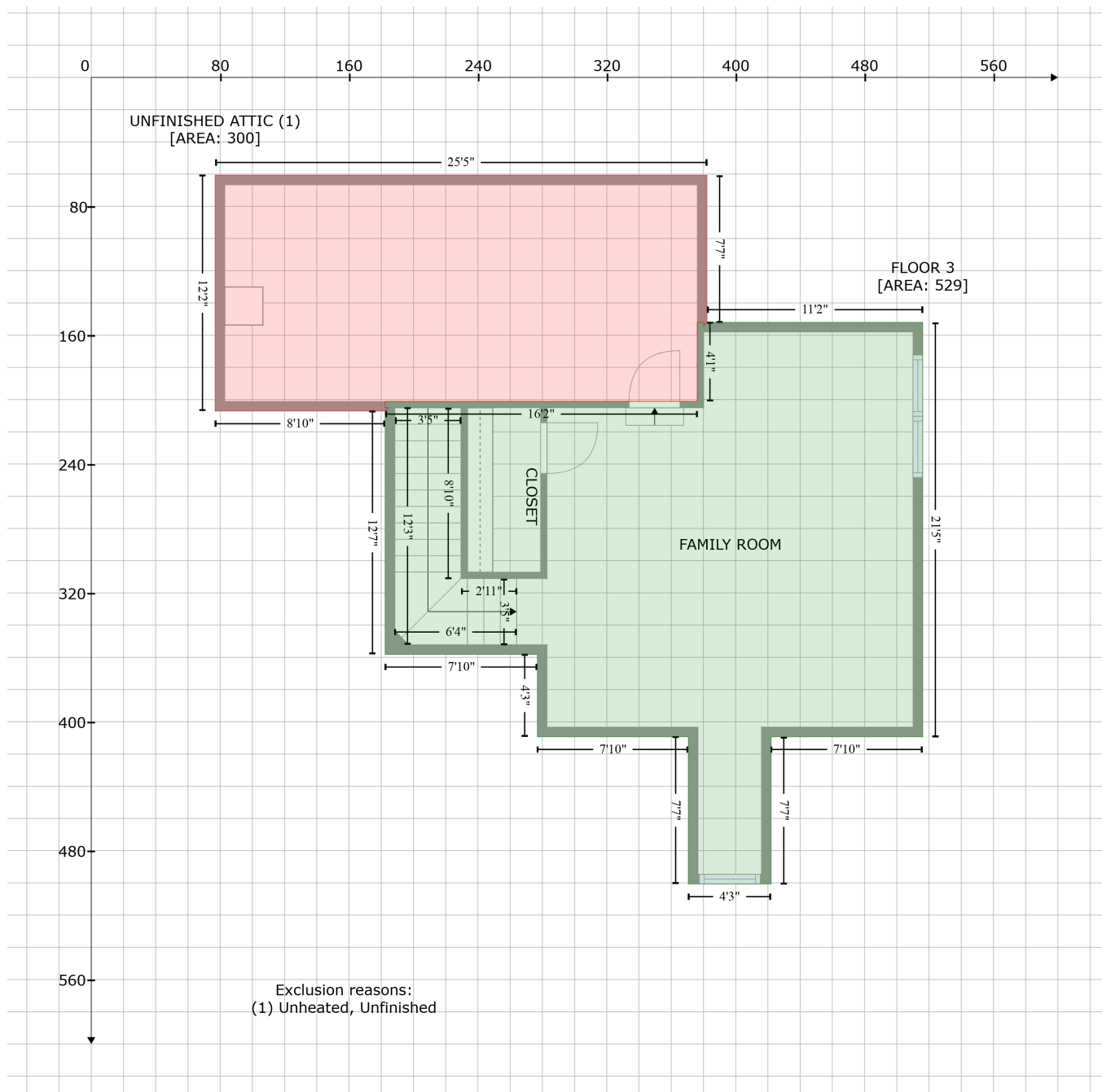

Space	Area (sq. ft)	Calculation <small>Coordinate Polygon Area Algorithm using inches</small>
FLOOR 3 (Living area)	529	$ \begin{aligned} & -((380.2 + 380.2) * (152 - 154.1) + (380.2 + 382.2) * (154.1 - 152) + (382.2 + 516.1) * (152 - 152) \\ & + (516.1 + 516.1) * (152 - 409.3) + (516.1 + 422) * (409.3 - 409.3) + (422 + 422) * (409.3 - 500.6) \\ & + (422 + 370.6) * (500.6 - 500.6) + (370.6 + 370.6) * (500.6 - 409.3) + (370.6 + 276.9) * (409.3 - 409.3) \\ & + (276.9 + 276.9) * (409.3 - 358.1) + (276.9 + 182.4) * (358.1 - 358.1) + (182.4 + 182.4) * (358.1 - 207.1) \\ & + (182.4 + 184.4) * (207.1 - 205.1) + (184.4 + 182.4) * (205.1 - 205.1) + (182.4 + 182.4) * (205.1 - 201.1) \\ & + (182.4 + 376.2) * (201.1 - 201.1) + (376.2 + 376.2) * (201.1 - 152) + (376.2 + 380.2) * (152 - 152)) * 0.5 * 0.00694 \end{aligned} $

2631 Westerham Way, Thompsons Station, Williamson County, Tennessee, United States, 37179

Gross Living Area: 2404 sq. ft

Space	Area (sq. ft)	Calculation <small>Coordinate Polygon Area Algorithm using inches</small>
UNFINISHED ATTIC (Non-living area)	300	$\begin{aligned} & -((382.2 + 382.2) * (60.7 - 152) + (382.2 + 380.2) * (152 - 154.1) + (380.2 + 380.2) * (154.1 - 152) \\ & + (380.2 + 376.2) * (152 - 152) + (376.2 + 376.2) * (152 - 201.1) + (376.2 + 182.4) * (201.1 - \\ & 201.1) + (182.4 + 182.4) * (201.1 - 205.1) + (182.4 + 184.4) * (205.1 - 205.1) + (184.4 + 182.4) * \\ & (205.1 - 207.1) + (182.4 + 76.9) * (207.1 - 207.1) + (76.9 + 76.9) * (207.1 - 60.7) + (76.9 + 382.2) \\ & * (60.7 - 60.7)) * 0.5 * 0.00694 \end{aligned}$