

# 7912 Calle Posada, La Costa Canyon Area, Carlsbad, San Diego County, California, United States, 92009

Gross Living Area: 1380 sq. ft

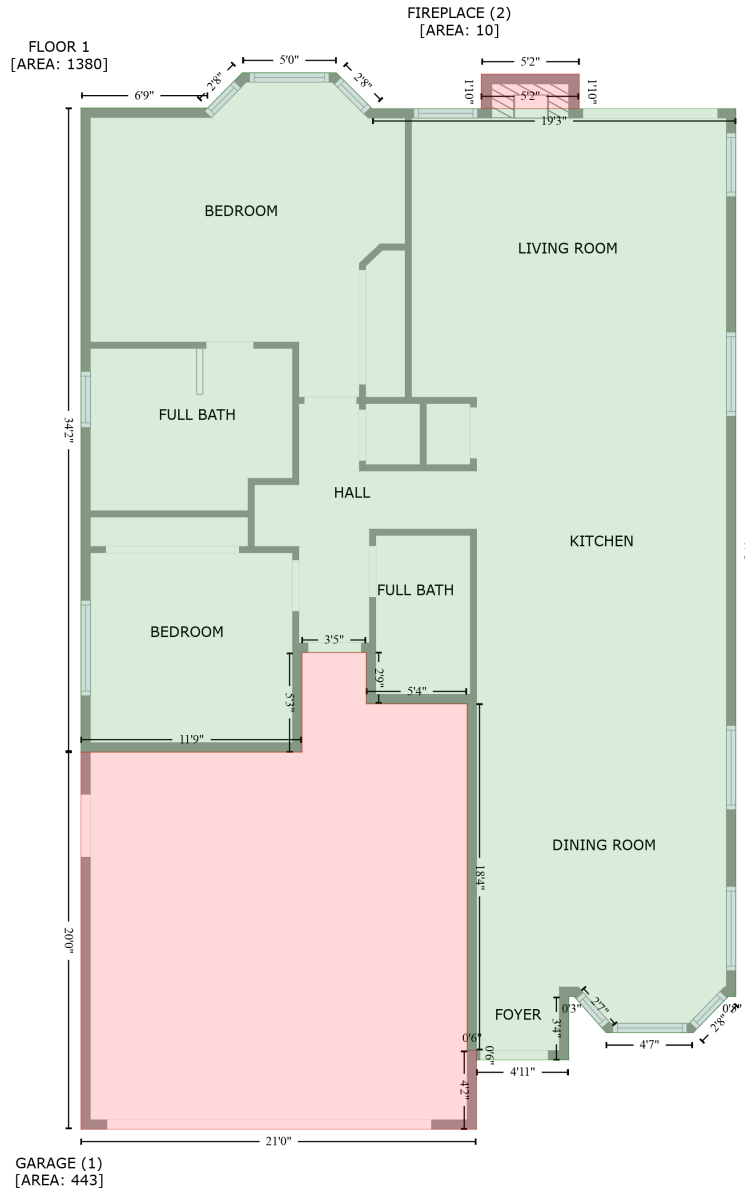

Space	Area (sq. ft)	Calculation
FLOOR 1 (Living area)	1380	Coordinate Polygon Area Algorithm using inches $-((163.9 + 186.7) * (57.8 - 80.6) + (186.7 + 418.2) * (80.6 - 80.6) + (418.2 + 418.2) * (80.6 - 645.2) + (418.2 + 413.4) * (645.2 - 645.2) + (413.4 + 391) * (645.2 - 668.2) + (391 + 335.7) * (668.2 - 668.2) + (335.7 + 315.4) * (668.2 - 645.2) + (315.4 + 311.9) * (645.2 - 645.2) + (311.9 + 311.9) * (645.2 - 685.5) + (311.9 + 253.2) * (685.5 - 685.5) + (253.2 + 253.2) * (685.5 - 679.5) + (253.2 + 247.2) * (679.5 - 679.5) + (247.2 + 247.2) * (679.5 - 459.1) + (247.2 + 183.1) * (459.1 - 459.1) + (183.1 + 183.1) * (459.1 - 426.4) + (183.1 + 142.1) * (426.4 - 426.4) + (142.1 + 142.1) * (426.4 - 489.8) + (142.1 + 1.5) * (489.8 - 489.8) + (1.5 + 1.5) * (489.8 - 80.2) + (1.5 + 82.1) * (80.2 - 80.2))$

# 7912 Calle Posada, La Costa Canyon Area, Carlsbad, San Diego County, California, United States, 92009

Gross Living Area: 1380 sq. ft

Space	Area (sq. ft)	Calculation <small>Coordinate Polygon Area Algorithm using inches</small>
GARAGE (Non-living area)	443	$-80.2 + (82.1 + 104.2) * (80.2 - 57.8) + (104.2 + 163.9) * (57.8 - 57.8) * 0.5 * 0.00694$ $-((183.1 + 183.1) * (426.4 - 459.1) + (183.1 + 247.2) * (459.1 - 459.1) + (247.2 + 247.2) * (459.1 - 679.5) + (247.2 + 253.2) * (679.5 - 679.5) + (253.2 + 253.2) * (679.5 - 729.6) + (253.2 + 1.5) * (729.6 - 729.6) + (1.5 + 1.5) * (729.6 - 489.8) + (1.5 + 142.1) * (489.8 - 489.8) + (142.1 + 142.1) * (489.8 - 426.4) + (142.1 + 183.1) * (426.4 - 426.4)) * 0.5 * 0.00694$
FIREPLACE (Non-living area)	10	$-((318.6 + 318.6) * (58.7 - 80.6) + (318.6 + 256.2) * (80.6 - 80.6) + (256.2 + 256.2) * (80.6 - 58.7) + (256.2 + 318.6) * (58.7 - 58.7)) * 0.5 * 0.00694$