

Building Sketch

Borrower/Client				
Property Address 110 N Grove Avenue				
City	Rockingham	County	State	NC
Zip Code		28379		
Lender				

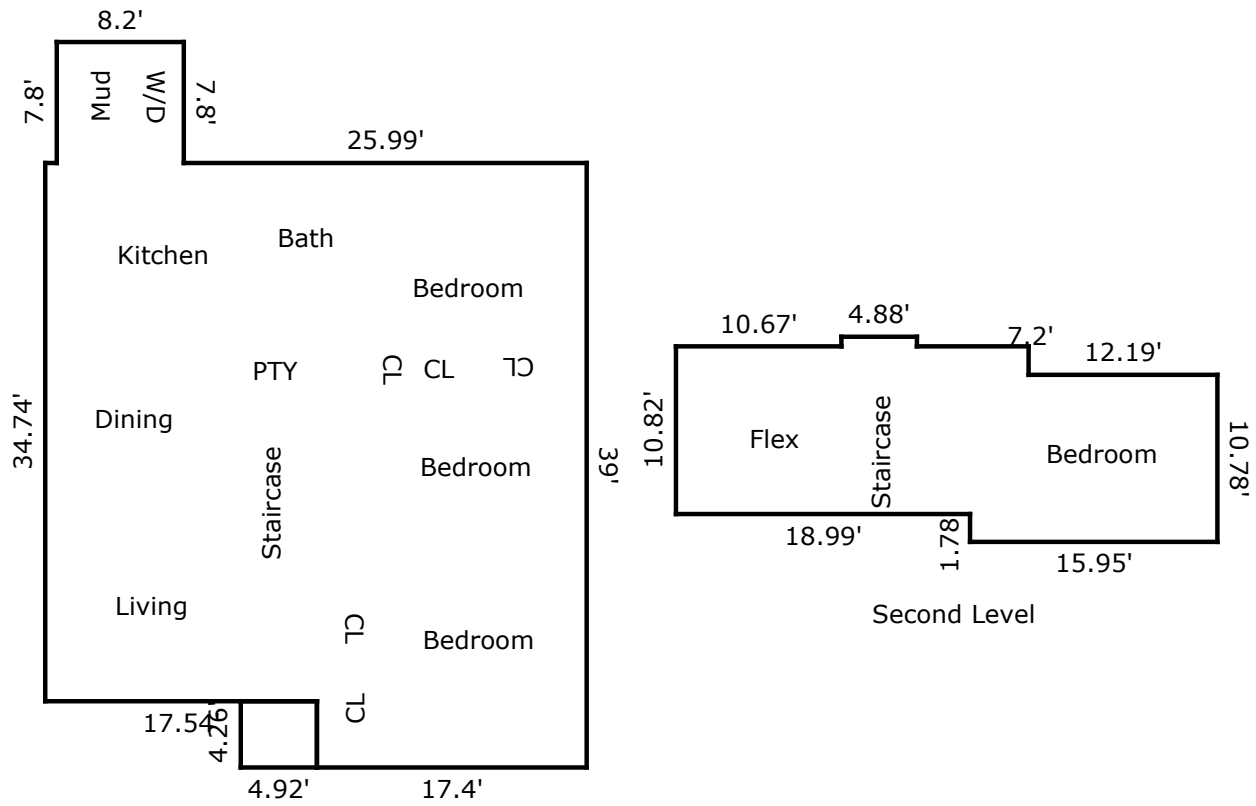

TOTAL Sketch by a la mode

Area Calculations Summary

Living Area	
Main Level	1351.9 Sq ft
Second Level	387.28 Sq ft
Total Living Area (Rounded):	1739 Sq ft
Non-living Area	
Porch	20.96 Sq ft