

Building Sketch

Borrower/Client			
Property Address 8468 Blades Trail			
City Denver	County	State NC	Zip Code 28037
Lender			

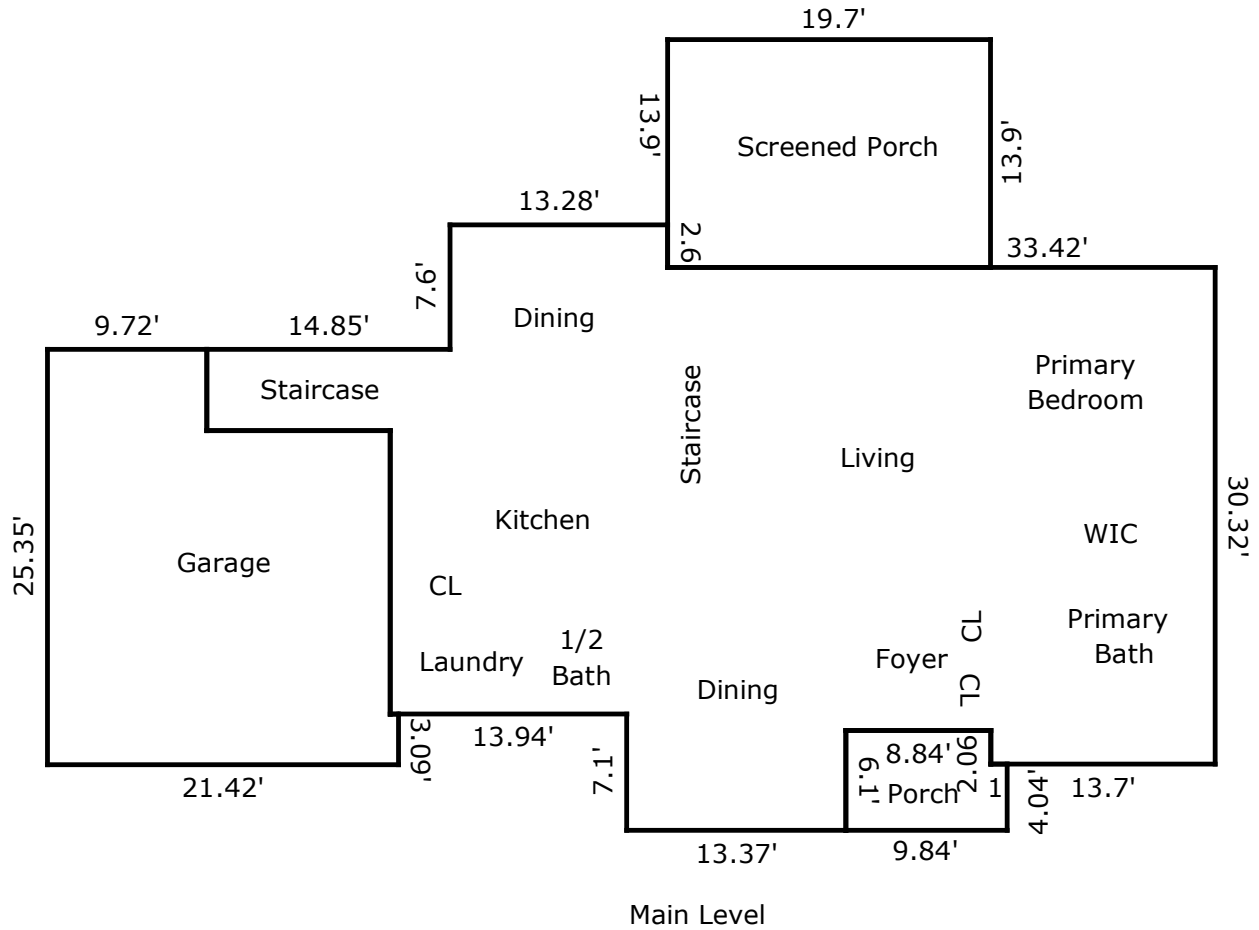

TOTAL Sketch by a la mode

Area Calculations Summary

Living Area	Calculation Details	
Main Living Area	1590.17 Sq ft	$13.37 \times 6.1 = 81.56$ $30.32 \times 13.7 = 415.38$ $28.26 \times 19.72 = 557.27$ $13.28 \times 7.6 = 100.93$ $4.97 \times 11.2 = 55.66$ $16.93 \times 22.26 = 376.88$ $1 \times 2.49 = 2.49$
Total Living Area (Rounded):	1590 Sq ft	
Non-living Area		
Screened Porch	273.82 Sq ft	$19.7 \times 13.9 = 273.82$
Porch	57.96 Sq ft	$6.1 \times 8.84 = 53.92$ $4.04 \times 1 = 4.04$
Garage	476.2 Sq ft	$3.09 \times 0.5 = 1.54$ $20.38 \times 11.2 = 228.26$ $25.35 \times 9.72 = 246.39$ $0.5 \times 25.35 \times 0 = 0.01$

Building Sketch

Borrower/Client			
Property Address 8468 Blades Trail			
City Denver	County	State NC	Zip Code 28037
Lender			

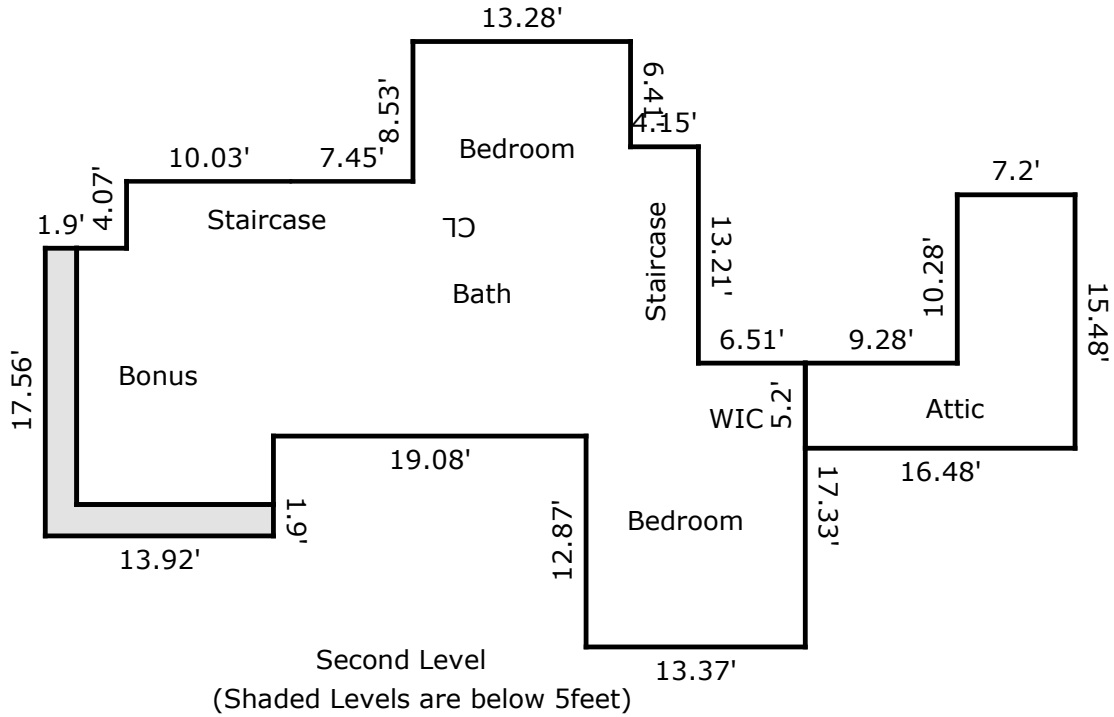

TOTAL Sketch by a la mode

Area Calculations Summary

Living Area	Area	Calculation Details
Second Level	951.29 Sq ft	$13.37 \times 12.87 = 172.07$ $12.02 \times 4.18 = 50.24$ $44.47 \times 4.46 = 198.34$ $37.96 \times 7.02 = 266.48$ $34.91 \times 4.07 = 142.08$ $17.43 \times 2.12 = 36.95$ $0.5 \times 6.41 \times 0 = 0$ $13.28 \times 6.41 = 85.12$ $0.5 \times 0 \times 7.45 = 0$ $10.03 \times 0 = 0$
Total Living Area (Rounded):	951 Sq ft	
Non-living Area		
Area Below 5 Feet	56.2 Sq ft	$1.9 \times 12.02 = 22.84$ $1.9 \times 17.56 = 33.36$
Attic	159.71 Sq ft	$7.2 \times 10.28 = 74.02$ $5.2 \times 16.48 = 85.7$