

# Building Sketch

Borrower/Client			
Property Address 2705 Enon Church Road			
City	Salisbury	County	State NC Zip Code 28147
Lender			

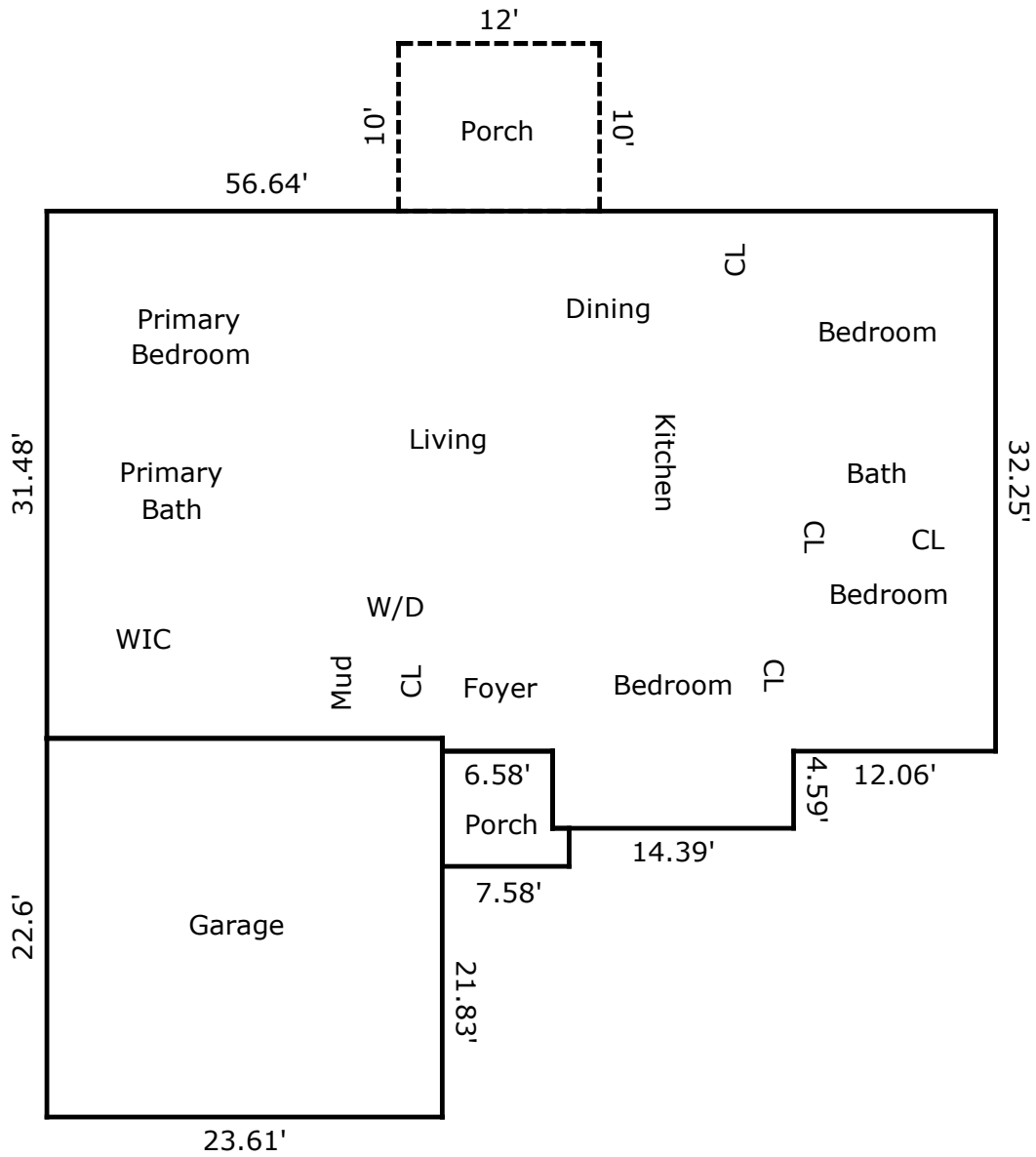

TOTAL Sketch by a la mode

### Area Calculations Summary

<b>Living Area</b>	
Main Level	1874.51 Sq ft
<b>Total Living Area (Rounded):</b>	<b>1875 Sq ft</b>
<b>Non-living Area</b>	
Garage	533.59 Sq ft
Patio	120 Sq ft
Porch	47.41 Sq ft