

Building Sketch

Borrower/Client				
Property Address 117 Louden Drive				
City	Mooresville	County	State NC	Zip Code 28115
Lender				

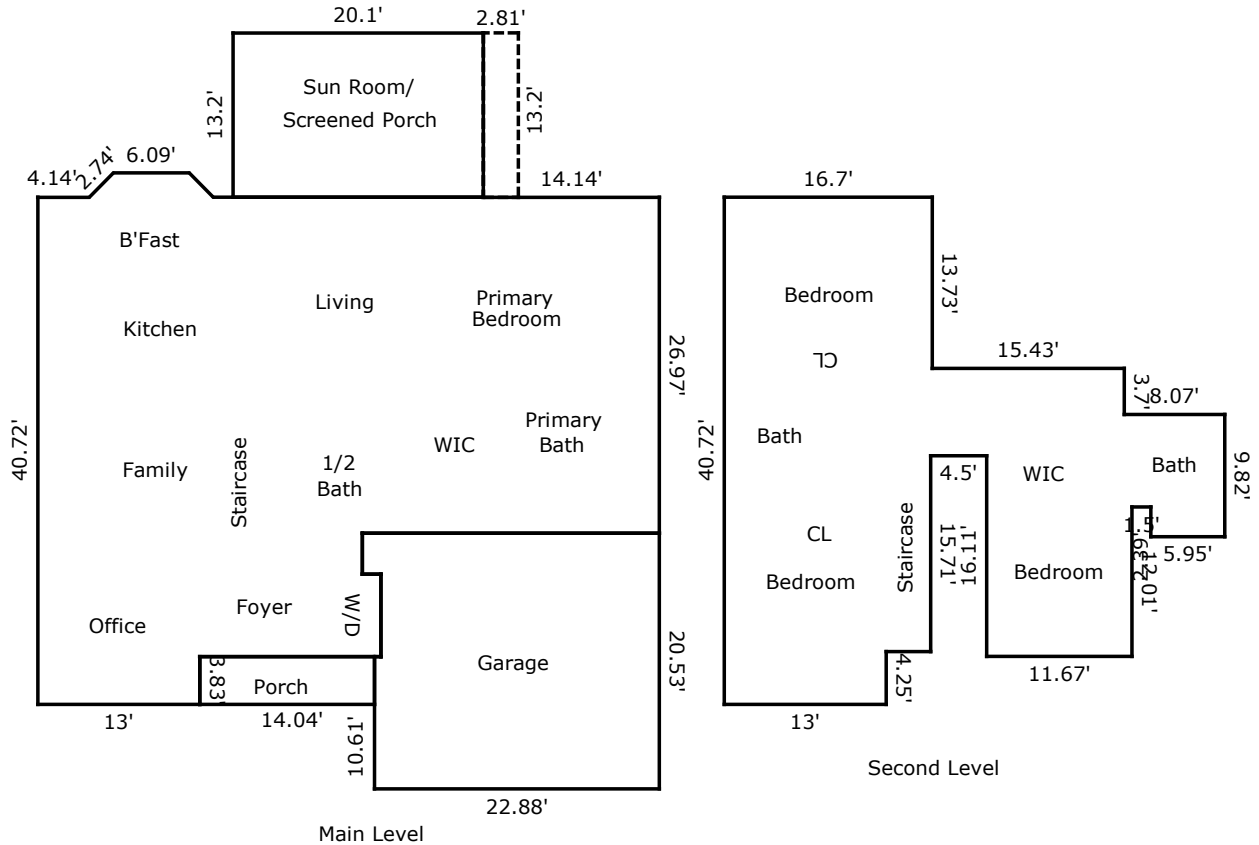

TOTAL Sketch by a la mode

Area Calculations Summary

Living Area	
Main Level	1680.1 Sq ft
Second Floor	1030.53 Sq ft
Total Living Area (Rounded):	2711 Sq ft
Non-living Area	
Screened Porch	265.32 Sq ft
Patio	37.09 Sq ft
Garage	469.64 Sq ft
Porch	53.77 Sq ft