

Basement
12'5" x 25'3"

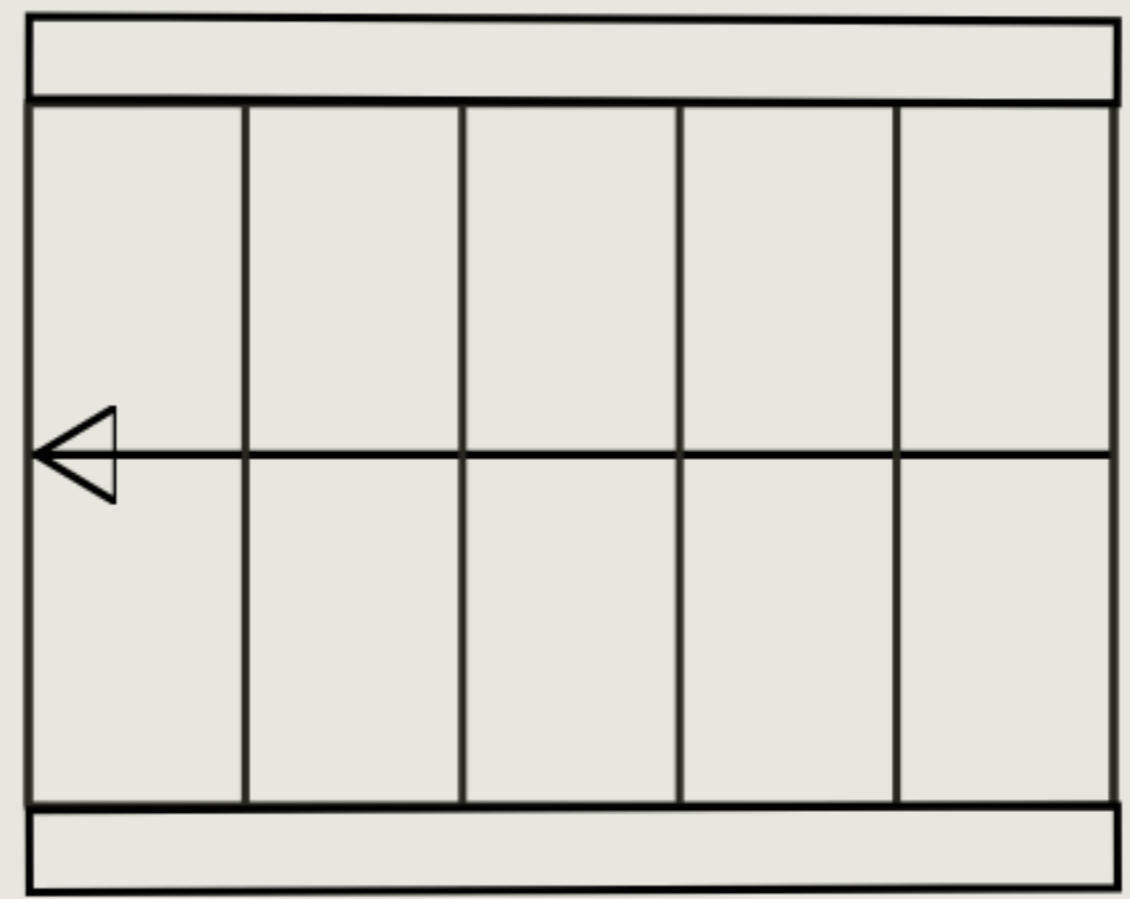

TOTAL: 1070 sq. ft
BELOW GROUND: 0 sq. ft, FLOOR 2: 1070 sq. ft
EXCLUDED AREAS: BASEMENT: 314 sq. ft, PORCH: 68 sq. ft

Please Note: Measurements Shown Are Highly Reliable, But Not Guaranteed.



TOTAL: 1070 sq. ft
 BELOW GROUND: 0 sq. ft, FLOOR 2: 1070 sq. ft
 EXCLUDED AREAS: BASEMENT: 314 sq. ft, PORCH: 68 sq. ft

Please Note: Measurements Shown Are Highly Reliable, But Not Guaranteed.

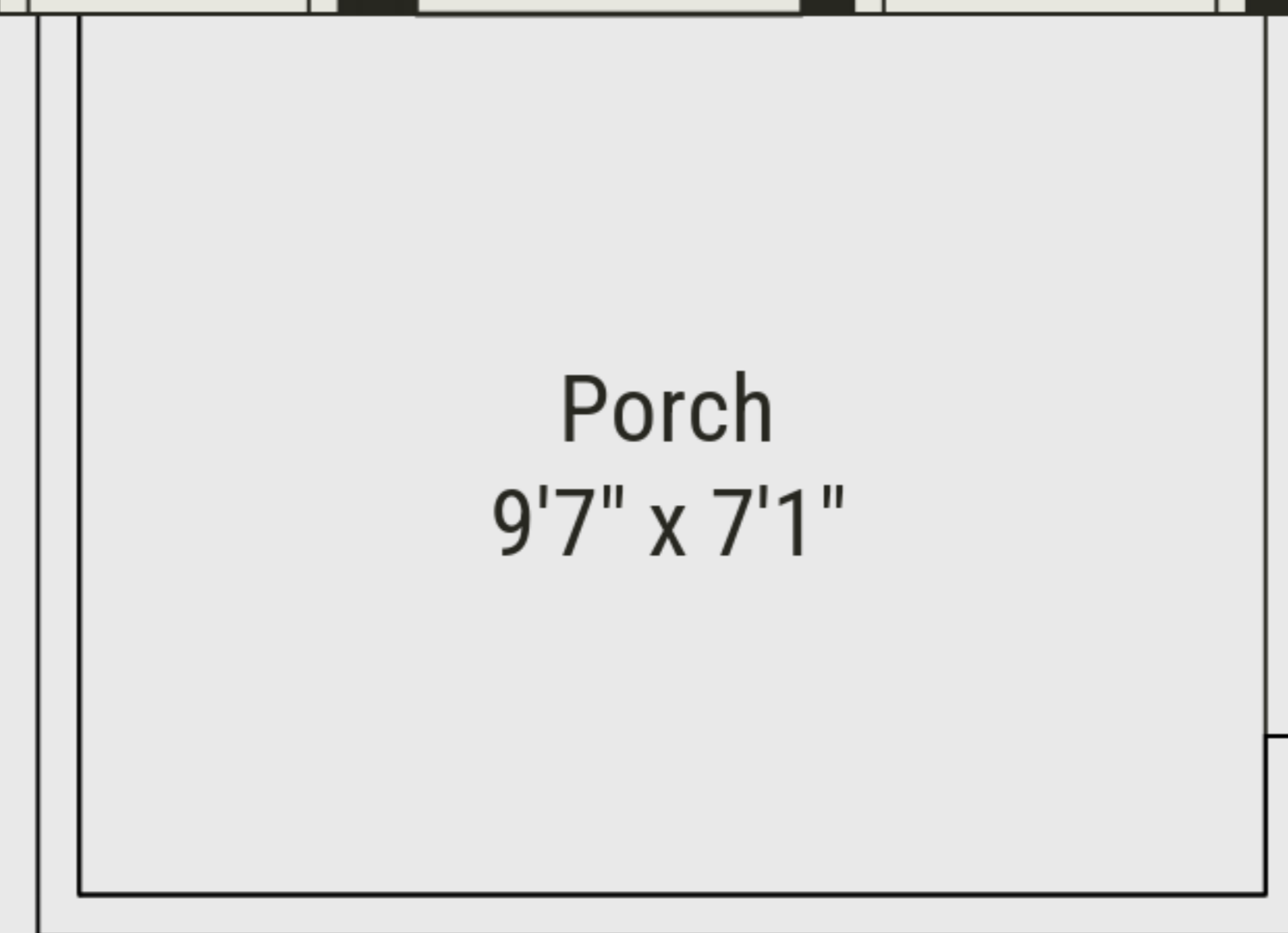
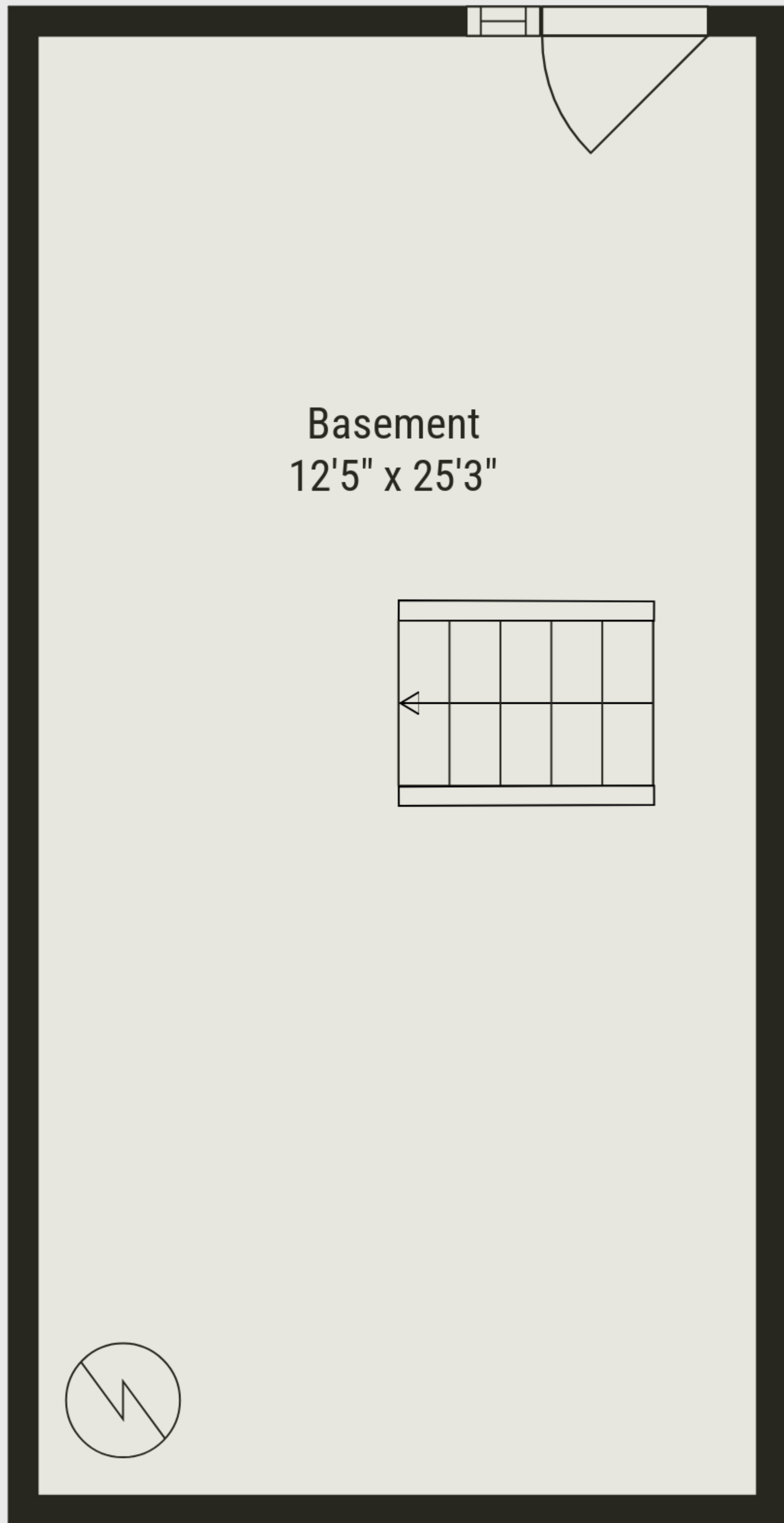

Floor 1

Floor 2



TOTAL: 1070 sq. ft
 BELOW GROUND: 0 sq. ft, FLOOR 2: 1070 sq. ft
 EXCLUDED AREAS: BASEMENT: 314 sq. ft, PORCH: 68 sq. ft

Please Note: Measurements Shown Are Highly Reliable, But Not Guaranteed.