

# Building Sketch

Borrower/Client				
Property Address 191 Celeste Eufola Road				
City	Statesville	County	State	Zip Code 28677
Lender				

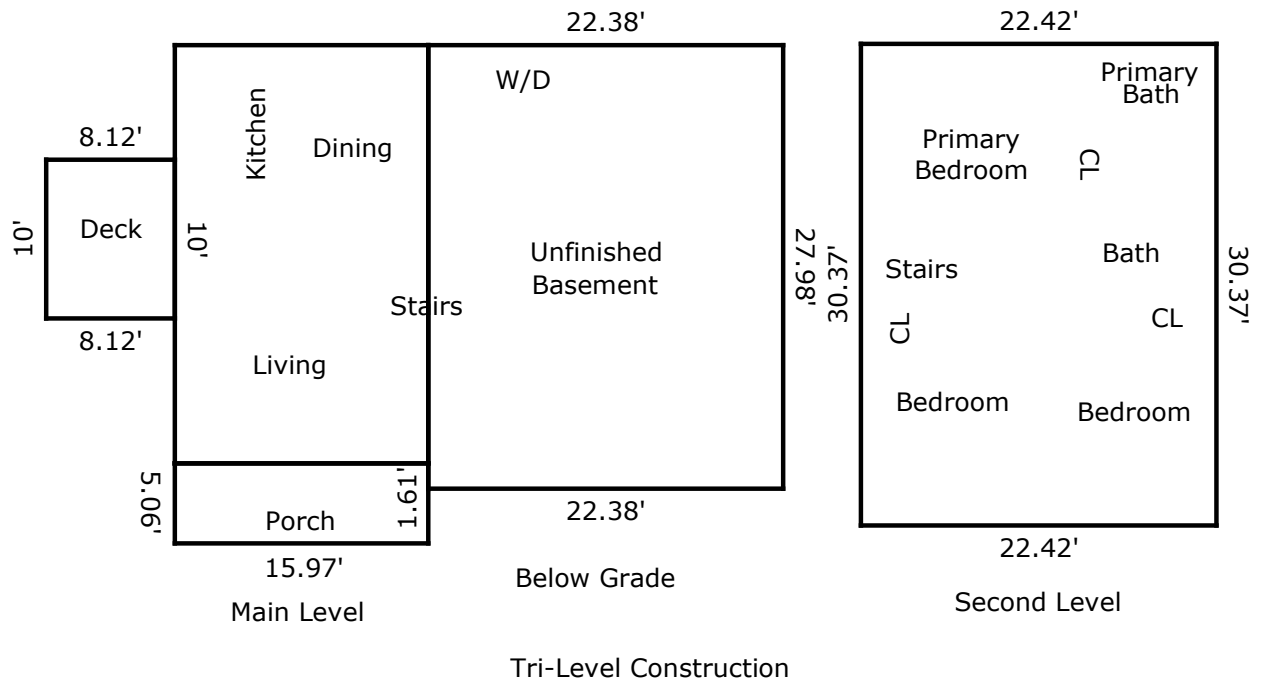

TOTAL Sketch by a la mode

### Area Calculations Summary

<b>Living Area</b>	
Main Level	626.19 Sq ft
Second Floor	680.9 Sq ft
<b>Total Living Area (Rounded):</b>	<b>1307 Sq ft</b>
<b>Non-living Area</b>	
Deck	81.2 Sq ft
Porch	80.81 Sq ft
Below Grade	421.13 Sq ft