

133 Country Brook Lane, Youngsville, Franklin County, North Carolina, United States, 27596

Gross Living Area: 2297 sq. ft

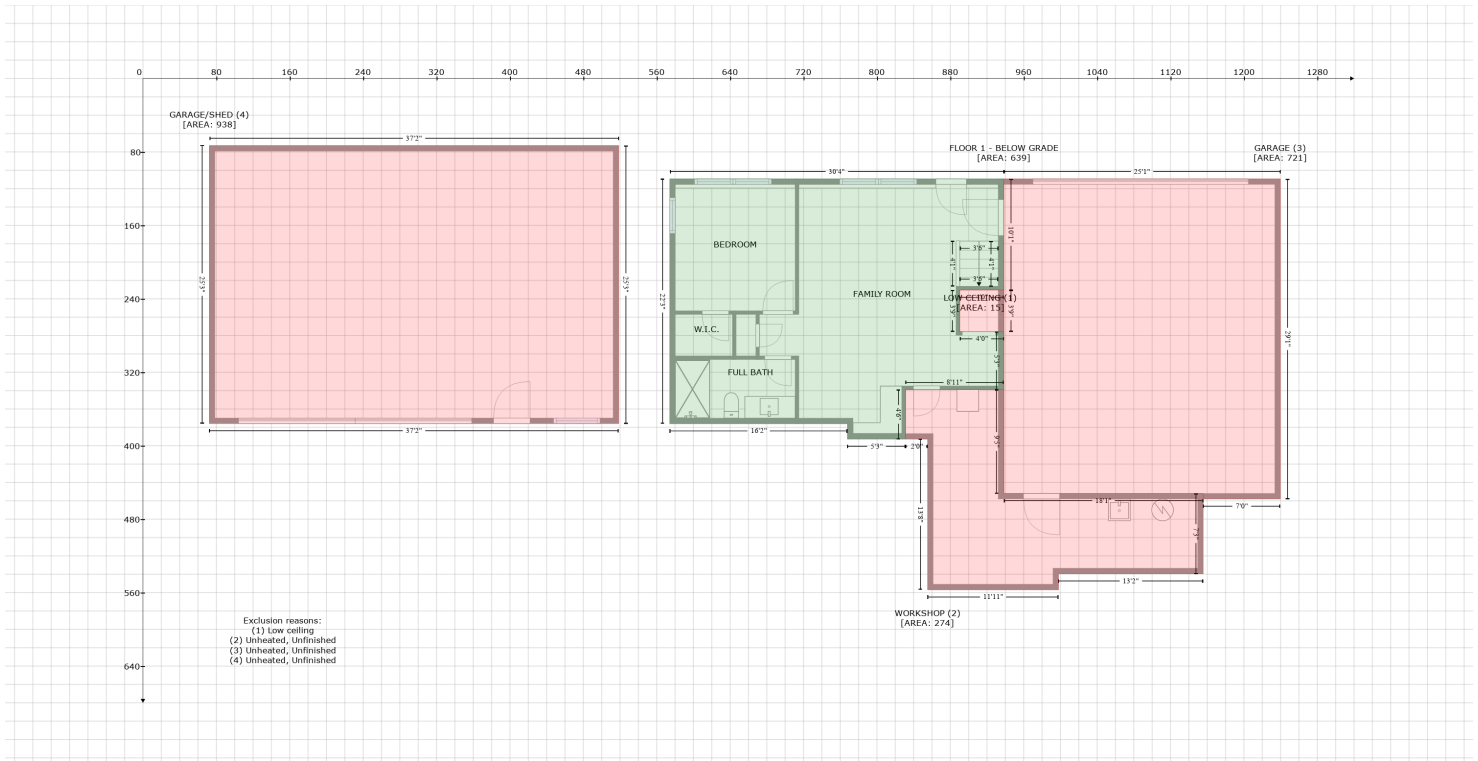

Space	Area (sq. ft)	Calculation
FLOOR 1 - BELOW GRADE (Living area)	639	Coordinate Polygon Area Algorithm using inches $-((938.3 + 938.3) * (109.4 - 230.4) + (938.3 + 890.2) * (230.4 - 230.4) + (890.2 + 890.2) * (230.4 - 275.7) + (890.2 + 938.3) * (275.7 - 275.7) + (938.3 + 938.3) * (275.7 - 338.9) + (938.3 + 831.3) * (338.9 - 338.9) + (831.3 + 831.3) * (338.9 - 392.8) + (831.3 + 767.9) * (392.8 - 392.8) + (767.9 + 767.9) * (392.8 - 376) + (767.9 + 574.2) * (376 - 376) + (574.2 + 574.2) * (376 - 109.4) + (574.2 + 938.3) * (109.4 - 109.4)) * 0.5 * 0.00694$
LOW CEILING (Non-living area)	15	$-((938.3 + 938.3) * (230.4 - 275.7) + (938.3 + 890.2) * (275.7 - 275.7) + (890.2 + 890.2) * (275.7 - 230.4) + (890.2 + 938.3) * (230.4 - 230.4)) * 0.5 * 0.00694$
WORKSHOP (Non-living area)	274	$-((938.3 + 938.3) * (338.9 - 452) + (938.3 + 1155.6) * (452 - 452) + (1155.6 + 1155.6) * (452 - 539.4) + (1155.6 + 997.9) * (539.4 - 539.4) + (997.9 + 997.9) * (539.4 - 556.9) + (997.9 + 855.3) * (556.9 - 556.9) + (855.3 + 855.3) * (556.9 - 392.8) + (855.3 + 831.3) * (392.8 - 392.8) + (831.3 + 831.3) * (392.8 - 338.9) + (831.3 + 938.3) * (338.9 - 338.9)) * 0.5 * 0.00694$
GARAGE (Non-living area)	721	$-((1239.7 + 1239.7) * (109.4 - 458) + (1239.7 + 1155.6) * (458 - 458) + (1155.6 + 1155.6) * (458 - 452) + (1155.6 + 938.3) * (452 - 452) + (938.3 + 938.3) * (452 - 109.4) + (938.3 + 1239.7) * (109.4 - 109.4)) * 0.5 * 0.00694$
GARAGE/SHED (Non-living area)	938	$-((518.5 + 518.5) * (73.1 - 375.9) + (518.5 + 72.4) * (375.9 - 375.9) + (72.4 + 72.4) * (375.9 - 73.1) + (72.4 + 518.5) * (73.1 - 73.1)) * 0.5 * 0.00694$

133 Country Brook Lane, Youngsville, Franklin County, North Carolina, United States, 27596

Gross Living Area: 2297 sq. ft

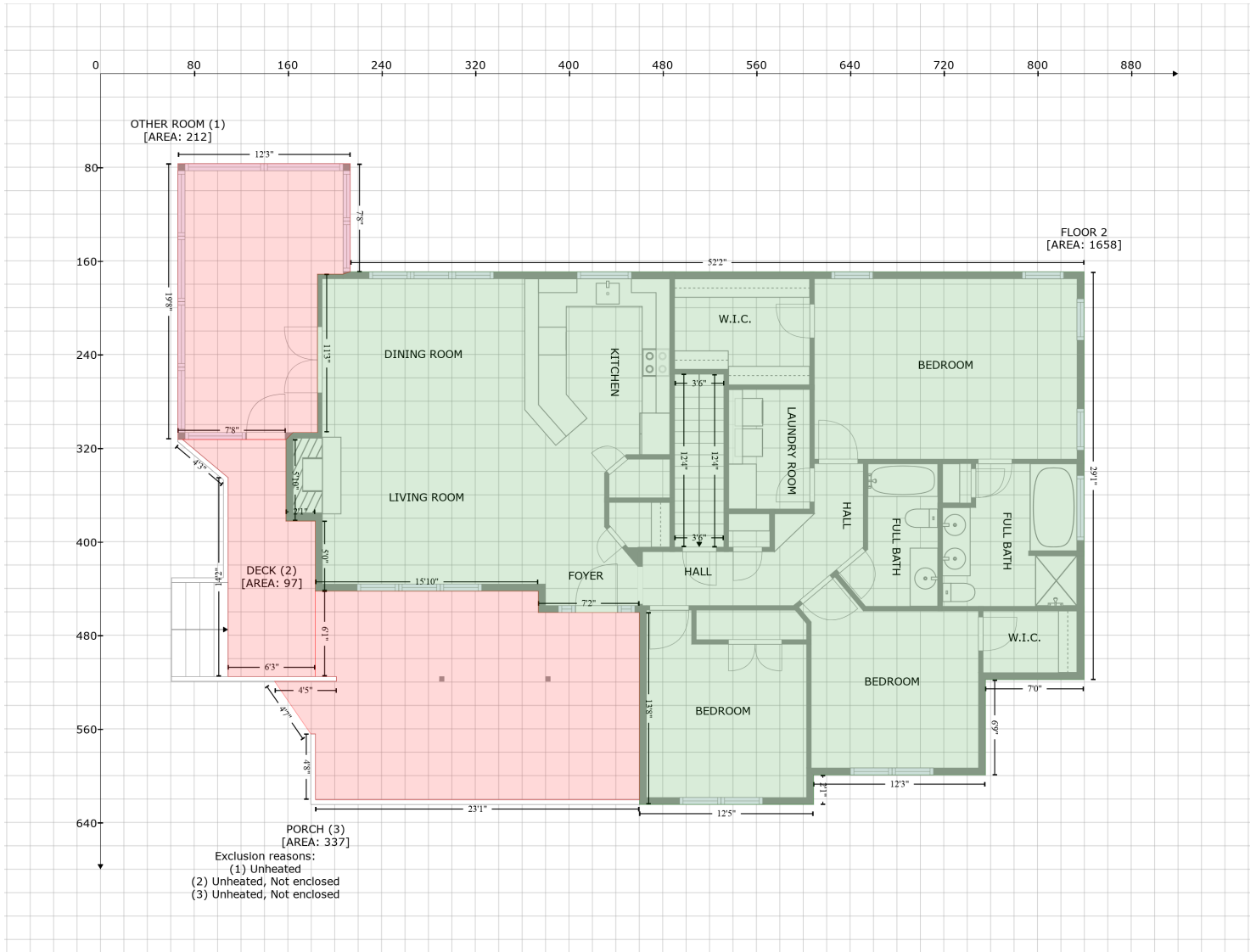

Space	Area (sq. ft)	Calculation
FLOOR 2 (Living area)	1658	$-\left((839.7 + 839.7) * (169.4 - 518) + (839.7 + 755.6) * (518 - 518) + (755.6 + 755.6) * (518 - 599.4) + (755.6 + 608.8) * (599.4 - 599.4) + (608.8 + 608.8) * (599.4 - 624.7) + (608.8 + 460.2) * (624.7 - 624.7) + (460.2 + 460.2) * (624.7 - 460.6) + (460.2 + 373.9) * (460.6 - 460.6) + (373.9 + 373.9) * (460.6 - 442.3) + (373.9 + 183.5) * (442.3 - 442.3) + (183.5 + 183.5) * (442.3 - 382.4) + (183.5 + 158.4) * (382.4 - 382.4) + (158.4 + 158.4) * (382.4 - 312.7) + (158.4 + 164.4) * (312.7 - 306.7) + (164.4 + 185.3) * (306.7 - 306.7) + (185.3 + 185.3) * (306.7 - 171.4) + (185.3 + 207.3) * (171.4 - 171.4) + (207.3 + 213.3) * (171.4 - 169.4) + (213.3 + 839.7) * (169.4 - 169.4)\right) * 0.5 * 0.00694$
OTHER ROOM (Non-living area)	212	$-\left((213.3 + 213.3) * (76.9 - 169.4) + (213.3 + 207.3) * (169.4 - 171.4) + (207.3 + 185.3) * (171.4 - 171.4) + (185.3 + 185.3) * (171.4 - 306.7) + (185.3 + 164.4) * (306.7 - 306.7) + (164.4 + 158.4) * (306.7 - 312.7) + (158.4 + 66.1) * (312.7 - 312.7) + (66.1 + 66.1) * (312.7 - 76.9) + (66.1 + 213.3) * (76.9 - 76.9)\right) * 0.5 * 0.00694$
DECK (Non-living area)	97	$-\left((158.4 + 158.4) * (312.7 - 382.4) + (158.4 + 183.5) * (382.4 - 382.4) + (183.5 + 183.5) * (382.4 - 515.3) + (183.5 + 108.9) * (515.3 - 515.3) + (108.9 + 109) * (515.3 - 345.3) + (109 + 70) * (345.3 - 312.7) + (70 + 158.4) * (312.7 - 312.7)\right) * 0.5 * 0.00694$

133 Country Brook Lane, Youngsville, Franklin County, North Carolina, United States, 27596

Gross Living Area: 2297 sq. ft

Space	Area (sq. ft)	Calculation <small>Coordinate Polygon Area Algorithm using inches</small>
PORCH (Non-living area)	337	$\begin{aligned} & -((373.9 + 373.9) * (442.3 - 460.6) + (373.9 + 460.2) * (460.6 - 460.6) + (460.2 + 460.2) * (460.6 - \\ & 620.7) + (460.2 + 183.6) * (620.7 - 620.7) + (183.6 + 183.6) * (620.7 - 564.4) + (183.6 + 179.6) * \\ & (564.4 - 564.4) + (179.6 + 148.6) * (564.4 - 519.4) + (148.6 + 201.4) * (519.4 - 519.4) + (201.4 + \\ & 201.4) * (519.4 - 515.4) + (201.4 + 183.5) * (515.4 - 515.2) + (183.5 + 183.5) * (515.2 - 442.3) + \\ & (183.5 + 373.9) * (442.3 - 442.3)) * 0.5 * 0.00694 \end{aligned}$