



Nº2. The Otterview

TRAIL RIVER ESTATES | LEESVILLE ROAD, EVINGTON, VA

1,536 SQ FT | 3 BEDROOMS | 2 BATHROOMS | 2-CAR GARAGE

Flexible, Open Layout with Cathedral Ceilings

Welcome to The Otterview

Designed with flexibility and function in mind, The Otterview offers a versatile layout ideal for families, multi-generational living, remote work, or entertaining — all within the scenic and serene setting of Trail River Estates.

Key Features

- Multi-Use Rooms – Ideal for bedrooms, home offices, or guest spaces
- Expansive Open Living Area – Cathedral ceilings with flowing living, dining & kitchen
- Two Full Bathrooms – Conveniently located for easy access
- Dedicated Hallways for Privacy – Separation between living & sleeping areas

Whether you're looking for a media room, playroom, or extra storage, The Otterview adapts to your lifestyle — offering endless possibilities in a peaceful mountain-view setting. Located on a 1.5-acre lot in the sought-after Brookville School District, this home combines privacy, beauty, and modern convenience.

Call Today: 434-546-9235

Email: gmcDaniel@countsauction.com

Visit Us Online: <https://TrailRiverEstates.com>



GEORGE MCDANIEL

Nº2. The Otterview

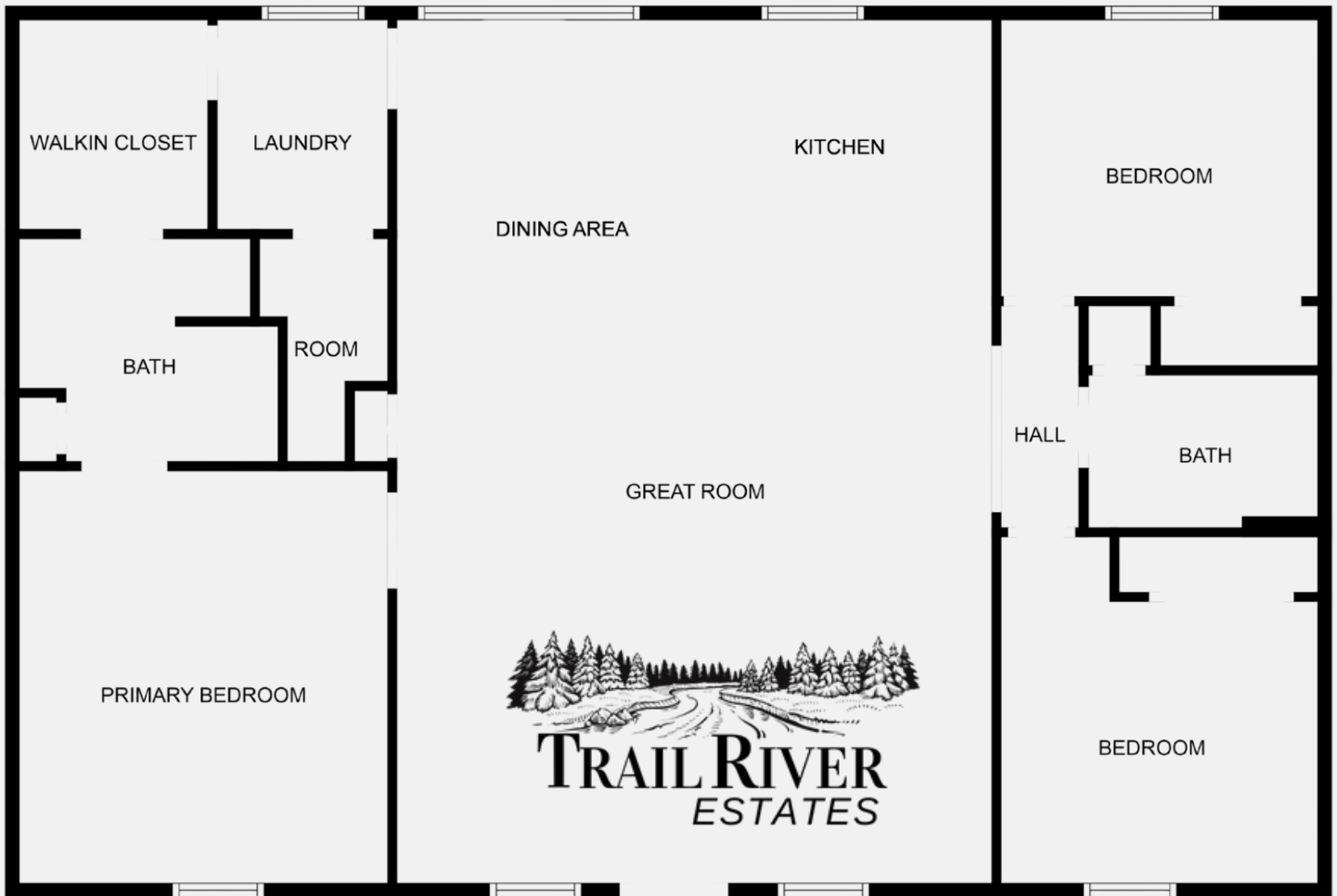

New 3-Bedroom, 2-Bath Homes

1,536 Sq Ft | Spacious 1.5-Acre Lots

Great Room

Brookville School District

Leesville Road, Evington, VA



Call Today: 434-546-9235

Email: gmcdaniel@countsauktion.com

Visit Us Online: <https://TrailRiverEstates.com>



GEORGE MCDANIEL

Nº2. The Otterview



Features You'll Love

- Open-Concept Layout | Living and dining areas flow seamlessly for everyday comfort & entertaining.
- Private Primary Suite | Includes a walk-in closet and full ensuite bathroom.
- Optional Upgrades | Basements and 2-car garages available to suit your needs.
- Smart Layout Details | Dedicated laundry room positioned for easy access and efficiency.
- Stylish Finishes | Granite countertops, LVP flooring, ceramic tile shower with glass doors in the primary bath, gas fireplace, and 12x16 rear decks.
- Prime Location | Enjoy peaceful living with quick access to Lynchburg, Bedford, and Altavista.

Call Today: 434-546-9235

Email: gmcdaniel@countsauction.com

Visit Us Online: <https://TrailRiverEstates.com>



GEORGE MCDANIEL