

# SKETCH/AREA TABLE ADDENDUM

## SUBJECT INFO

File No.: Parcel No.:  
 Property Address: 110 White Swan Way  
 City: Swansboro County: Onslow State: NC ZipCode: 28584  
 Owner:  
 Client: Tom Rieck Client Address:  
 Verifier Name: Paul Hayden Inspection Date: 12/20/2024

## SKETCH

# 110 White Swan Way, Swansboro NC 2,410 SF

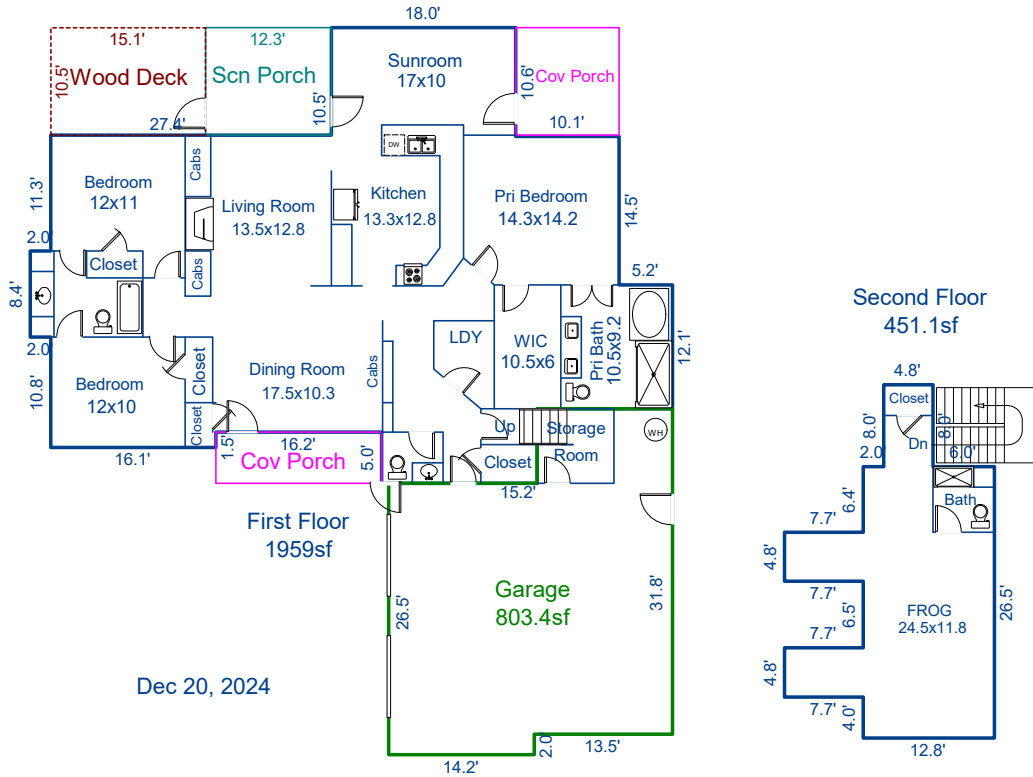

Disclosure: Interior walls and room sizes are approximate

**Floor Plan by Size Matters 910-797-0439**

Sketch by ApexSketch

AREA CALCULATIONS SUMMARY						AREA CALCULATIONS BREAKDOWN				
Code	Description	Factor	Net Size	Perimeter	Net Totals	Name	Base x	Height x	Width =	Area
GLA1	First Floor	1.0	1959.0	217.4	1959.0	First Floor		8.4 x	2.0 =	16.8
GLA2	Second Floor	1.0	451.1	125.4	451.1			28.4 x	12.1 =	343.6
GAR	Garage	1.0	803.4	123.0	803.4			23.2 x	14.5 =	336.4
P/P	Cov Porch	1.0	81.0	42.4				15.2 x	7.3 =	111.0
	Cov Porch	1.0	106.1	41.2				13.1 x	10.6 =	138.9
	Scn Porch	1.0	129.2	45.6				39.5 x	4.9 =	193.6
	Wood Deck	1.0	158.6	51.2	474.8			29.0 x	27.4 =	794.6
								16.1 x	1.5 =	24.2
						Second Floor		7.7 x	4.8 =	37.0
								7.7 x	4.8 =	37.0
								26.5 x	12.8 =	338.9
								8.0 x	4.8 =	38.3
	Net LIVABLE	cnt	2 (rounded)		2,410	12 total items			(rounded)	2,410

# SKETCH/AREA TABLE ADDENDUM

## SUBJECT INFO

File No.:	Parcel No.:		
Property Address: 110 White Swan Way			
City: Swansboro	County: Onslow	State: NC	ZipCode: 28584
Owner:			
Client: Tom Rieck		Client Address:	
Verifier Name: Paul Hayden		Inspection Date: 12/20/2024	

## SKETCH

### First Floor (GLA1)

8.40 x 2.00 = 16.80
28.40 x 12.10 = 343.64
23.20 x 14.50 = 336.40
15.20 x 7.30 = 110.96
13.10 x 10.60 = 138.86
39.50 x 4.90 = 193.55
29.00 x 27.40 = 794.60
16.10 x 1.50 = 24.15
Total area: 1958.96

### Garage (GAR)

26.50 x 14.20 = 376.30
24.50 x 13.50 = 330.75
13.20 x 7.30 = 96.36
Total area: 803.41

### Cov Porch (P/P)

16.20 x 3.50 = 56.70
16.20 x 1.50 = 24.30
Total area: 81.00

### Cov Porch (P/P)

10.50 x 10.10 = 106.05
Total area: 106.05

### Scn Porch (P/P)

12.30 x 10.50 = 129.15
Total area: 129.15

### Wood Deck (P/P)

15.10 x 10.50 = 158.55
Total area: 158.55

### Second Floor (GLA2)

7.70 x 4.80 = 36.96
7.70 x 4.80 = 36.96
26.50 x 12.79 = 338.86
8.00 x 4.79 = 38.30
Total area: 451.08