

# 872 Harbor Island, 700 Island Way, Clearwater Beach, Pinellas County, Florida, United States, 33767

Gross Living Area: 2422 sq. ft

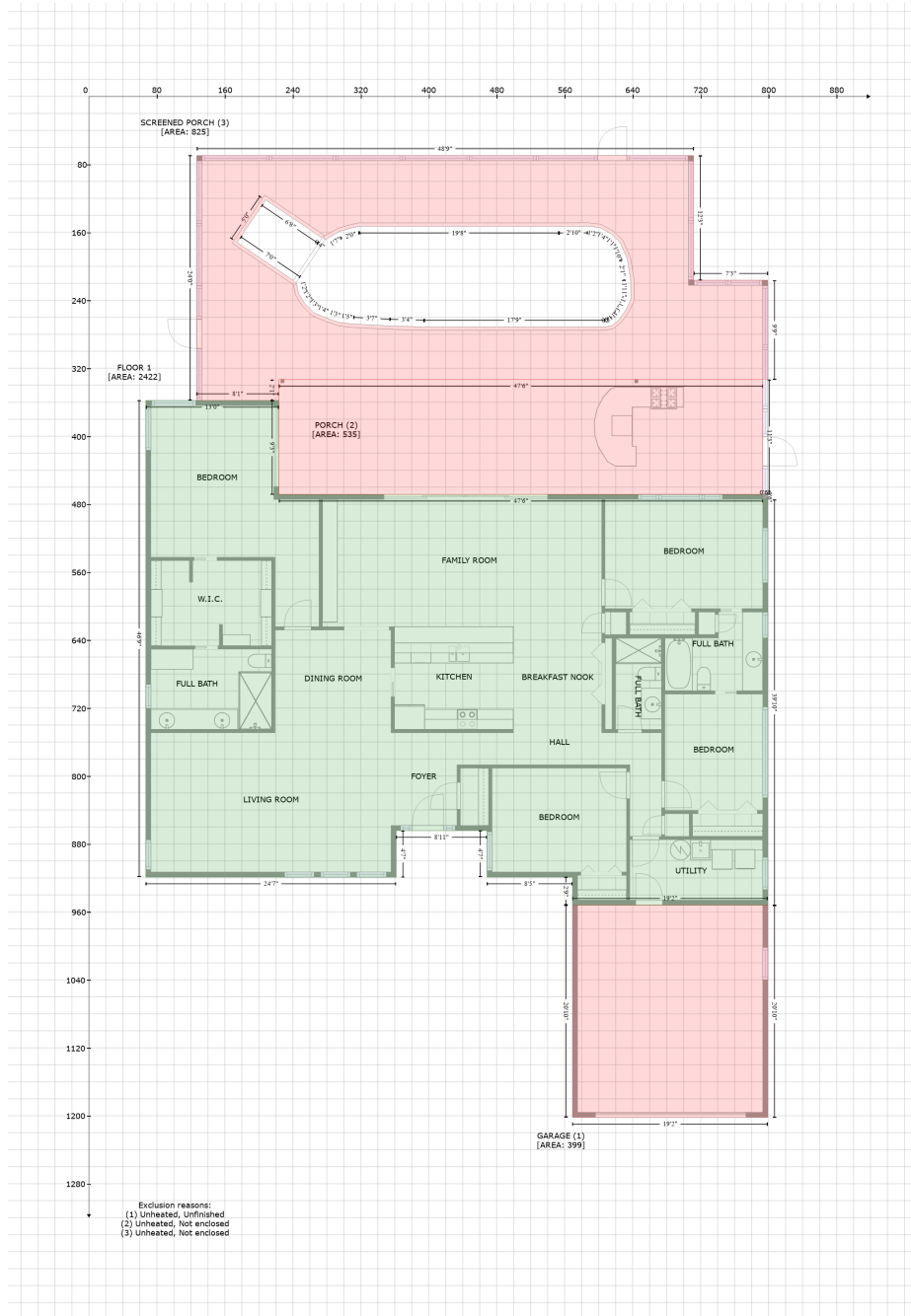

Space	Area (sq. ft)	Calculation
FLOOR 1 (Living area)	2422	Coordinate Polygon Area Algorithm using inches $-((223.5 + 223.5) * (357.9 - 468.5) + (223.5 + 793.1) * (468.5 - 468.5) + (793.1 + 793.1) * (468.5 - 474.5) + (793.1 + 799.1) * (474.5 - 474.5) + (799.1 + 799.1) * (474.5 - 952) + (799.1 + 569.2) * (952 - 952) + (569.2 + 569.2) * (952 - 919) + (569.2 + 468.6) * (919 - 919) + (468.6 + 468.6) * (919 - 864.3) + (468.6 + 361.6) * (864.3 - 864.3) + (361.6 + 361.6) * (864.3 - 919) + (361.6 + 67) * (919 - 919) + (67 + 67) * (919 - 357.9) + (67 + 223.5) * (357.9 - 357.9)) * 0.5 + 0.00694$
GARAGE	399	$-((799.1 + 799.1) * (952 - 1201.9) + (799.1 + 569.2) * (1201.9 - 1201.9) + (569.2 + 569.2) * (1201.9 - 1201.9)) * 0.5 + 0.00694$

# 872 Harbor Island, 700 Island Way, Clearwater Beach, Pinellas County, Florida, United States, 33767

Gross Living Area: 2422 sq. ft

Space	Area (sq. ft)	Calculation <small>Coordinate Polygon Area Algorithm using inches</small>
(Non-living area)		$(1201.9 - 952) + (569.2 + 799.1) * (952 - 952)) * 0.5 * 0.00694$
PORCH (Non-living area)	535	$-((793.1 + 793.1) * (333.2 - 468.5) + (793.1 + 223.5) * (468.5 - 468.5) + (223.5 + 223.5) * (468.5 - 333.2) + (223.5 + 793.1) * (333.2 - 333.2)) * 0.5 * 0.00694$
SCREENED PORCH (Non-living area)	825	$-((711.7 + 711.7) * (69.5 - 216.3) + (711.7 + 799.1) * (216.3 - 216.3) + (799.1 + 799.1) * (216.3 - 333.2) + (799.1 + 223.5) * (333.2 - 333.2) + (223.5 + 223.5) * (333.2 - 357.9) + (223.5 + 126.9) * (357.9 - 357.9) + (126.9 + 126.9) * (357.9 - 69.5) + (126.9 + 711.7) * (69.5 - 69.5)) * 0.5 * 0.00694 + -((208 + 174.3) * (121.8 - 171.8) + (174.3 + 244) * (171.8 - 218.8) + (244 + 247) * (218.8 - 232.3) + (247 + 254.3) * (232.3 - 244.1) + (254.3 + 265.2) * (244.1 - 254.9) + (265.2 + 280.1) * (254.9 - 261.1) + (280.1 + 294.5) * (261.1 - 265.9) + (294.5 + 310.9) * (265.9 - 267.9) + (310.9 + 353.9) * (267.9 - 270.1) + (353.9 + 394.3) * (270.1 - 271.3) + (394.3 + 607) * (271.3 - 271.3) + (607 + 615.3) * (271.3 - 269.8) + (615.3 + 624.1) * (269.8 - 262.8) + (624.1 + 632.7) * (262.8 - 250.2) + (632.7 + 638) * (250.2 - 238.7) + (638 + 637.6) * (238.7 - 215.9) + (637.6 + 633.7) * (215.9 - 191.5) + (633.7 + 625.1) * (191.5 - 171.8) + (625.1 + 615.5) * (171.8 - 162.3) + (615.5 + 601.5) * (162.3 - 154.4) + (601.5 + 587.2) * (154.4 - 152.7) + (587.2 + 553.4) * (152.7 - 152.9) + (553.4 + 317.5) * (152.9 - 152.9) + (317.5 + 294.3) * (152.9 - 159.1) + (294.3 + 277.7) * (159.1 - 168.9) + (277.7 + 274.5) * (168.9 - 166.6) + (274.5 + 208) * (166.6 - 121.8)) * 0.5 * 0.00694$