

Building Sketch

Borrower/Client				
Property Address 107 Fosters Glen Place				
City	Mooresville	County	State NC	Zip Code 28115
Lender				

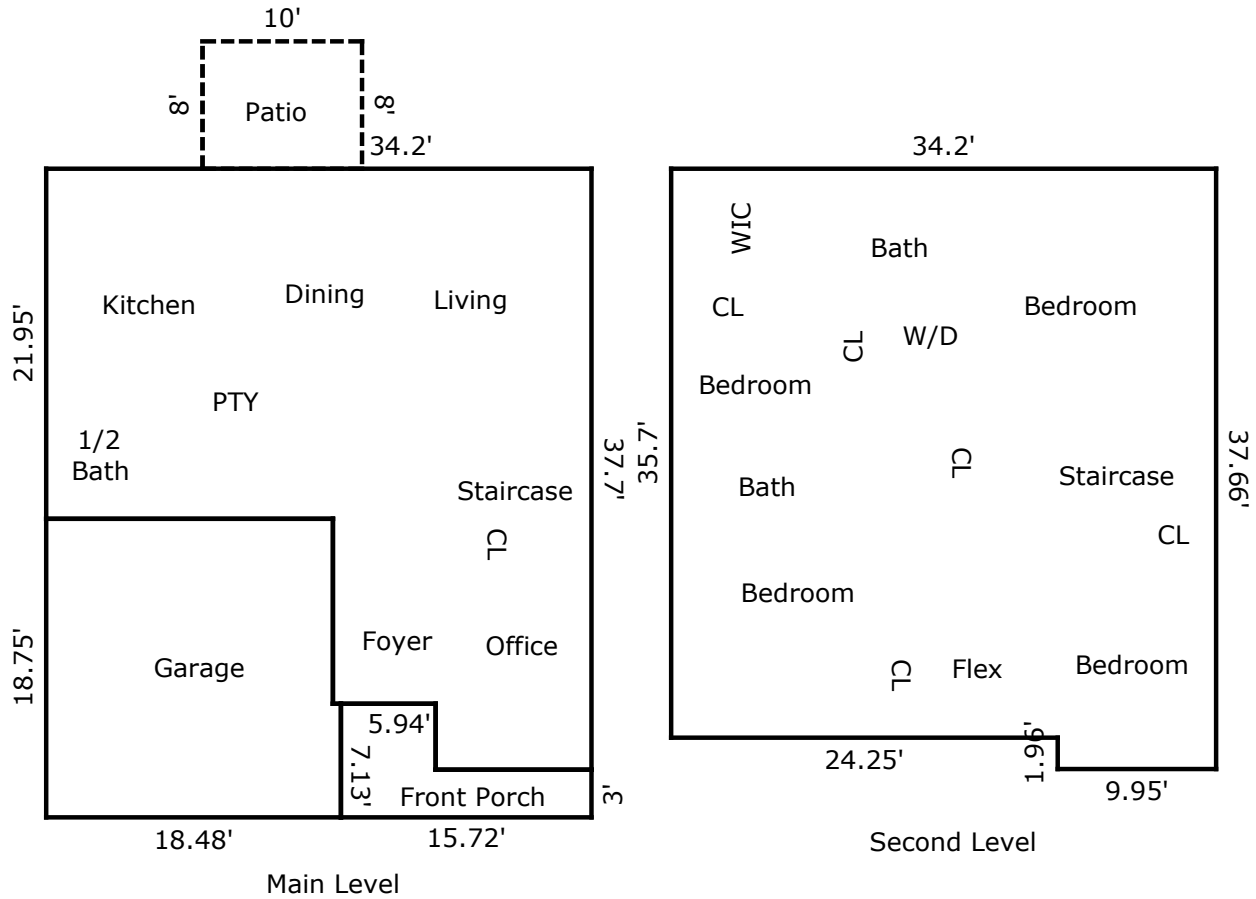

TOTAL Sketch by a la mode

Area Calculations Summary

Living Area	Calculation Details	
Main Living Area	979.56 Sq ft	21.95 × 17.98 = 394.66 16.22 × 33.57 = 544.51 9.78 × 4.13 = 40.39
Second Level	1240.44 Sq ft	34.2 × 35.7 = 1220.94 1.96 × 9.95 = 19.5
Total Living Area (Rounded):	2220 Sq ft	
Non-living Area		
Garage	340.69 Sq ft	18.75 × 17.98 = 337.12 0.5 × 7.13 = 3.56
Porch	71.69 Sq ft	7.13 × 5.94 = 42.35 3 × 9.78 = 29.34
Patio	80 Sq ft	10 × 8 = 80