

Building Sketch

Borrower/Client				
Property Address 3109 Timber Mill Drive				
City	Stallings	County	State NC	Zip Code 28104
Lender				

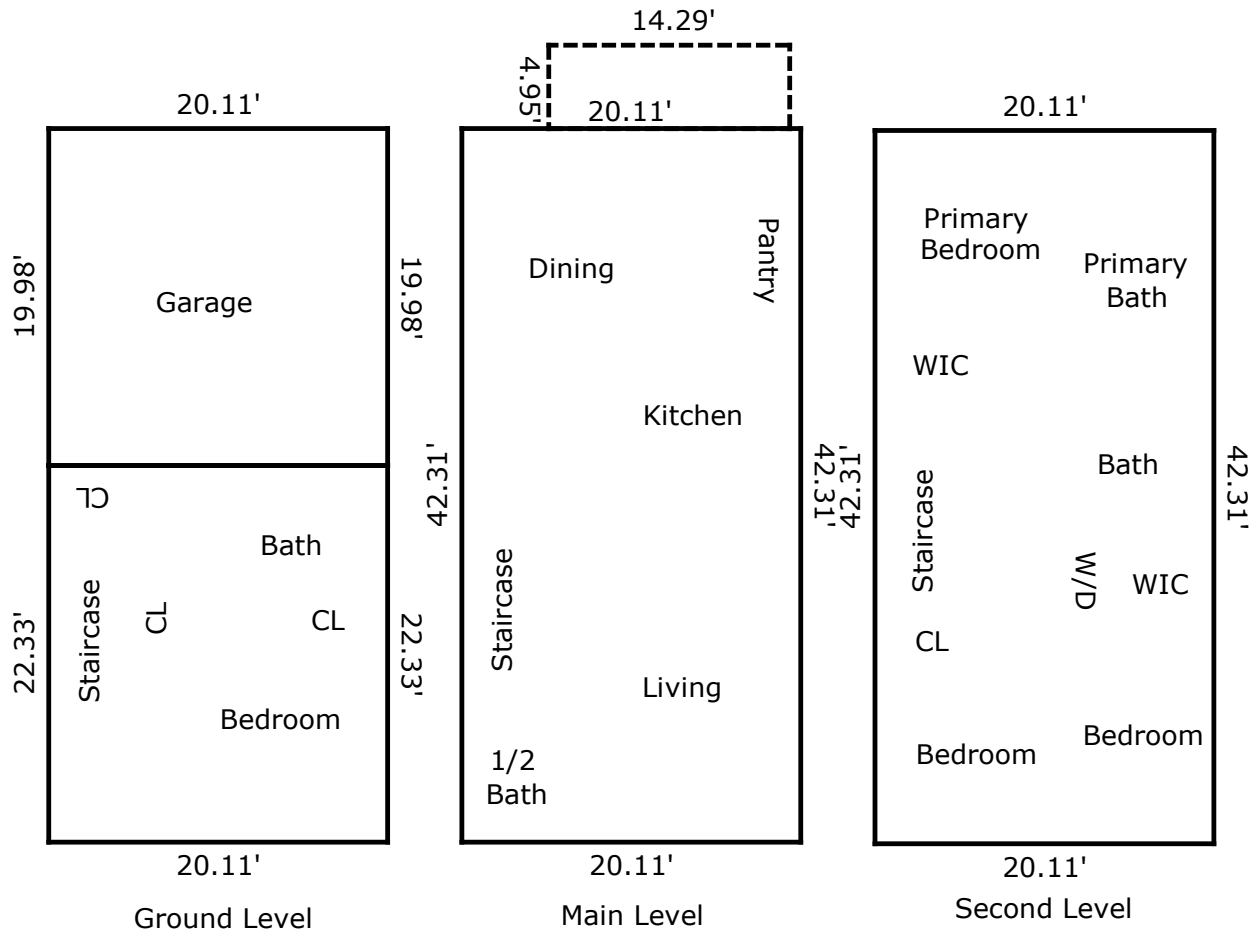

TOTAL Sketch by a la mode

Area Calculations Summary

Living Area	
Main Level	850.85 Sq ft
Main Level	850.85 Sq ft
Main Level	449.06 Sq ft
Total Living Area (Rounded):	2151 Sq ft
Non-living Area	
Garage	401.8 Sq ft
Balcony	70.74 Sq ft