

Building Sketch

Borrower/Client				
Property Address 5351 Faith Road				
City	Salisbury	County	State NC	Zip Code 28146
Lender				

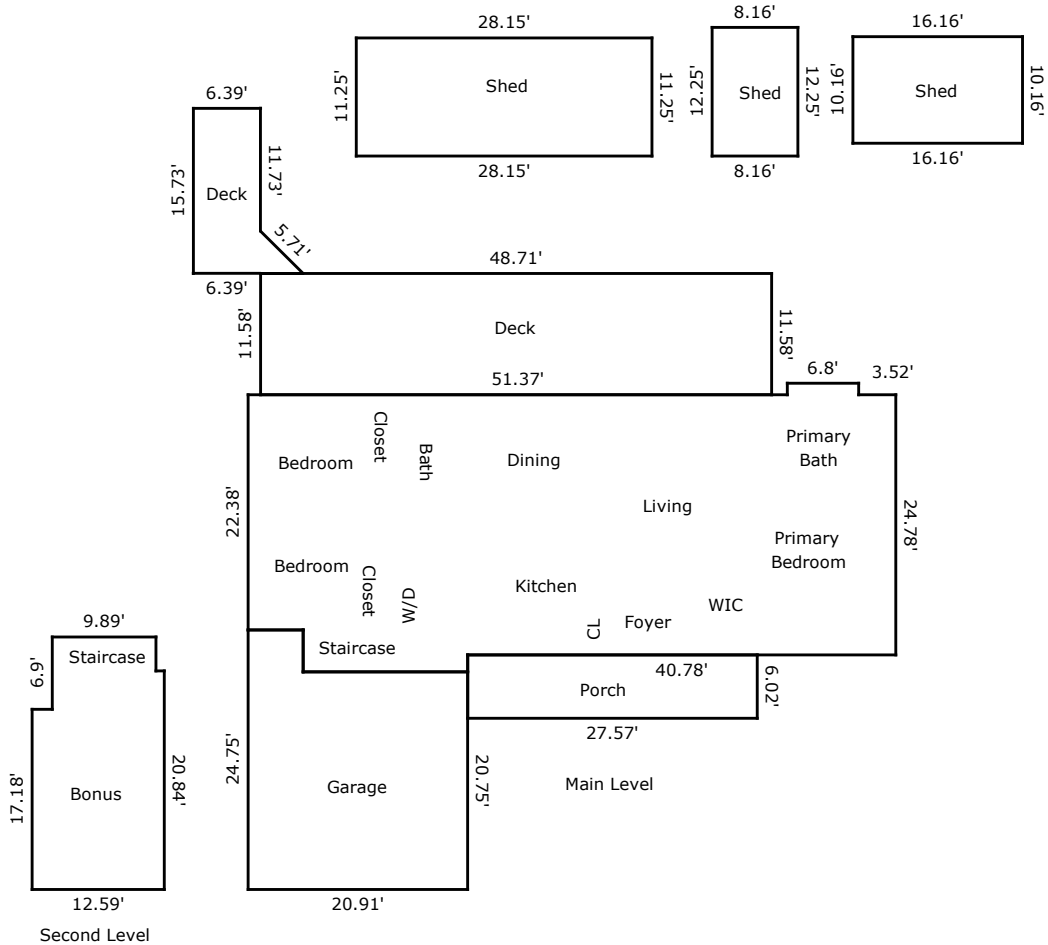

TOTAL Sketch by a la mode

Area Calculations Summary

Living Area	
Main Level	1548.65 Sq ft
Second Level	287.39 Sq ft
Total Living Area (Rounded):	1836 Sq ft
Non-living Area	
Deck	564.06 Sq ft
Deck	108.67 Sq ft
Shed	316.69 Sq ft
Garage	454.84 Sq ft
Porch	165.97 Sq ft
Shed	99.96 Sq ft
Shed	164.19 Sq ft