

1670 Clearwater Harbor Drive, Harbor Bluffs, Largo, Pinellas County, Florida, United States, 33770

Gross Living Area: 2457 sq. ft

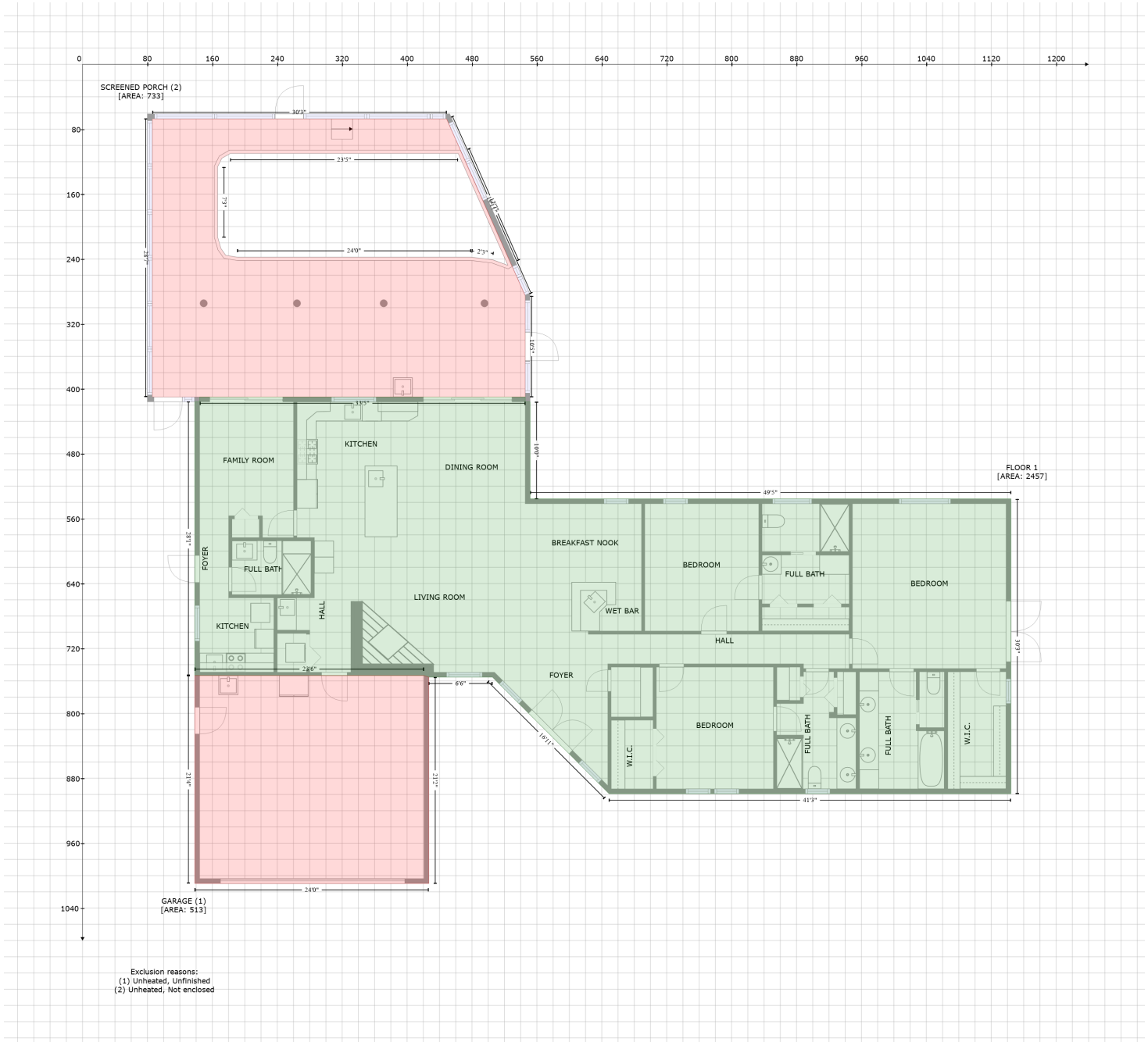

Space	Area (sq. ft)	Calculation
FLOOR 1 (Living area)	2457	Coordinate Polygon Area Algorithm using inches $-((545.7 + 545.7) * (410 - 416) + (545.7 + 551.7) * (416 - 416) + (551.7 + 551.7) * (416 - 535.6) + (551.7 + 1144.3) * (535.6 - 535.6) + (1144.3 + 1144.3) * (535.6 - 899.1) + (1144.3 + 649) * (899.1 - 899.1) + (649 + 505.3) * (899.1 - 755.4) + (505.3 + 426.8) * (755.4 - 755.4) + (426.8 + 420.8) * (755.4 - 753.4) + (420.8 + 138.4) * (753.4 - 753.4) + (138.4 + 138.4) * (753.4 - 416) + (138.4 + 144.4) * (416 - 416) + (144.4 + 144.4) * (416 - 410) + (144.4 + 545.7) * (410 - 410)) * 0.5 * 0.00694$

1670 Clearwater Harbor Drive, Harbor Bluffs, Largo, Pinellas County, Florida, United States, 33770

Gross Living Area: 2457 sq. ft

Space	Area (sq. ft)	Calculation <small>Coordinate Polygon Area Algorithm using inches</small>
GARAGE (Non-living area)	513	$-\left((420.8 + 426.8) * (753.4 - 755.4) + (426.8 + 426.8) * (755.4 - 1009.7) + (426.8 + 138.4) * (1009.7 - 1009.7) + (138.4 + 138.4) * (1009.7 - 753.4) + (138.4 + 420.8) * (753.4 - 753.4)\right) * 0.5 * 0.00694$
SCREENED PORCH (Non-living area)	733	$-\left((448.6 + 545.7) * (67.1 - 285.3) + (545.7 + 545.7) * (285.3 - 410) + (545.7 + 85.9) * (410 - 410) + (85.9 + 85.9) * (410 - 67.1) + (85.9 + 448.6) * (67.1 - 67.1)\right) * 0.5 * 0.00694 - \left((463 + 182.2) * (109.8 - 109.9) + (182.2 + 171.6) * (109.9 - 115.9) + (171.6 + 166.4) * (115.9 - 126.5) + (166.4 + 166.4) * (126.5 - 213.1) + (166.4 + 170.6) * (213.1 - 227) + (170.6 + 176.5) * (227 - 235.4) + (176.5 + 190.6) * (235.4 - 237.7) + (190.6 + 478.6) * (237.7 - 237.7) + (478.6 + 505.4) * (237.7 - 240.9) + (505.4 + 524.2) * (240.9 - 247.7) + (524.2 + 463) * (247.7 - 109.8)\right) * 0.5 * 0.00694$