

# Building Sketch

Borrower/Client

Property Address 1904 Old Pageland Road

City Marshville

County

State NC

Zip Code 28103

Lender

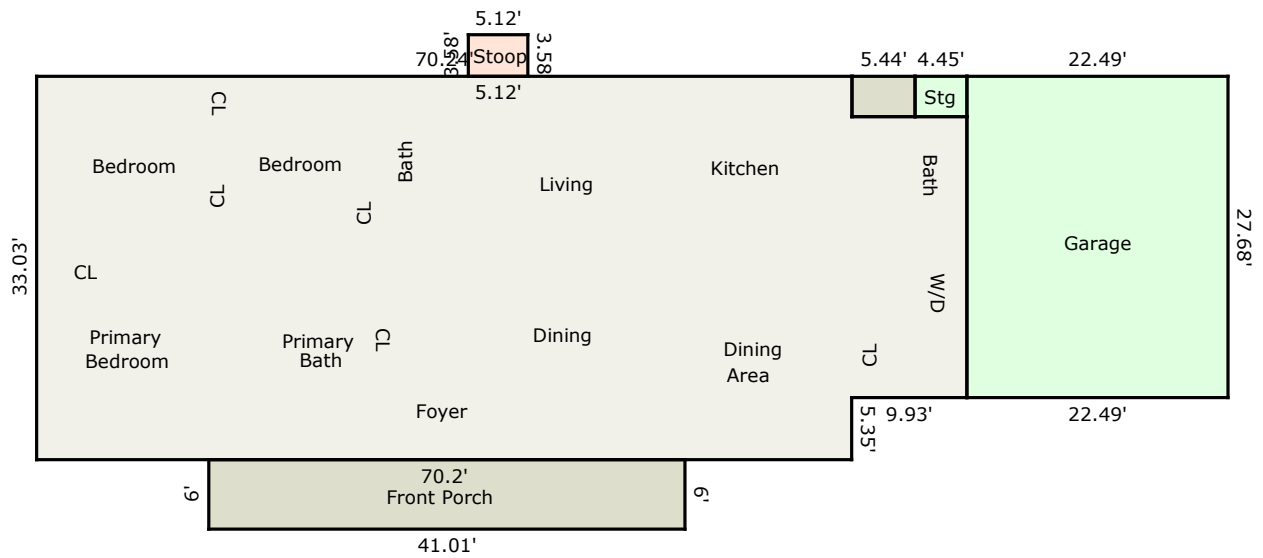

TOTAL Sketch by a la mode

## Area Calculations Summary

Living Area		Calculation Details	
Main Living Area	2559.15 Sq ft	$33.03 \times 70.2$	= 2318.71
		$9.93 \times 24.2$	= 240.31
		$0.04 \times 3.48$	= 0.14
<b>Total Living Area (Rounded):</b>		<b>2559 Sq ft</b>	
Non-living Area			
Garage	622.52 Sq ft	$27.68 \times 22.49$	= 622.52
Stoop	18.33 Sq ft	$5.12 \times 3.58$	= 18.33
Porch	246.06 Sq ft	$41.01 \times 6$	= 246.06
Porch	18.93 Sq ft	$3.48 \times 5.44$	= 18.93
Storage	15.49 Sq ft	$4.45 \times 3.48$	= 15.49

## Building Sketch

Borrower/Client

Property Address

City

County

State

Zip Code

Lender

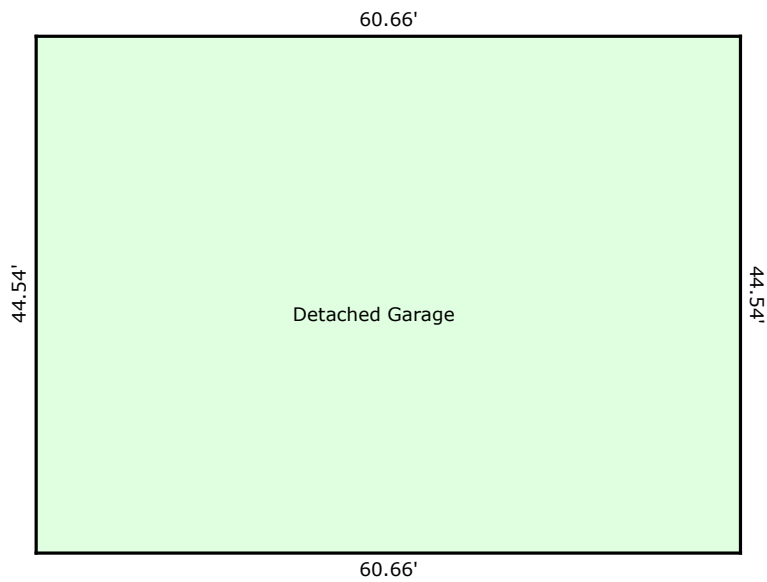

TOTAL Sketch by a la mode

### Area Calculations Summary

#### Non-living Area

Detached Garage

2701.8 Sq ft

$60.66 \times 44.54 = 2701.8$