

Building Sketch

Borrower/Client				
Property Address 300 Washington Park Road				
City	Mt. Gilead	County	State NC	Zip Code 27306
Lender				

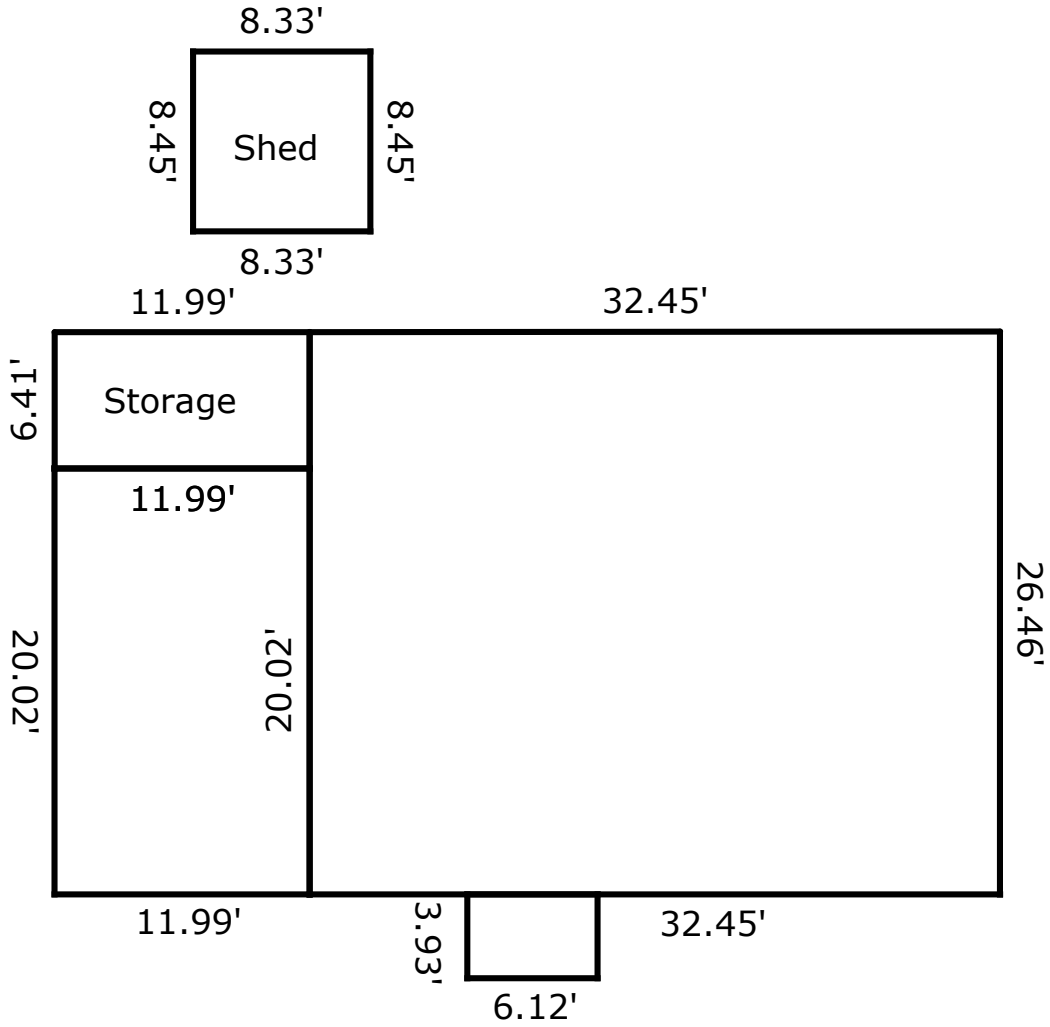

House was boarded up due to fire damage
Room layout was not determined

TOTAL Sketch by a la mode

Area Calculations Summary

Living Area	
Main Level	858.27 Sq ft
Total Living Area (Rounded):	858 Sq ft
Non-living Area	
Porch	24.05 Sq ft
Shed	70.39 Sq ft
Storage	76.9 Sq ft
Carport	240.04 Sq ft