

**Supplemental Addendum**

File No. K0060401

Borrower	N/A				
Property Address	6700 Forest Village Way				
City	Knoxville	County	Knox	State	TN
Lender/Client	Lesli Fox				
				Zip Code	37919

**Measurements for 6700 Forest Village Way**

<b>1st Floor</b>	<b>1967 square feet</b>
<b>2nd Floor</b>	<b>918 square feet</b>
<b>Total GLA</b>	<b>2885 square feet</b>
<b>Garage</b>	<b>502 square feet</b>
<b>Unfinished Basement</b>	<b>2238 square feet</b>

The Square Footage-Method for Calculating: ANSI® Z765-2021 (American National Standards Institute®) Measuring Standard for calculating gross living area (GLA), and non-GLA areas of the subject property, was utilized in creating the sketch for this appraisal report.

**Interior Room Measurements**

**1st Floor**

<b>Dining</b>	<b>14 x 12.5</b>
<b>Living</b>	<b>18 x 16.5</b>
<b>Kitchen</b>	<b>17 x 10</b>
<b>Breakfast</b>	<b>24 x 7.5</b>
<b>Laundry</b>	<b>8 x 5.5</b>
<b>Primary Bedroom</b>	<b>18.5 x 13</b>
<b>Primary Bath</b>	<b>13 x 11.5</b>
<b>Bath 2</b>	<b>8 x 7.5 x irr</b>
<b>Bedroom 2</b>	<b>11.5 x 10</b>

**2nd Floor**

<b>Bedroom 3</b>	<b>11 x 10</b>
<b>Bathroom 3</b>	<b>12.5 x 5</b>
<b>Bedroom 4</b>	<b>12.5 x 12</b>
<b>Bonus</b>	<b>15.5 x 12</b>
<b>Loft</b>	<b>20.5 x 16 x irr</b>

The room measurements are interior wall to interior wall and rounded to the nearest 0.5 foot.

Signature \_\_\_\_\_  
Name Charles Skalet  
Date Signed \_\_\_\_\_  
State Certification # CR-2399 State TN  
Or State License # \_\_\_\_\_ State \_\_\_\_\_

Signature \_\_\_\_\_  
Name \_\_\_\_\_  
Date Signed \_\_\_\_\_  
State Certification # \_\_\_\_\_ State \_\_\_\_\_  
Or State License # \_\_\_\_\_ State \_\_\_\_\_

## Building Sketch

Borrower	N/A				
Property Address	6700 Forest Village Way				
City	Knoxville	County	Knox	State	TN
Lender/Client	Lesli Fox				
				Zip Code	37919

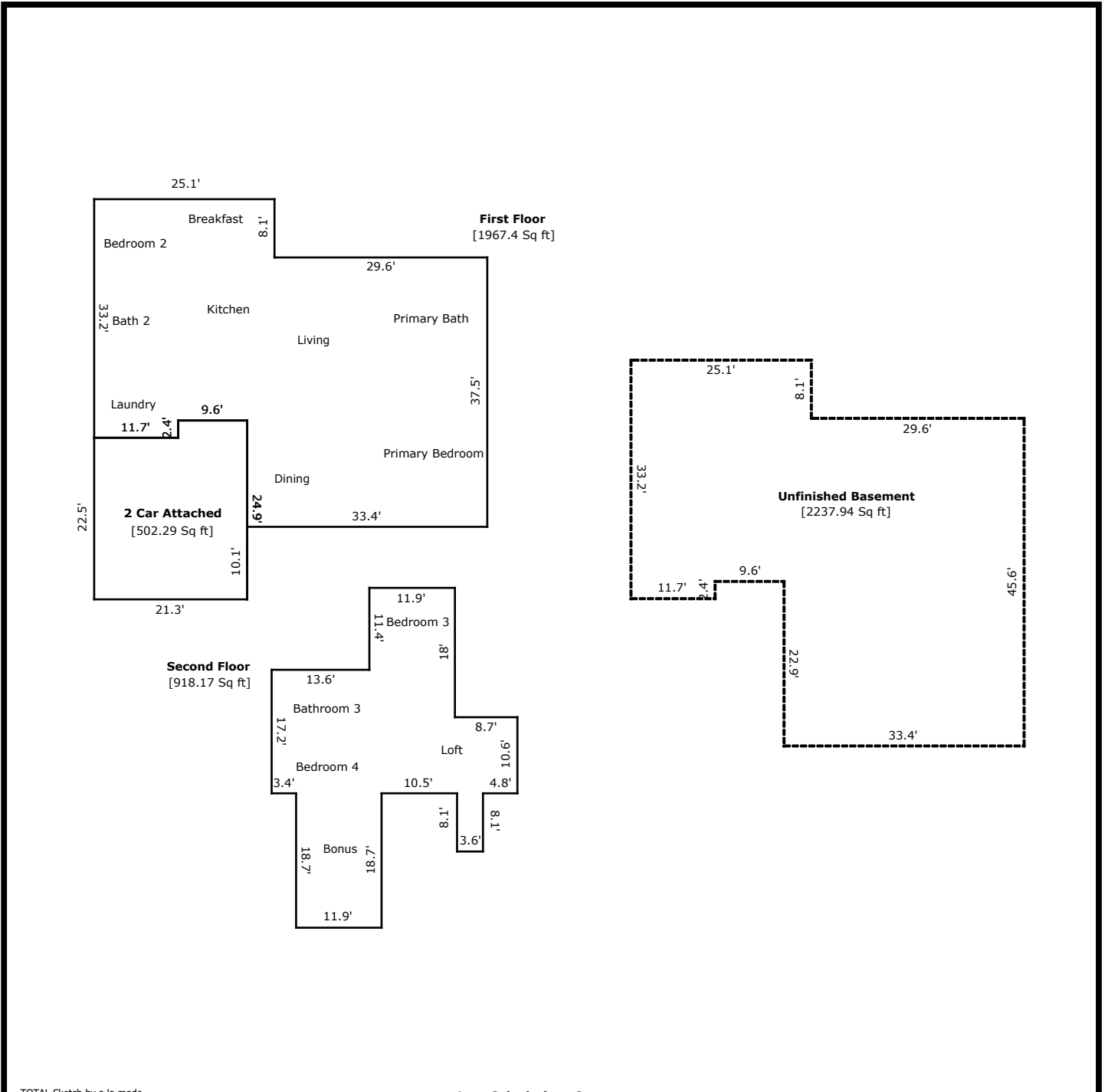

TOTAL Sketch by a la mode

### Area Calculations Summary

Living Area	Calculation Details	
First Floor	1967.4 Sq ft	$37.5 \times 29.6 = 1110$ $25.1 \times 30.8 = 773.08$ $14.8 \times 3.8 = 56.24$ $2.4 \times 11.7 = 28.08$
Second Floor	918.17 Sq ft	$11.9 \times 18.7 = 222.53$ $3.6 \times 8.1 = 29.16$ $11.9 \times 11.4 = 135.66$ $10.6 \times 8.7 = 92.22$ $17.2 \times 25.5 = 438.6$
<b>Total Living Area (Rounded):</b>		<b>2886 Sq ft</b>
Non-living Area		
2 Car Attached	502.29 Sq ft	$21.3 \times 22.5 = 479.25$ $2.4 \times 9.6 = 23.04$
Unfinished Basement	2237.94 Sq ft	$33.4 \times 22.9 = 764.86$ $22.7 \times 29.6 = 671.92$ $25.1 \times 30.8 = 773.08$ $2.4 \times 11.7 = 28.08$