

# Building Sketch

Borrower/Client				
Property Address 3010 Brooksmill Lane				
City	Wingate	County	State NC	Zip Code 28174
Lender				

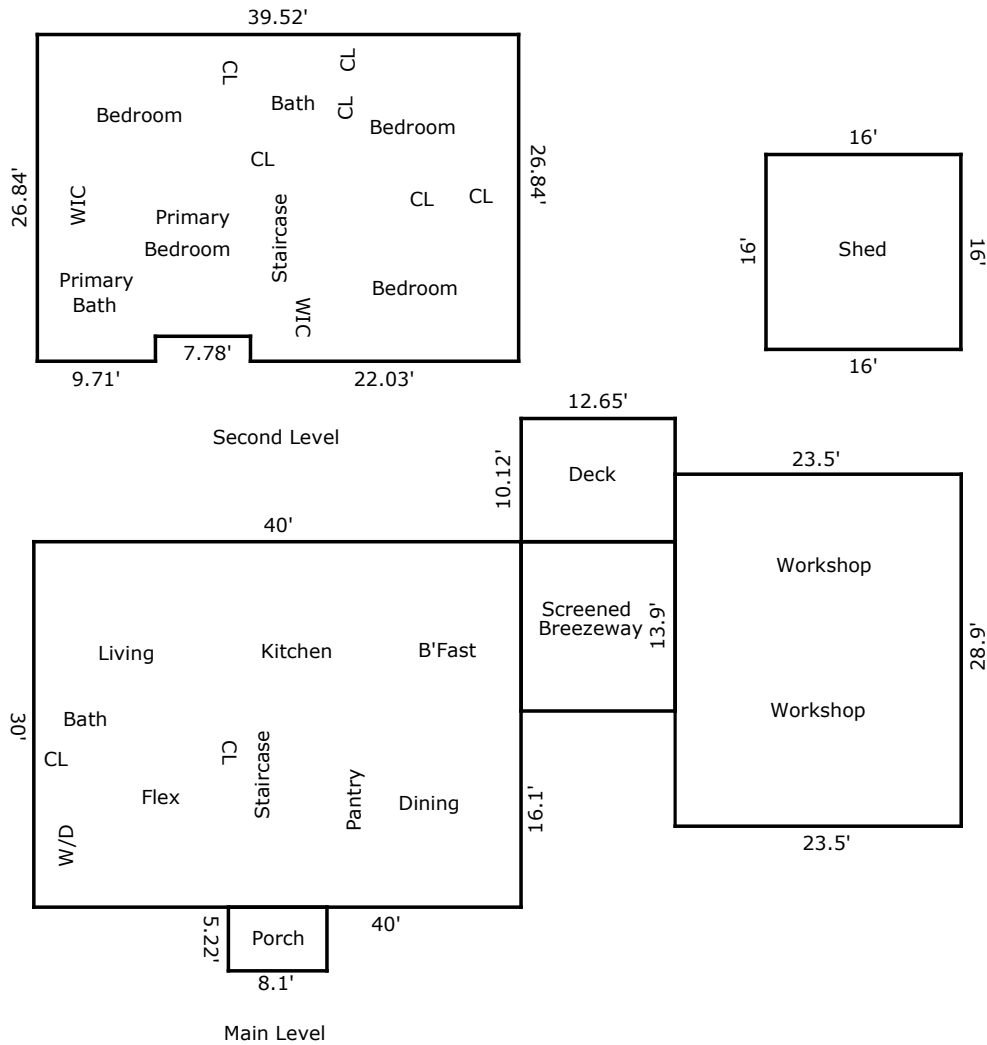

TOTAL Sketch by a la mode

### Area Calculations Summary

<b>Living Area</b>	
Main Level	1200 Sq ft
Second Level	1044.69 Sq ft
<b>Total Living Area (Rounded):</b>	<b>2245 Sq ft</b>
<b>Non-living Area</b>	
Screened Porch	175.84 Sq ft
Porch	42.28 Sq ft
Shed	256 Sq ft
Deck	128.02 Sq ft
Workshop	679.15 Sq ft