

# Home report

**E Lufkin Ave 2420**  
Lufkin

## Highlights



**1 Kitchen**



**1 Living room**



**4 Bedroom**



**3 Bath**



**26 Doors**



**17 Windows**

## Nearby services

Data source: Google Maps



**Lufkin, 5.6 km**



**Family Dollar, 3.5 km**



**Southland Rehabilitation  
& Healthcare Center, 2.0  
km**



**Kid's Konnection  
Preschool, 0.5 km**



**Pizza Pro, 1.5 km**



**Lacey Field, 3.4 km**

# Floor plan

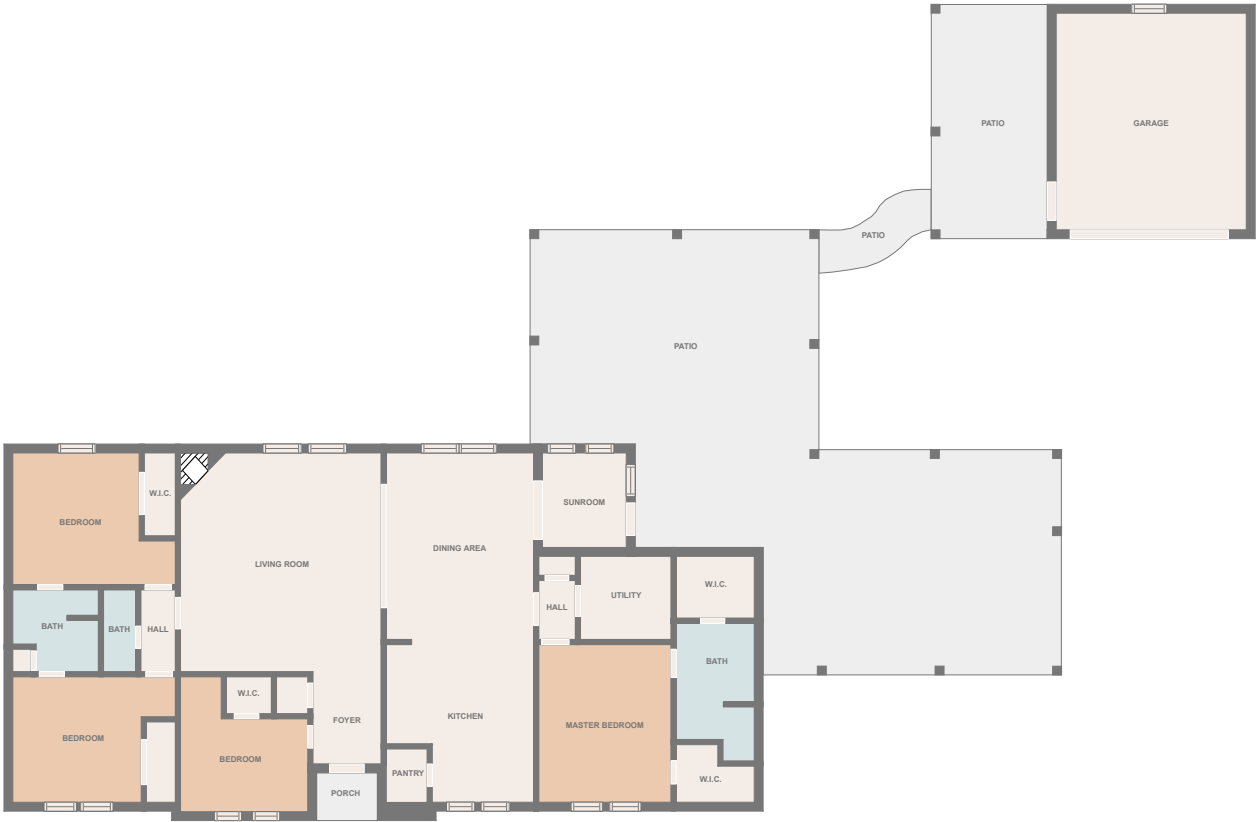

MEASUREMENTS ARE CALCULATED BY CUBICASA TECHNOLOGY. DEEMED HIGHLY RELIABLE BUT NOT GUARANTEED.

# Appendix 1: Data sheet

Closet - 4	Closet - WalkIn - 4	Hall - 2
Pantry - 1	Bath - 3	Bath - Toilet - 1
Utility - 1	Bedroom - 4	Bedroom - Master - 1
Outdoor - 4	Outdoor - Patio - 3	Outdoor - Porch - 1
Garage - 1	LivingRoom - 1	Entry - 1
Entry - Foyer - 1	Room - 1	Room - Glass - 1
Dining - 1	Dining - Open - 1	Kitchen - 1