

# 126 Bay Street Osterville

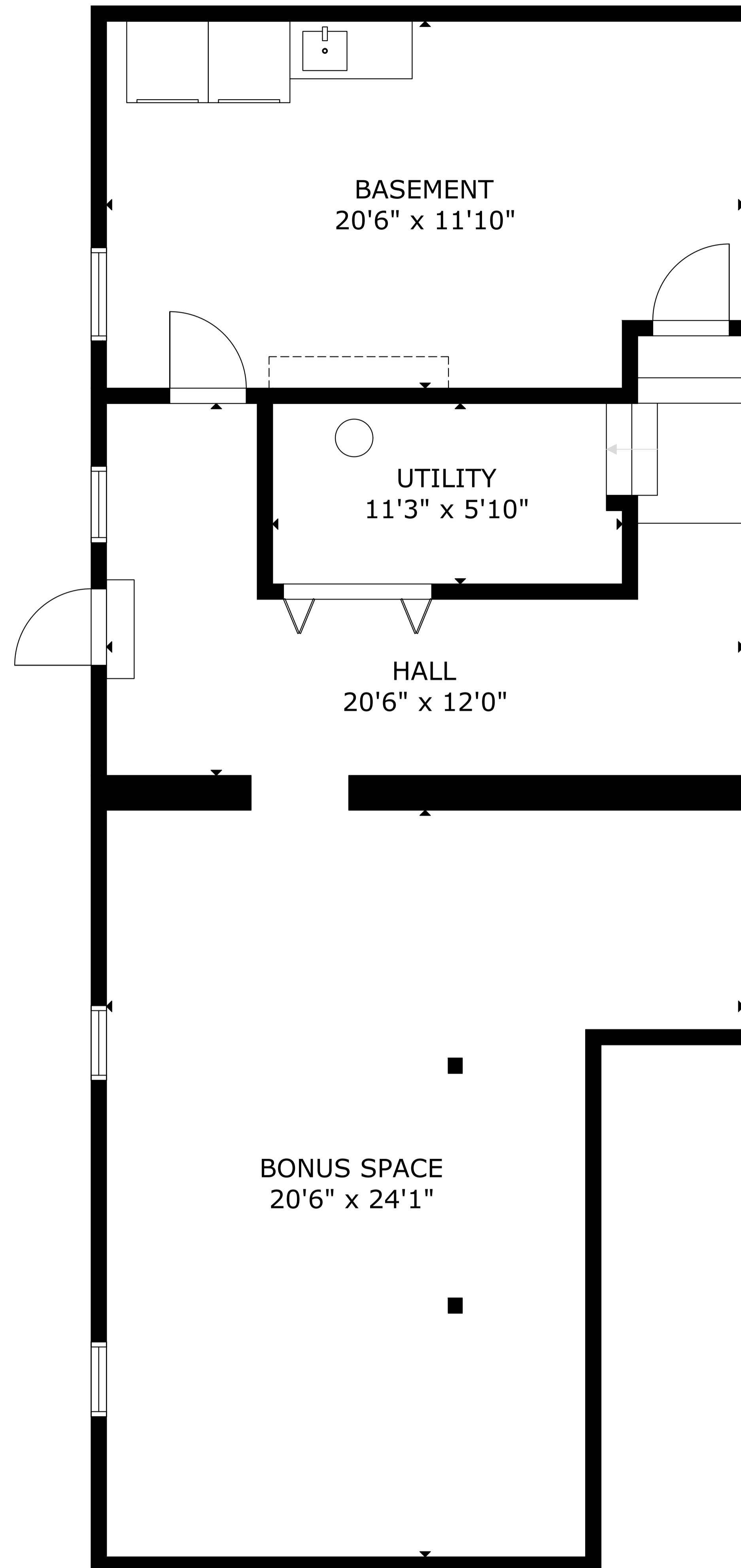

BONUS SPACE  
20'6" x 24'1"

BASEMENT  
20'6" x 11'10"

UTILITY  
11'3" x 5'10"

HALL  
20'6" x 12'0"

GROSS INTERNAL AREA  
TOTAL: 2,172 sq ft

FLOOR 1: 928 sq ft, FLOOR 2: 1,244 sq ft

SIZE AND DIMENSIONS ARE APPROXIMATE, ACTUAL MAY VARY



**AERIAL ADVANTAGE**  
VIDEO | PHOTOGRAPHY

www.aerialadvantagecapecod.com  
508-419-6149