

Building Sketch

Borrower				
Property Address 601 Arrowhead Pass				
City	Wimberley	County	Hays	State TX Zip Code 78676-6348
Lender/Client Bank of America				

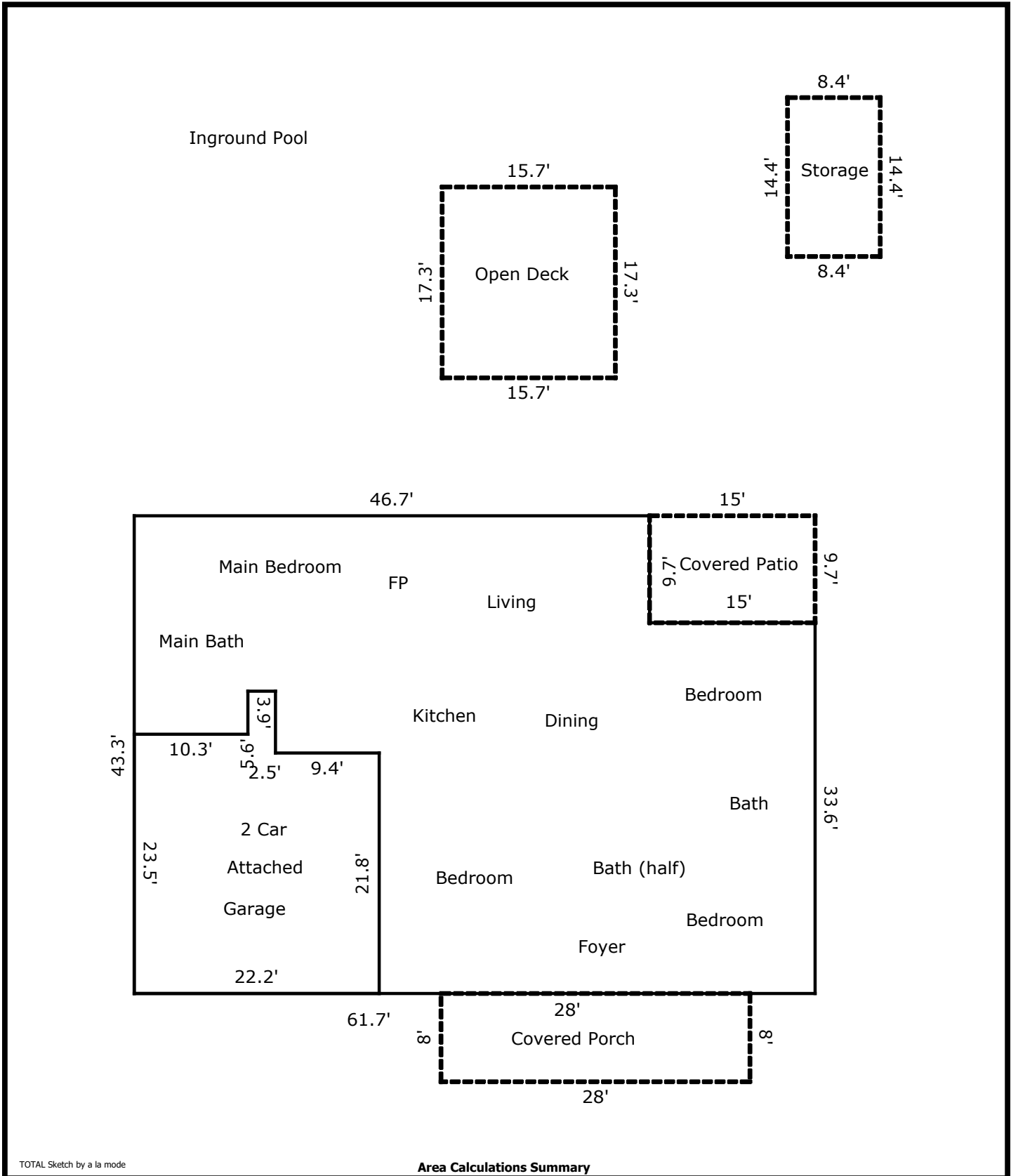

TOTAL Sketch by a la mode

Area Calculations Summary

Living Area	Calculation Details	
2 Car Attached	-515.47 Sq ft	22.2 x 21.8 = 483.96 2.5 x 3.9 = 9.75 1.7 x 12.8 = 21.76
First Floor	2526.11 Sq ft	43.3 x 46.7 = 2022.11 15 x 33.6 = 504
Total Living Area (Rounded):	2011 Sq ft	
Non-living Area		
Storage	120.96 Sq ft	14.4 x 8.4 = 120.96