



Measurement Report

Measurement Date	January 16, 2025
Client Name	Stephen Lau - RE/MAX Real Estate
Property Address	9904 178 Ave NW, Edmonton, AB
Property Type	Duplex
Exterior Wall Thickness	6.5"
Measurement Equipment	Laser

Floor Area Totals

	Level	Metric (m ²)	Imperial (ft ²)
Main Floor	1	111.17	1196.59
Total Above Ground RMS Area		111.17	1196.59

Room Dimensions

	Level	Metric (m)	Imperial (ft)
Living Room	1	3.78 x 4.55	12'5" x 14'11"
Dining Room	1	2.58 x 4.49	8'6" x 14'9"
Kitchen	1	3.50 x 2.68	11'6" x 8'10"
Laundry Room	1	2.44 x 1.48	8'0" x 4'10"
Primary Bedroom	1	5.60 x 3.49	18'4" x 11'5"
Bedroom 2	1	3.44 x 2.84	11'3" x 9'4"
Garage Door		4.88 x 2.13	16'0" x 6'12"
Garage		6.47 x 5.57	21'3" x 18'3"

Bathroom Count

	Level	Pieces
Bathroom 1	1	4
Bathroom 2	1	3

Measuring Process

Measurements have been completed and verified using the RMS guidelines. Measurements were obtained using lasers for the interior areas.

Room dimensions are largest length and width; parts of room may be smaller. Room area is not always equal to product of length and width.

9904 178 AVE NW
EDMONTON, AB

EXTERIOR WALL THICKNESS: 6.5"

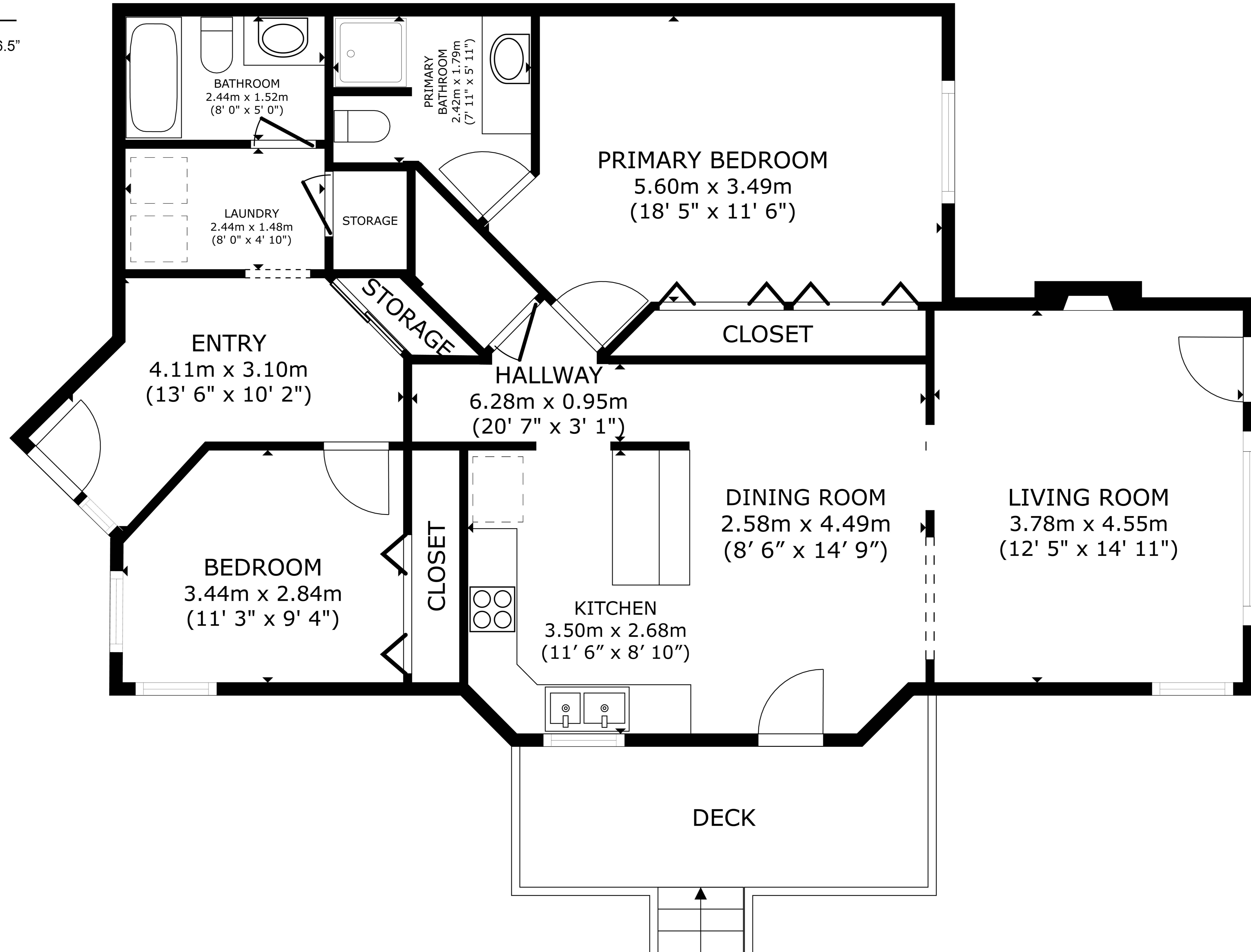

MAIN FLOOR
111.17 m²(1197 sq ft)

The floorplans and measurements are approximate within +/- 2% and are used for advertising usage only
May include unfinished area. Not suitable for architectural or construction use.

Schematics

