

1016 River Bark Place, Carpenter, Cary, Wake County, North Carolina, United States, 27519

Gross Living Area: 2455 sq. ft

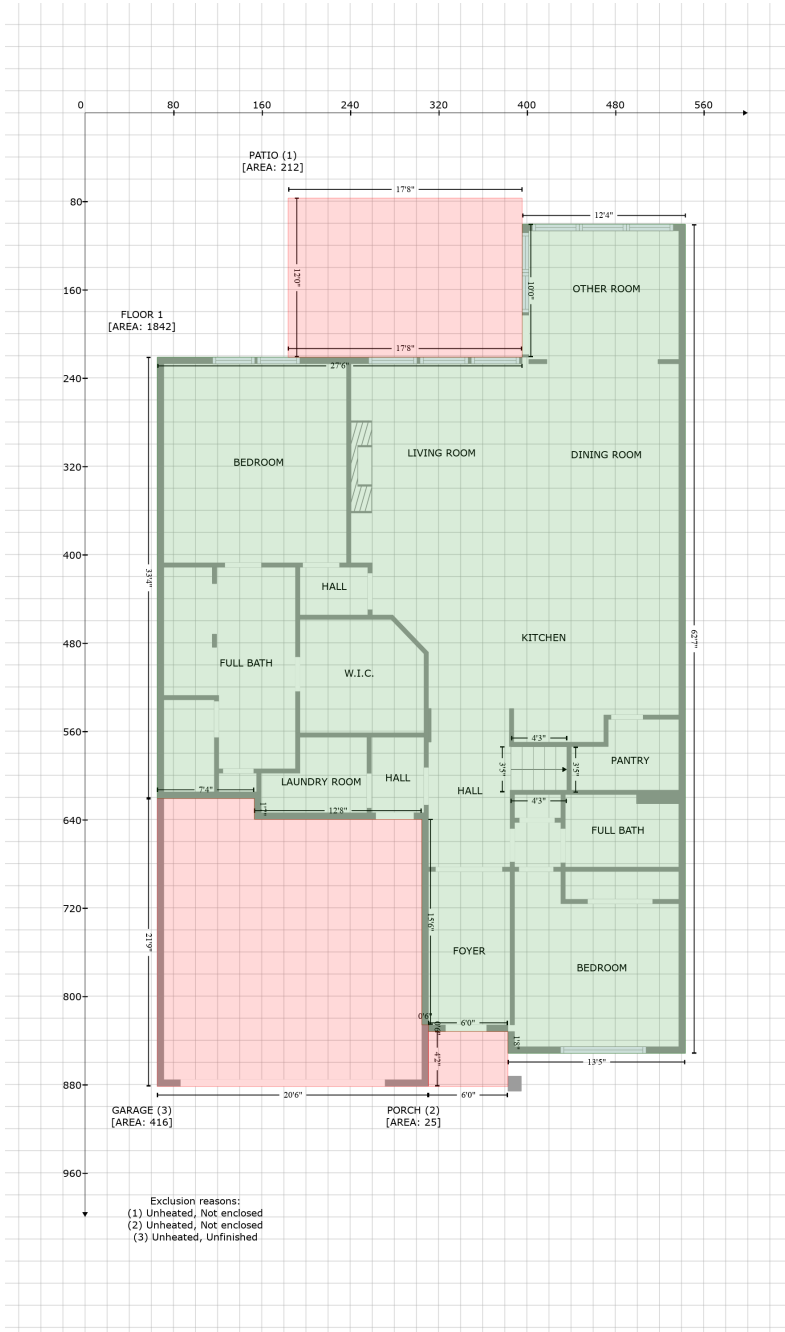

Space	Area (sq. ft)	Calculation
FLOOR 1 (Living area)	1842	Coordinate Polygon Area Algorithm using inches $-((543.6 + 543.6) * (100.9 - 851.8) + (543.6 + 382.9) * (851.8 - 851.8) + (382.9 + 382.8) * (851.8 - 832) + (382.8 + 310.9) * (832 - 832) + (310.9 + 310.9) * (832 - 826) + (310.9 + 304.9) * (826 - 826) + (304.9 + 304.9) * (826 - 639.9) + (304.9 + 153.3) * (639.9 - 639.9) + (153.3 + 153.3) * (639.9 - 621) + (153.3 + 65.3) * (621 - 621) + (65.3 + 65.3) * (621 - 221.3) + (65.3 + 183.8) * (221.3 - 221.3) + (183.8 + 183.8) * (221.3 - 221.4) + (183.8 + 395.7) * (221.4 - 221.3) + (395.7 + 395.7) * (221.3 - 100.9) + (395.7 + 543.6) * (100.9 - 100.9)) * 0.5 * 0.00694$

1016 River Bark Place, Carpenter, Cary, Wake County, North Carolina, United States, 27519

Gross Living Area: 2455 sq. ft

Space	Area (sq. ft)	Calculation <small>Coordinate Polygon Area Algorithm using inches</small>
PATIO (Non-living area)	212	$-((395.7 + 395.7) * (77.2 - 221.3) + (395.7 + 183.8) * (221.3 - 221.4) + (183.8 + 183.8) * (221.4 - 77.2) + (183.8 + 395.7) * (77.2 - 77.2)) * 0.5 * 0.00694$
PORCH (Non-living area)	25	$-((382.8 + 382.9) * (832 - 881.7) + (382.9 + 310.9) * (881.7 - 881.7) + (310.9 + 310.9) * (881.7 - 832) + (310.9 + 382.8) * (832 - 832)) * 0.5 * 0.00694$
GARAGE (Non-living area)	416	$-((153.3 + 153.3) * (621 - 639.9) + (153.3 + 304.9) * (639.9 - 639.9) + (304.9 + 304.9) * (639.9 - 826) + (304.9 + 310.9) * (826 - 826) + (310.9 + 310.9) * (826 - 881.7) + (310.9 + 65.3) * (881.7 - 881.7) + (65.3 + 65.3) * (881.7 - 621) + (65.3 + 153.3) * (621 - 621)) * 0.5 * 0.00694$

1016 River Bark Place, Carpenter, Cary, Wake County, North Carolina, United States, 27519

Gross Living Area: 2455 sq. ft



Space	Area (sq. ft)	Calculation <small>Coordinate Polygon Area Algorithm using inches</small>
FLOOR 2 (Living area)	613	$-\left((443.6 + 443.6) * (174.9 - 273.9) + (443.6 + 364.8) * (273.9 - 273.9) + (364.8 + 364.8) * (273.9 - 421.1) + (364.8 + 288.8) * (421.1 - 421.1) + (288.8 + 288.8) * (421.1 - 441.6) + (288.8 + 210.9) * (441.6 - 441.6) + (210.9 + 210.9) * (441.6 - 467.2) + (210.9 + 69.7) * (467.2 - 467.2) + (69.7 + 69.7) * (467.2 - 176.9) + (69.7 + 216.7) * (176.9 - 176.9) + (216.7 + 222.7) * (176.9 - 174.9) + (222.7 + 443.6) * (174.9 - 174.9)\right) * 0.5 * 0.00694$
UTILITY ROOM	111	$-\left((222.7 + 222.7) * (72.1 - 174.9) + (222.7 + 216.7) * (174.9 - 176.9) + (216.7 + 69.7) * (176.9 - 176.9) + (69.7 + 69.7) * (176.9 - 176.9)\right) * 0.5 * 0.00694$

1016 River Bark Place, Carpenter, Cary, Wake County, North Carolina, United States, 27519

Gross Living Area: 2455 sq. ft

Space	Area (sq. ft)	Calculation <small>Coordinate Polygon Area Algorithm using inches</small>
(Non-living area)		$176.9 + (69.7 + 69.7) * (176.9 - 72.1) + (69.7 + 222.7) * (72.1 - 72.1) * 0.5 * 0.00694$