

Home report

4013 Tennessee Avenue NW,Roanoke,Virginia,United States



Total Area: 1075 sq. ft

Floor 1: 1075 sq. ft

Excluded: Porch 42 sq. ft, Deck 122 sq. ft, Walls: 76 sq. ft

Property summary

 **1** Floors

 **4** Bedrooms

 **2** Bathrooms

Home report

4013 Tennessee Avenue NW,Roanoke,Virginia,United States

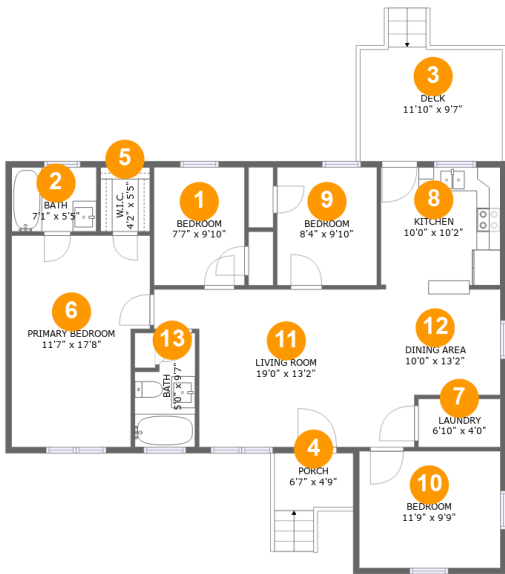

Room dimensions

Floor 1

Total:1075sqft

Excluded: 164sqft

#		Max Dimensions	sqft	Included
1	Bedroom	7'7" x 9'10"	75 sq. ft	Yes
2	Bath	7'1" x 5'5"	38 sq. ft	Yes
3	Deck	11'10" x 9'7"	122 sq. ft	No
4	Porch	6'7" x 4'9"	42 sq. ft	No
5	W.I.C.	4'2" x 5'5"	22 sq. ft	Yes
6	Primary Bedroom	11'7" x 17'8"	189 sq. ft	Yes
7	Laundry	6'10" x 4'0"	28 sq. ft	Yes
8	Kitchen	10'0" x 10'2"	101 sq. ft	Yes
9	Bedroom	8'4" x 9'10"	82 sq. ft	Yes
10	Bedroom	11'9" x 9'9"	115 sq. ft	Yes
11	Living Room	19'0" x 13'2"	213 sq. ft	Yes

Home report

4013 Tennessee Avenue NW,Roanoke,Virginia,United States

#		Max Dimensions	sqft	Included
12	Dining Area	10'0" x 13'2"	100 sq. ft	Yes
13	Bath	5'0" x 9'7"	42 sq. ft	Yes

1 Floor 1 - Bedroom



Max Dimensions: 7'7" x 9'10"
Calculated Area: 75 sq. ft
Included: Yes

Heated: Yes
Finished: Yes
Enclosed: Yes
Contiguous: Yes
Permitted: Yes
Wet space: No
Addition: No
Conversion: No

2 Floor 1 - Bath



Max Dimensions: 7'1" x 5'5"
Calculated Area: 38 sq. ft
Included: Yes

Heated: Yes
Finished: Yes
Enclosed: Yes
Contiguous: Yes
Permitted: Yes
Wet space: Yes
Addition: No
Conversion: No

3 Floor 1 - Deck



Max Dimensions: 11'10" x 9'7"
Calculated Area: 122 sq. ft
Included: No

Heated: No
Finished: No
Enclosed: No
Contiguous: Yes
Permitted: Yes
Wet space: No
Addition: No
Conversion: No

4 Floor 1 - Porch



Max Dimensions: 6'7" x 4'9"
Calculated Area: 42 sq. ft
Included: No

Heated: No
Finished: No
Enclosed: No
Contiguous: Yes
Permitted: Yes
Wet space: No
Addition: No
Conversion: No

5 Floor 1 - W.I.C.



Max Dimensions: 4'2" x 5'5"
Calculated Area: 22 sq. ft
Included: Yes

Heated: Yes
Finished: Yes
Enclosed: Yes
Contiguous: Yes
Permitted: Yes
Wet space: No
Addition: No
Conversion: No

6 Floor 1 - Primary Bedroom



Max Dimensions: 11'7" x 17'8"
Calculated Area: 189 sq. ft
Included: Yes

Heated: Yes
Finished: Yes
Enclosed: Yes
Contiguous: Yes
Permitted: Yes
Wet space: No
Addition: No
Conversion: No

7 Floor 1 - Laundry



Max Dimensions: 6'10" x 4'0"
Calculated Area: 28 sq. ft
Included: Yes

Heated: Yes
Finished: Yes
Enclosed: Yes
Contiguous: Yes
Permitted: Yes
Wet space: No
Addition: No
Conversion: No

8 Floor 1 - Kitchen



Max Dimensions: 10'0" x 10'2"
Calculated Area: 101 sq. ft
Included: Yes

Heated: Yes
Finished: Yes
Enclosed: Yes
Contiguous: Yes
Permitted: Yes
Wet space: No
Addition: No
Conversion: No

9 Floor 1 - Bedroom



Max Dimensions: 8'4" x 9'10"
Calculated Area: 82 sq. ft
Included: Yes

Heated: Yes
Finished: Yes
Enclosed: Yes
Contiguous: Yes
Permitted: Yes
Wet space: No
Addition: No
Conversion: No

10 Floor 1 - Bedroom



Max Dimensions: 11'9" x 9'9"
Calculated Area: 115 sq. ft
Included: Yes

Heated: Yes
Finished: Yes
Enclosed: Yes
Contiguous: Yes
Permitted: Yes
Wet space: No
Addition: No
Conversion: No

11 Floor 1 - Living Room



Max Dimensions: 19'0" x 13'2"
Calculated Area: 213 sq. ft
Included: Yes

Heated: Yes
Finished: Yes
Enclosed: Yes
Contiguous: Yes
Permitted: Yes
Wet space: No
Addition: No
Conversion: No

12 Floor 1 - Dining Area



Max Dimensions: 10'0" x 13'2"
Calculated Area: 100 sq. ft
Included: Yes

Heated: Yes
Finished: Yes
Enclosed: Yes
Contiguous: Yes
Permitted: Yes
Wet space: No
Addition: No
Conversion: No

13 Floor 1 - Bath



Max Dimensions: 5'0" x 9'7"
Calculated Area: 42 sq. ft
Included: Yes

Heated: Yes
Finished: Yes
Enclosed: Yes
Contiguous: Yes
Permitted: Yes
Wet space: Yes
Addition: No
Conversion: No