

12966 115th Street North, Walsingham Heights, Largo, Pinellas County, Florida, United States, 33778

Gross Living Area: 1403 sq. ft

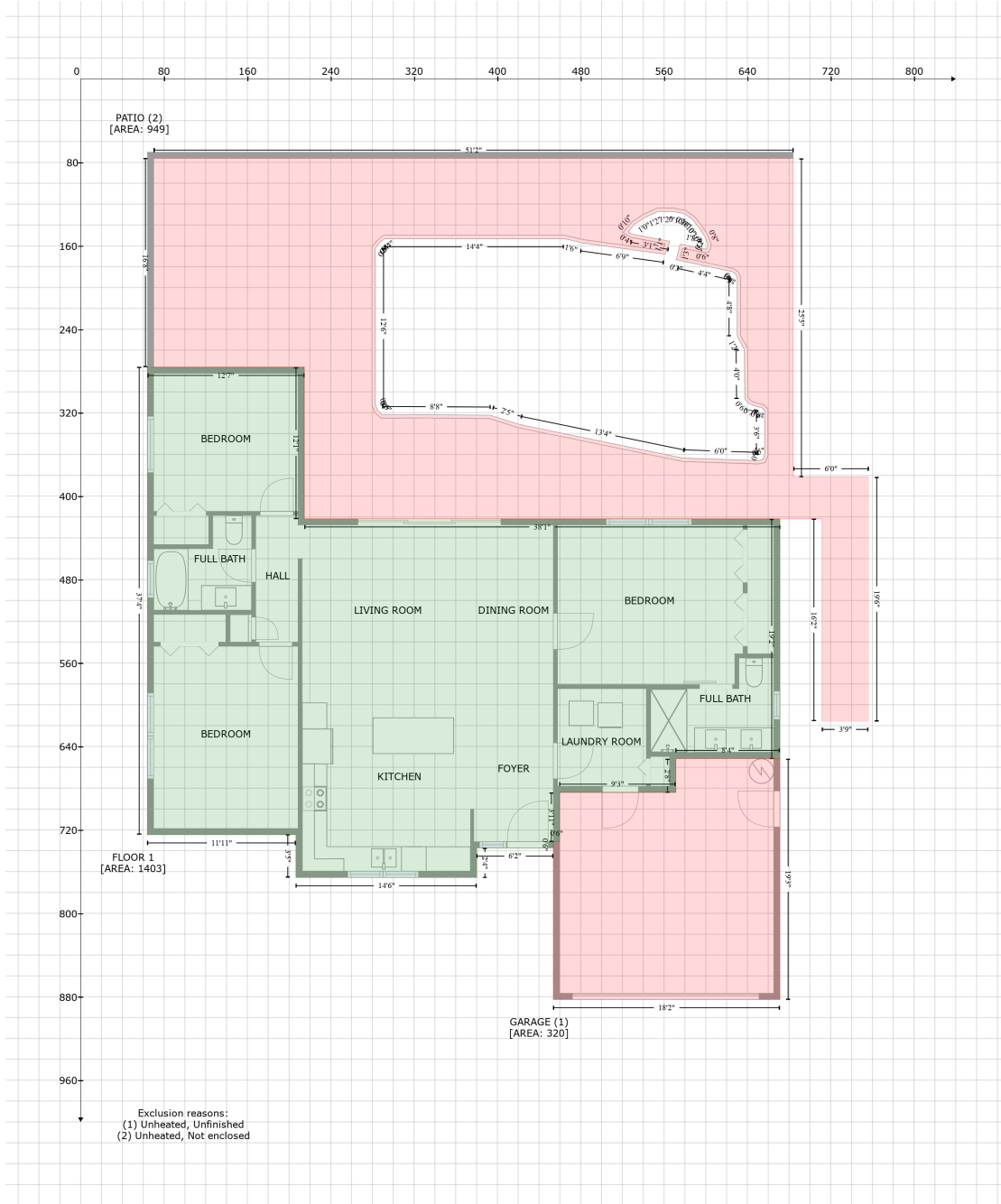

Space	Area (sq. ft)	Calculation
FLOOR 1 (Living area)	1403	Coordinate Polygon Area Algorithm using inches $-((214.6 + 214.6) * (276.4 - 421.7) + (214.6 + 671.2) * (421.7 - 421.8) + (671.2 + 671.2) * (421.8 - 651.7) + (671.2 + 571.2) * (651.7 - 651.7) + (571.2 + 571.2) * (651.7 - 684.1) + (571.2 + 459.7) * (684.1 - 684.1) + (459.7 + 459.7) * (684.1 - 731.3) + (459.7 + 453.7) * (731.3 - 731.3) + (453.7 + 453.7) * (731.3 - 737.3) + (453.7 + 380.2) * (737.3 - 737.3) + (380.2 + 380.2) * (737.3 - 765.7) + (380.2 + 206.6) * (765.7 - 765.7) + (206.6 + 206.6) * (765.7 - 724.7) + (206.6 + 64) * (724.7 - 724.7) + (64 + 64) * (724.7 - 276.4) + (64 + 214.6) * (276.4 - 276.4)) * 0.5 * 0.00694$

12966 115th Street North, Walsingham Heights, Largo, Pinellas County, Florida, United States, 33778

Gross Living Area: 1403 sq. ft

Space	Area (sq. ft)	Calculation <small>Coordinate Polygon Area Algorithm using inches</small>
GARAGE (Non-living area)	320	$-\left((671.2 + 671.2) * (651.7 - 882.6) + (671.2 + 453.7) * (882.6 - 882.6) + (453.7 + 453.7) * (882.6 - 731.3) + (453.7 + 459.7) * (731.3 - 731.3) + (459.7 + 459.7) * (731.3 - 684.1) + (459.7 + 571.2) * (684.1 - 684.1) + (571.2 + 571.2) * (684.1 - 651.7) + (571.2 + 671.2) * (651.7 - 651.7)\right) * 0.5 * 0.00694$
PATIO (Non-living area)	949	$-\left((684 + 684) * (76.1 - 381.6) + (684 + 756.3) * (381.6 - 381.6) + (756.3 + 756.3) * (381.6 - 615.8) + (756.3 + 711.7) * (615.8 - 615.8) + (711.7 + 711.7) * (615.8 - 421.8) + (711.7 + 214.6) * (421.8 - 421.7) + (214.6 + 214.6) * (421.7 - 276.4) + (214.6 + 70) * (276.4 - 276.4) + (70 + 70) * (276.4 - 76.1) + (70 + 684) * (76.1 - 76.1)\right) * 0.5 * 0.00694 + \left((554.6 + 542) * (127 - 132.8) + (542 + 531.8) * (132.8 - 139.2) + (531.8 + 525.5) * (139.2 - 146.5) + (525.5 + 529.2) * (146.5 - 148.8) + (529.2 + 565.6) * (148.8 - 155.7) + (565.6 + 560.9) * (155.7 - 168.1) + (560.9 + 481) * (168.1 - 157.1) + (481 + 463.9) * (157.1 - 153.1) + (463.9 + 292) * (153.1 - 153.1) + (292 + 289) * (153.1 - 155.3) + (289 + 285.7) * (155.3 - 158.3) + (285.7 + 282.9) * (158.3 - 162.2) + (282.9 + 282.9) * (162.2 - 312.1) + (282.9 + 285.1) * (312.1 - 317.8) + (285.1 + 289.4) * (317.8 - 321.9) + (289.4 + 393.2) * (321.9 - 322.5) + (393.2 + 421.1) * (322.5 - 331.2) + (421.1 + 578.1) * (331.2 - 363.5) + (578.1 + 649.9) * (363.5 - 365.9) + (649.9 + 654.8) * (365.9 - 364.8) + (654.8 + 656.5) * (364.8 - 360.3) + (656.5 + 656.5) * (360.3 - 317.9) + (656.5 + 654) * (317.9 - 315.2) + (654 + 648.3) * (315.2 - 313.9) + (648.3 + 641.8) * (313.9 - 311.4) + (641.8 + 637.5) * (311.4 - 306.8) + (637.5 + 637) * (306.8 - 259.2) + (637 + 630.3) * (259.2 - 246.9) + (630.3 + 630.3) * (246.9 - 190.7) + (630.3 + 628.5) * (190.7 - 186.9) + (628.5 + 625.5) * (186.9 - 184.8) + (625.5 + 574.8) * (184.8 - 174) + (574.8 + 571.6) * (174 - 173.3) + (571.6 + 575.5) * (173.3 - 158.4) + (575.5 + 594.9) * (158.4 - 162.6) + (594.9 + 600.6) * (162.6 - 163.3) + (600.6 + 601.8) * (163.3 - 161.2) + (601.8 + 601.8) * (161.2 - 157.7) + (601.8 + 598.8) * (157.7 - 150.6) + (598.8 + 593.4) * (150.6 - 142.4) + (593.4 + 586.9) * (142.4 - 134.2) + (586.9 + 578.9) * (134.2 - 129) + (578.9 + 569.1) * (129 - 127.2) + (569.1 + 554.6) * (127.2 - 127)\right) * 0.5 * 0.00694$