

705 Ponce De Leon Drive, Rio Vista, Fort Lauderdale, Broward County, Florida, United



Room Dimensions

Floor 1

Total sqft: 3259
Living area: 2075

#	Room name	Dimensions	Area (sqft)	Counted as Living Area
1	Patio	41'1" x 22'6"	472 sq. ft	No
2	Family Room	16'9" x 15'7"	261 sq. ft	Yes
3	Bath	11'4" x 11'11"	100 sq. ft	Yes
4	Foyer	8'9" x 16'0"	140 sq. ft	Yes
5	Dining Area	12'6" x 20'7"	247 sq. ft	Yes
6	Breakfast Nook	9'3" x 16'11"	154 sq. ft	Yes
7	Hall	12'0" x 15'10"	153 sq. ft	Yes
8	Laundry	7'10" x 11'8"	85 sq. ft	Yes
9	Covered Patio	40'7" x 12'3"	447 sq. ft	No
10	Garage	13'5" x 18'2"	245 sq. ft	No
11	W.i.c.	4'9" x 3'10"	23 sq. ft	Yes

705 Ponce De Leon Drive, Rio Vista, Fort Lauderdale, Broward County, Florida, United

#	Room name	Dimensions	Area (sqft)	Counted as Living Area
12	Swimming Pool	22'11" x 22'3"	377 sq. ft	No
13	Wc	5'5" x 9'10"	53 sq. ft	Yes
14	Kitchen	12'10" x 19'7"	240 sq. ft	Yes
15	Living Room	15'3" x 16'11"	266 sq. ft	Yes
16	Bedroom	13'7" x 20'5"	194 sq. ft	Yes

705 Ponce De Leon Drive, Rio Vista, Fort Lauderdale, Broward County, Florida, United

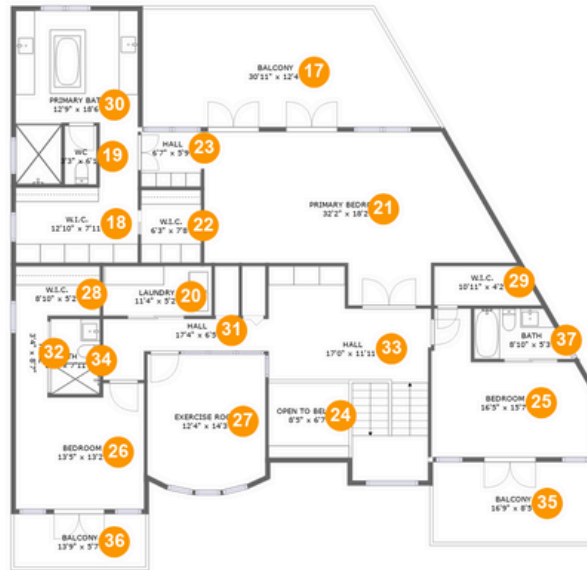

Room Dimensions

Floor 2

Total sqft: 2806

Living area: 2190

#	Room name	Dimensions	Area (sqft)	Counted as Living Area
17	Balcony	30'11" x 12'4"	342 sq. ft	No
18	W.i.c.	12'10" x 7'11"	101 sq. ft	Yes
19	Wc	3'3" x 6'1"	20 sq. ft	Yes
20	Laundry	11'4" x 5'2"	59 sq. ft	Yes
21	Primary Bedroom	32'2" x 18'2"	435 sq. ft	Yes
22	W.i.c.	6'3" x 7'8"	48 sq. ft	Yes
23	Hall	6'7" x 5'9"	37 sq. ft	Yes
24	Open To Below	8'5" x 6'7"	56 sq. ft	No
25	Bedroom	16'5" x 15'7"	186 sq. ft	Yes
26	Bedroom	13'5" x 13'2"	164 sq. ft	Yes
27	Exercise Room	12'4" x 14'3"	170 sq. ft	Yes

705 Ponce De Leon Drive, Rio Vista, Fort Lauderdale, Broward County, Florida, United

#	Room name	Dimensions	Area (sqft)	Counted as Living Area
28	W.i.c.	8'10" x 5'2"	46 sq. ft	Yes
29	W.i.c.	10'11" x 4'2"	42 sq. ft	Yes
30	Primary Bath	12'9" x 18'6"	209 sq. ft	Yes
31	Hall	17'4" x 6'5"	71 sq. ft	Yes
32	Hall	3'4" x 8'7"	29 sq. ft	Yes
33	Hall	17'0" x 11'11"	261 sq. ft	Yes
34	Bath	5'2" x 7'11"	41 sq. ft	Yes
35	Balcony	16'9" x 8'5"	141 sq. ft	No
36	Balcony	13'9" x 5'7"	77 sq. ft	No
37	Bath	8'10" x 5'3"	46 sq. ft	Yes

705 Ponce De Leon Drive, Rio Vista, Fort Lauderdale, Broward County, Florida, United

1 Floor 1 - Patio



Dimensions: 41'1" x 22'6"
Area: 472 sq. ft
Counted as Living Area: No

Heated: No
Finished: Yes
Enclosed: No
Contiguous: Yes
Permitted: Yes
Wet Space: No
Addition: No
Conversion: No

2 Floor 1 - Family Room



Dimensions: 16'9" x 15'7"
Area: 261 sq. ft
Counted as Living Area: Yes

Heated: Yes
Finished: Yes
Enclosed: Yes
Contiguous: Yes
Permitted: Yes
Wet Space: No
Addition: No
Conversion: No

705 Ponce De Leon Drive, Rio Vista, Fort Lauderdale, Broward County, Florida, United

3 Floor 1 - Bath



Dimensions: 11'4" x 11'11"
Area: 100 sq. ft
Counted as Living Area:
Yes

Heated: Yes
Finished: Yes
Enclosed: Yes
Contiguous:
Yes
Permitted: Yes
Wet Space: Yes
Addition: No
Conversion: No

4 Floor 1 - Foyer



Dimensions: 8'9" x 16'0"
Area: 140 sq. ft
Counted as Living Area:
Yes

Heated: Yes
Finished: Yes
Enclosed: Yes
Contiguous:
Yes Permitted:
Yes Wet Space:
No Addition:
No Conversion:
No

5 Floor 1 - Dining Area



Dimensions: 12'6" x 20'7"
Area: 247 sq. ft
Counted as Living Area:
Yes

Heated: Yes
Finished: Yes
Enclosed: Yes
Contiguous:
Yes Permitted:
Yes Wet Space:
No Addition:
No Conversion:
No

705 Ponce De Leon Drive, Rio Vista, Fort Lauderdale, Broward County, Florida, United

6 Floor 1 - Breakfast Nook



Dimensions: 9'3" x 16'11"
Area: 154 sq. ft
Counted as Living Area:
Yes

Heated: Yes
Finished: Yes
Enclosed: Yes
Contiguous:
Yes Permitted:
Yes Wet Space:
No Addition:
No Conversion:
No

7 Floor 1 - Hall



Dimensions: 12'0" x 15'10"
Area: 153 sq. ft
Counted as Living Area:
Yes

Heated: Yes
Finished: Yes
Enclosed: Yes
Contiguous:
Yes Permitted:
Yes Wet Space:
No Addition:
No Conversion:
No

8 Floor 1 - Laundry



Dimensions: 7'10" x 11'8"
Area: 85 sq. ft
Counted as Living Area:
Yes

Heated: Yes
Finished: Yes
Enclosed: Yes
Contiguous:
Yes Permitted:
Yes Wet Space:
No Addition:
No Conversion:
No

705 Ponce De Leon Drive, Rio Vista, Fort Lauderdale, Broward County, Florida, United

9 Floor 1 - Covered Patio



Dimensions: 40'7" x 12'3"
 Area: 447 sq. ft
 Counted as Living Area: No

Heated: No
 Finished: Yes
 Enclosed: No
 Contiguous: Yes
 Permitted: Yes
 Wet Space: No
 Addition: No
 Conversion: No

10 Floor 1 - Garage



Dimensions: 13'5" x 18'2"
 Area: 245 sq. ft
 Counted as Living Area: No

Heated: No
 Finished: No
 Enclosed: Yes
 Contiguous: Yes
 Permitted: Yes
 Wet Space: No
 Addition: No
 Conversion: No

11 Floor 1 - W.i.c.



Dimensions: 4'9" x 3'10"
 Area: 23 sq. ft
 Counted as Living Area: Yes

Heated: Yes
 Finished: Yes
 Enclosed: Yes
 Contiguous: Yes
 Permitted: Yes
 Wet Space: No
 Addition: No
 Conversion: No

705 Ponce De Leon Drive, Rio Vista, Fort Lauderdale, Broward County, Florida, United

12 Floor 1 - Swimming Pool



Dimensions: 22'11" x 22'3"
 Area: 377 sq. ft
 Counted as Living Area: No

Heated: No
 Finished: No
 Enclosed: No
 Contiguous: Yes
 Permitted: No
 Wet Space: No
 Addition: No
 Conversion: No

13 Floor 1 - Wc



Dimensions: 5'5" x 9'10"
 Area: 53 sq. ft
 Counted as Living Area: Yes

Heated: Yes
 Finished: Yes
 Enclosed: Yes
 Contiguous: Yes
 Permitted: Yes
 Wet Space: Yes
 Addition: No
 Conversion: No

14 Floor 1 - Kitchen



Dimensions: 12'10" x 19'7"
 Area: 240 sq. ft
 Counted as Living Area: Yes

Heated: Yes
 Finished: Yes
 Enclosed: Yes
 Contiguous: Yes
 Permitted: Yes
 Wet Space: No
 Addition: No
 Conversion: No

705 Ponce De Leon Drive, Rio Vista, Fort Lauderdale, Broward County, Florida, United

15 Floor 1 - Living Room



Dimensions: 15'3" x 16'11"
Area: 266 sq. ft
Counted as Living Area:
Yes

Heated: Yes
Finished: Yes
Enclosed: Yes
Contiguous:
Yes Permitted:
Yes Wet Space:
No Addition:
No Conversion:
No

16 Floor 1 - Bedroom



Dimensions: 13'7" x 20'5"
Area: 194 sq. ft
Counted as Living Area:
Yes

Heated: Yes
Finished: Yes
Enclosed: Yes
Contiguous:
Yes Permitted:
Yes Wet Space:
No Addition:
No Conversion:
No

17 Floor 2 - Balcony



Dimensions: 30'11" x 12'4"
Area: 342 sq. ft
Counted as Living Area: No

Heated: No
Finished: Yes
Enclosed: No
Contiguous: Yes
Permitted: Yes
Wet Space: No
Addition: No
Conversion: No

705 Ponce De Leon Drive, Rio Vista, Fort Lauderdale, Broward County, Florida, United

18 Floor 2 - W.i.c.



Dimensions: 12'10" x 7'11"
Area: 101 sq. ft
Counted as Living Area:
Yes

Heated: Yes
Finished: Yes
Enclosed: Yes
Contiguous:
Yes Permitted:
Yes Wet Space:
No Addition:
No Conversion:
No

19 Floor 2 - Wc



Dimensions: 3'3" x 6'1"
Area: 20 sq. ft
Counted as Living Area:
Yes

Heated: Yes
Finished: Yes
Enclosed: Yes
Contiguous:
Yes
Permitted: Yes
Wet Space: Yes
Addition: No
Conversion: No

20 Floor 2 - Laundry



Dimensions: 11'4" x 5'2"
Area: 59 sq. ft
Counted as Living Area:
Yes

Heated: Yes
Finished: Yes
Enclosed: Yes
Contiguous:
Yes Permitted:
Yes Wet Space:
No Addition:
No Conversion:
No

705 Ponce De Leon Drive, Rio Vista, Fort Lauderdale, Broward County, Florida, United

21 Floor 2 - Primary Bedroom



Dimensions: 32'2" x 18'2"
Area: 435 sq. ft
Counted as Living Area:
Yes

Heated: Yes
Finished: Yes
Enclosed: Yes
Contiguous:
Yes Permitted:
Yes Wet Space:
No Addition:
No Conversion:
No

22 Floor 2 - W.i.c.



Dimensions: 6'3" x 7'8"
Area: 48 sq. ft
Counted as Living Area:
Yes

Heated: Yes
Finished: Yes
Enclosed: Yes
Contiguous:
Yes Permitted:
Yes Wet Space:
No Addition:
No Conversion:
No

23 Floor 2 - Hall



Dimensions: 6'7" x 5'9"
Area: 37 sq. ft
Counted as Living Area:
Yes

Heated: Yes
Finished: Yes
Enclosed: Yes
Contiguous:
Yes Permitted:
Yes Wet Space:
No Addition:
No Conversion:
No

705 Ponce De Leon Drive, Rio Vista, Fort Lauderdale, Broward County, Florida, United

24 Floor 2 - Open To Below



Dimensions: 8'5" x 6'7"
Area: 56 sq. ft
Counted as Living Area: No

Heated: No
Finished: No
Enclosed: No
Contiguous: Yes
Permitted: No
Wet Space: No
Addition: No
Conversion: No

25 Floor 2 - Bedroom



Dimensions: 16'5" x 15'7"
Area: 186 sq. ft
Counted as Living Area: Yes

Heated: Yes
Finished: Yes
Enclosed: Yes
Contiguous: Yes
Permitted: Yes
Wet Space: No
Addition: No
Conversion: No

26 Floor 2 - Bedroom



Dimensions: 13'5" x 13'2"
Area: 164 sq. ft
Counted as Living Area: Yes

Heated: Yes
Finished: Yes
Enclosed: Yes
Contiguous: Yes
Permitted: Yes
Wet Space: No
Addition: No
Conversion: No

705 Ponce De Leon Drive, Rio Vista, Fort Lauderdale, Broward County, Florida, United

27 Floor 2 - Exercise Room



Dimensions: 12'4" x 14'3"
Area: 170 sq. ft
Counted as Living Area:
Yes

Heated: Yes
Finished: Yes
Enclosed: Yes
Contiguous:
Yes Permitted:
Yes Wet Space:
No Addition:
No Conversion:
No

28 Floor 2 - W.i.c.



Dimensions: 8'10" x 5'2"
Area: 46 sq. ft
Counted as Living Area:
Yes

Heated: Yes
Finished: Yes
Enclosed: Yes
Contiguous:
Yes Permitted:
Yes Wet Space:
No Addition:
No Conversion:
No

29 Floor 2 - W.i.c.



Dimensions: 10'11" x 4'2"
Area: 42 sq. ft
Counted as Living Area:
Yes

Heated: Yes
Finished: Yes
Enclosed: Yes
Contiguous:
Yes Permitted:
Yes Wet Space:
No Addition:
No Conversion:
No

705 Ponce De Leon Drive, Rio Vista, Fort Lauderdale, Broward County, Florida, United

30 Floor 2 - Primary Bath



Dimensions: 12'9" x 18'6"
Area: 209 sq. ft
Counted as Living Area:
Yes

Heated: Yes
Finished: Yes
Enclosed: Yes
Contiguous:
Yes
Permitted: Yes
Wet Space: Yes
Addition: No
Conversion: No

31 Floor 2 - Hall



Dimensions: 17'4" x 6'5"
Area: 71 sq. ft
Counted as Living Area:
Yes

Heated: Yes
Finished: Yes
Enclosed: Yes
Contiguous:
Yes Permitted:
Yes Wet Space:
No Addition:
No Conversion:
No

32 Floor 2 - Hall



Dimensions: 3'4" x 8'7"
Area: 29 sq. ft
Counted as Living Area:
Yes

Heated: Yes
Finished: Yes
Enclosed: Yes
Contiguous:
Yes Permitted:
Yes Wet Space:
No Addition:
No Conversion:
No

705 Ponce De Leon Drive, Rio Vista, Fort Lauderdale, Broward County, Florida, United

33 Floor 2 - Hall



Dimensions: 17'0" x 11'11"
Area: 261 sq. ft
Counted as Living Area:
Yes

Heated: Yes
Finished: Yes
Enclosed: Yes
Contiguous:
Yes Permitted:
Yes Wet Space:
No Addition:
No Conversion:
No

34 Floor 2 - Bath



Dimensions: 5'2" x 7'11"
Area: 41 sq. ft
Counted as Living Area:
Yes

Heated: Yes
Finished: Yes
Enclosed: Yes
Contiguous:
Yes
Permitted: Yes
Wet Space: Yes
Addition: No
Conversion: No

35 Floor 2 - Balcony



Dimensions: 16'9" x 8'5"
Area: 141 sq. ft
Counted as Living Area: No

Heated: No
Finished: Yes
Enclosed: No
Contiguous: Yes
Permitted: Yes
Wet Space: No
Addition: No
Conversion: No

705 Ponce De Leon Drive, Rio Vista, Fort Lauderdale, Broward County, Florida, United

36 Floor 2 - Balcony



Dimensions: 13'9" x 5'7"
Area: 77 sq. ft
Counted as Living Area: No

Heated: No
Finished: Yes
Enclosed: No
Contiguous: Yes
Permitted: Yes
Wet Space: No
Addition: No
Conversion: No

37 Floor 2 - Bath



Dimensions: 8'10" x 5'3"
Area: 46 sq. ft
Counted as Living Area: Yes

Heated: Yes
Finished: Yes
Enclosed: Yes
Contiguous: Yes
Permitted: Yes
Wet Space: Yes
Addition: No
Conversion: No