

# Building Sketch

Borrower/Client			
Property Address 9500 Hightower Oak Street			
City Huntersville	County	State NC	Zip Code 28078
Lender			

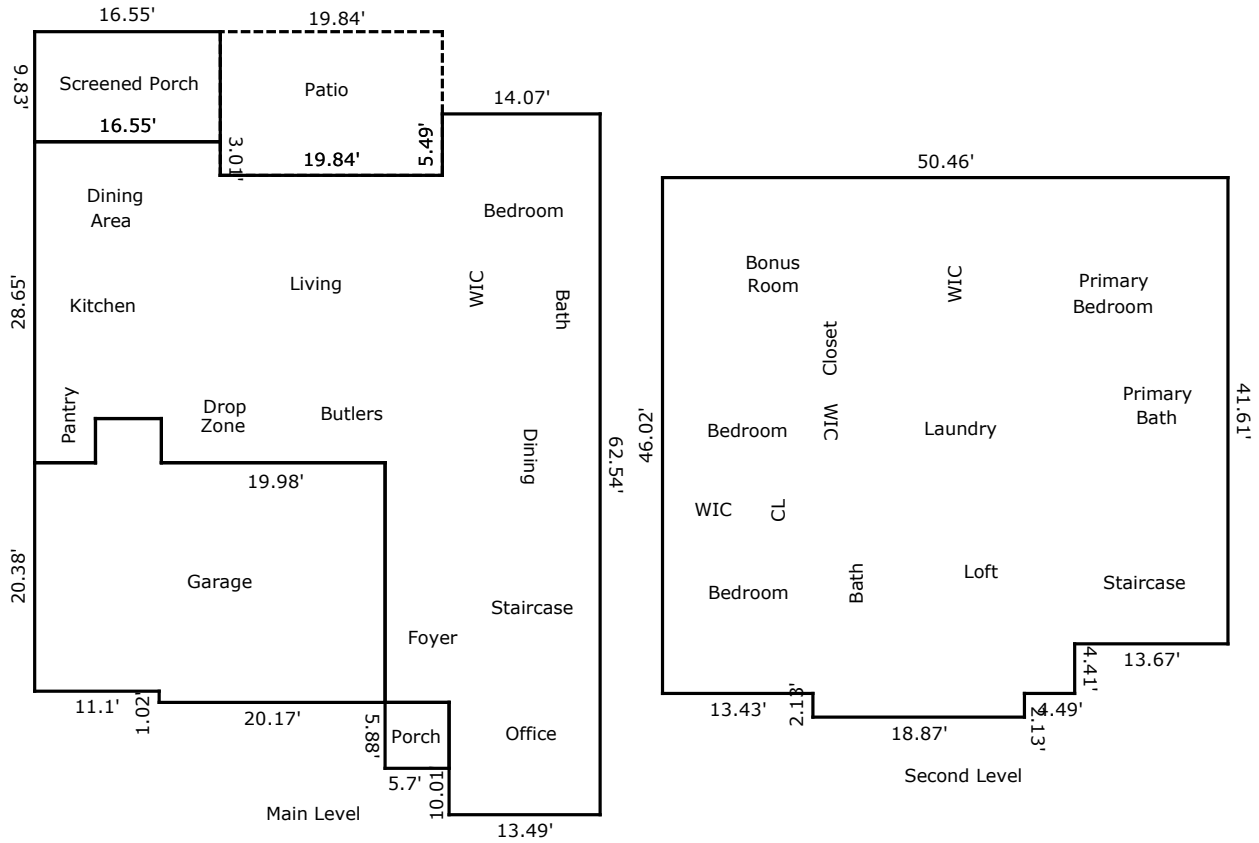

TOTAL Sketch by a la mode

### Area Calculations Summary

<b>Living Area</b>	
Main Level	1943.35 Sq ft
Second Level	2302.08 Sq ft
<b>Total Living Area (Rounded):</b>	<b>4245 Sq ft</b>
<b>Non-living Area</b>	
Screened Porch	162.69 Sq ft
Porch	33.52 Sq ft
Patio	254.75 Sq ft
Garage	681.06 Sq ft