

9935 Fuerte Drive, Casa de Oro-Mount Helix, La Mesa, San Diego County, California, United States, 88044

Gross Living Area: 2796 sq. ft

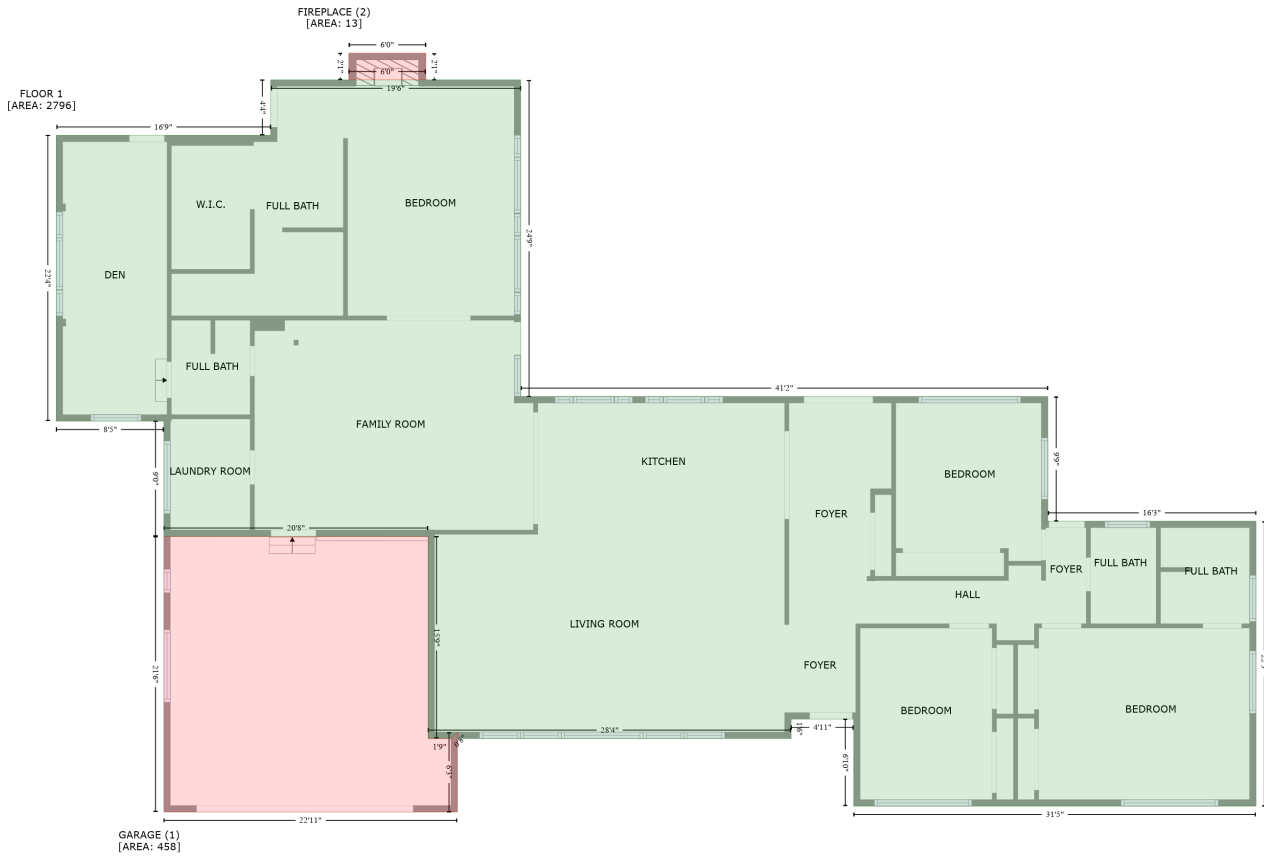

Space	Area (sq. ft)	Calculation
FLOOR 1 (Living area)	2796	Coordinate Polygon Area Algorithm using inches $-((437.5 + 437.5) * (20.8 - 317.6) + (437.5 + 932) * (317.6 - 317.6) + (932 + 932) * (317.6 - 434.6) + (932 + 1127.3) * (434.6 - 434.6) + (1127.3 + 1127.3) * (434.6 - 701.7) + (1127.3 + 749.9) * (701.7 - 701.7) + (749.9 + 749.9) * (701.7 - 620.1) + (749.9 + 691.2) * (620.1 - 620.1) + (691.2 + 691.2) * (620.1 - 638.3) + (691.2 + 378.2) * (638.3 - 638.3) + (378.2 + 378.2) * (632.3 - 638.3) + (372.2 + 350.7) * (638.3 - 638.3) + (350.7 + 350.7) * (638.3 - 448.8) + (350.7 + 102.9) * (448.8 - 448.8) + (102.9 + 102.9) * (448.8 - 340.6) + (102.9 + 1.9) * (340.6 - 340.6) + (1.9 + 1.9) * (340.6 - 72.7) + (1.9 + 203.1) * (72.7 - 72.7) + (203.1 + 203.1) * (72.7 - 20.8) + (203.1 + 437.5) * (20.8 - 20.8)) * 0.5 * 0.00694$
GARAGE (Non-living area)	458	$-((350.7 + 350.7) * (448.8 - 638.3) + (350.7 + 372.2) * (638.3 - 638.3) + (372.2 + 378.2) * (638.3 - 632.3) + (378.2 + 378.2) * (632.3 - 707.2) + (378.2 + 102.9) * (707.2 - 707.2) + (102.9 + 102.9) * (707.2 - 448.8) + (102.9 + 350.7) * (448.8 - 448.8)) * 0.5 * 0.00694$
FIREPLACE (Non-living area)	13	$-((348.6 + 348.6) * (-4.2 - 20.8) + (348.6 + 276.2) * (20.8 - 20.8) + (276.2 + 276.2) * (20.8 - -4.2) + (276.2 + 348.6) * (-4.2 - -4.2)) * 0.5 * 0.00694$