

Building Sketch

Borrower/Client				
Property Address 1112 Woodvale Ave				
City	Gastonia	County	State	NC
Lender		Zip Code 28054		

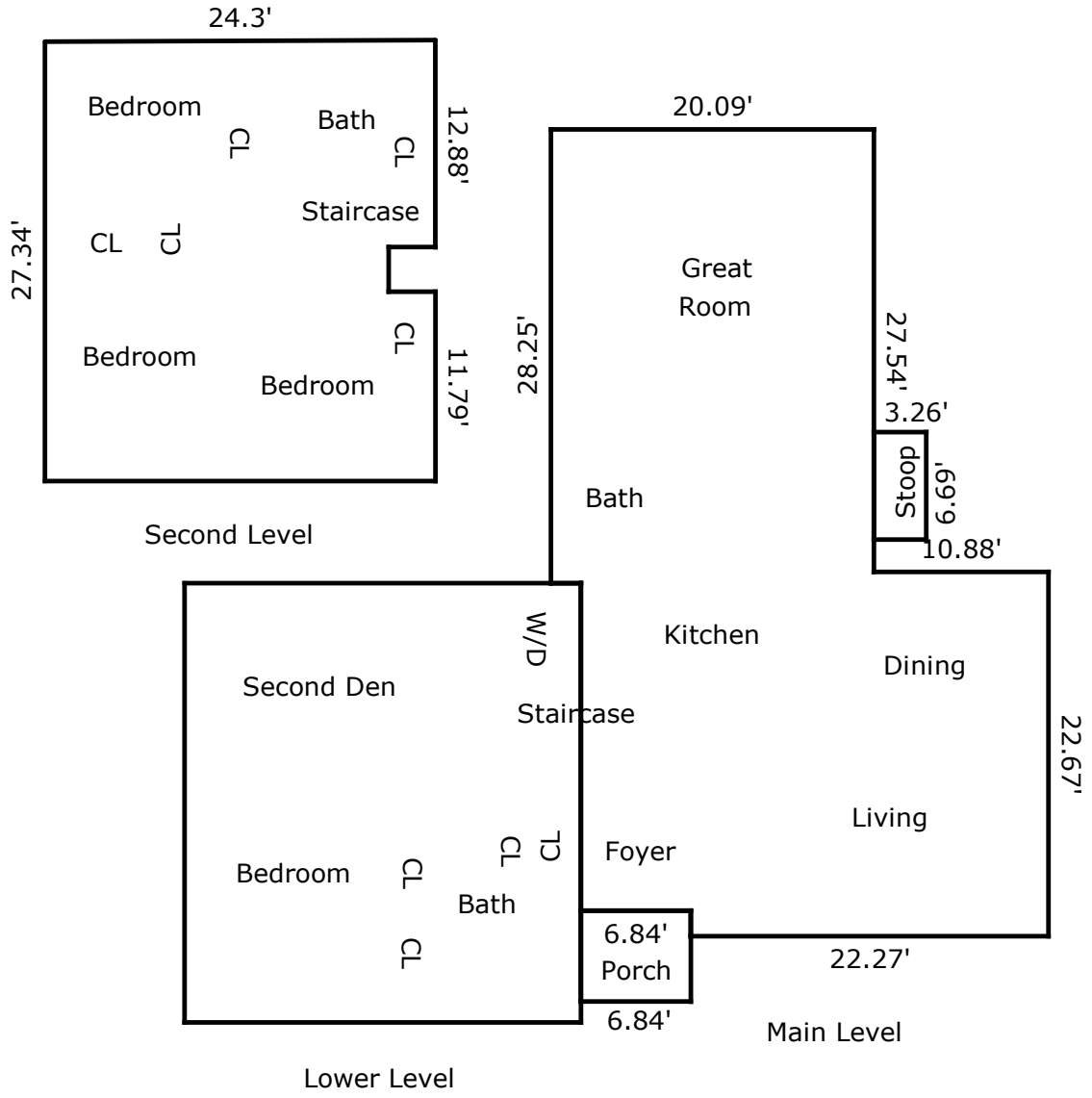

TOTAL Sketch by a la mode

Area Calculations Summary

Living Area	
Main Level	1203.72 Sq ft
Second Level	657.52 Sq ft
Below Grade	674.48 Sq ft
Total Living Area (Rounded):	2536 Sq ft
Non-living Area	
Porch	38.65 Sq ft
Undefined Area	21.81 Sq ft

Building Sketch

Borrower/Client

Property Address 1112 Woodvale Ave

City Gastonia

County

State NC

Zip Code 28054

Lender

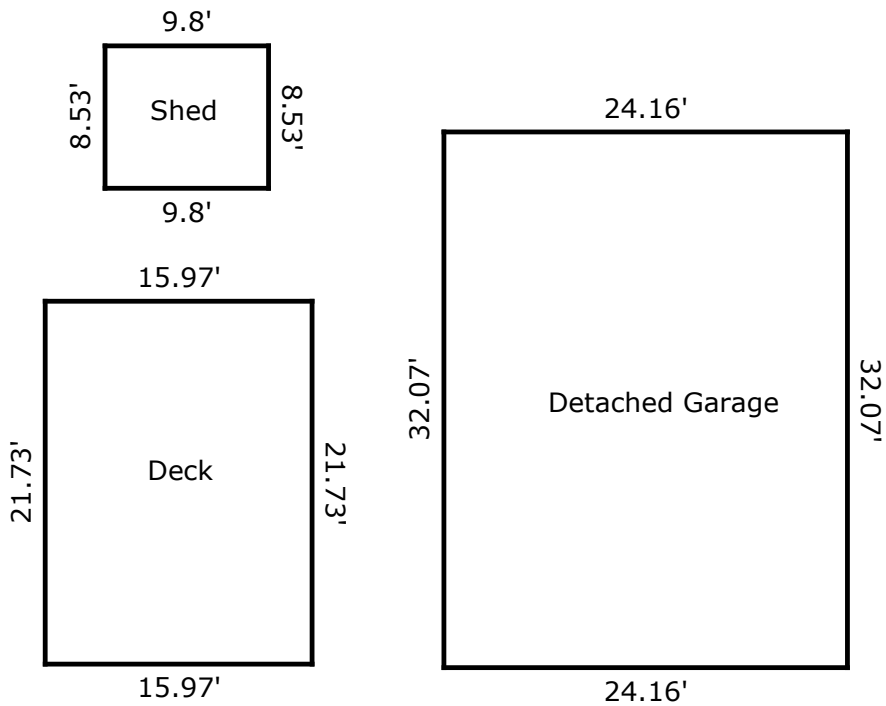

TOTAL Sketch by a la mode

Area Calculations Summary

Non-living Area

Shed	83.59 Sq ft
Detached Garage	774.81 Sq ft
Deck	347.03 Sq ft