

# Building Sketch

Borrower/Client			
Property Address 725 E Wade Street			
City	Wadesboro	County	State NC Zip Code 28170
Lender			

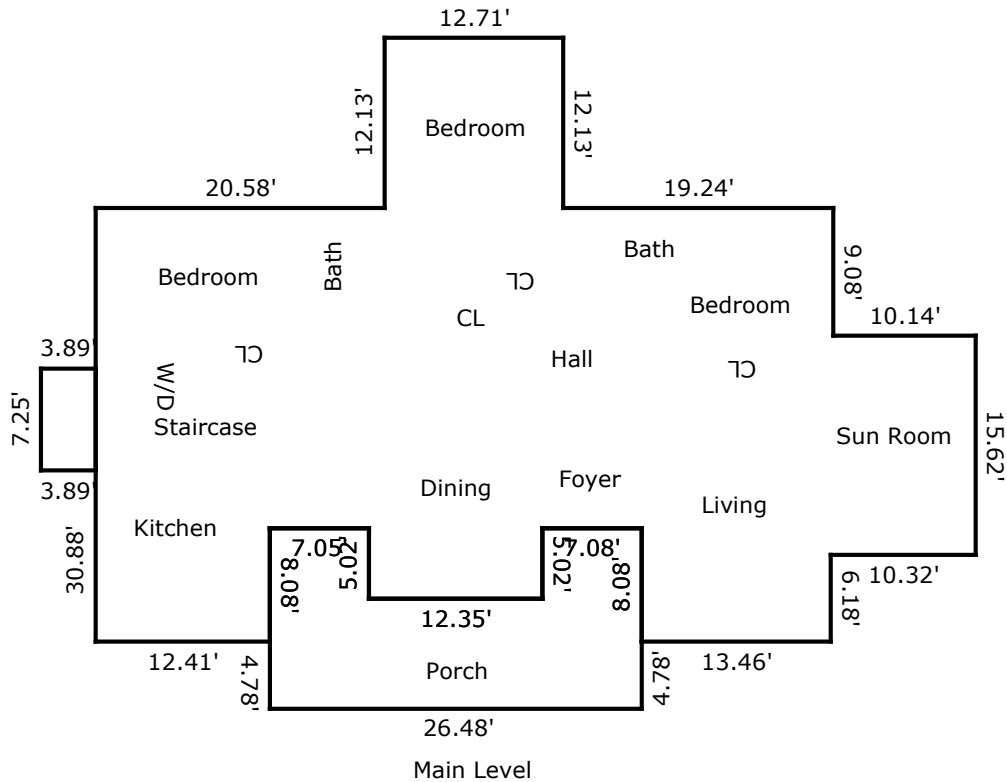
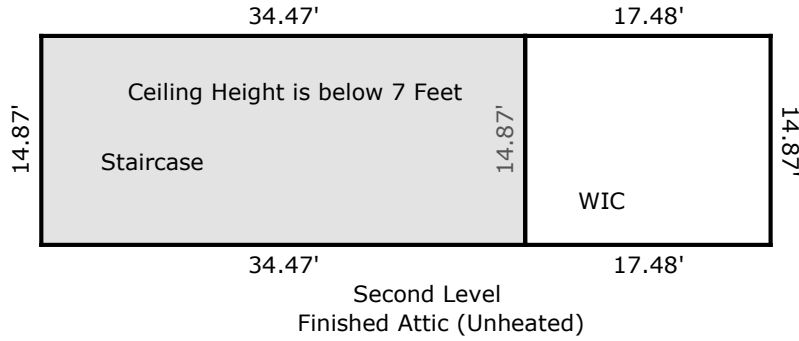

TOTAL Sketch by a la mode

### Area Calculations Summary

<b>Living Area</b>	
Main Level	1781.61 Sq ft
<b>Total Living Area (Rounded):</b>	<b>1782 Sq ft</b>
<b>Non-living Area</b>	
Porch	278.54 Sq ft
Enclosed Porch	28.22 Sq ft
Attic	259.93 Sq ft
Area Below 7 Feet	512.57 Sq ft