

Building Sketch

Borrower/Client			
Property Address			
City	County	State	Zip Code
Lender			

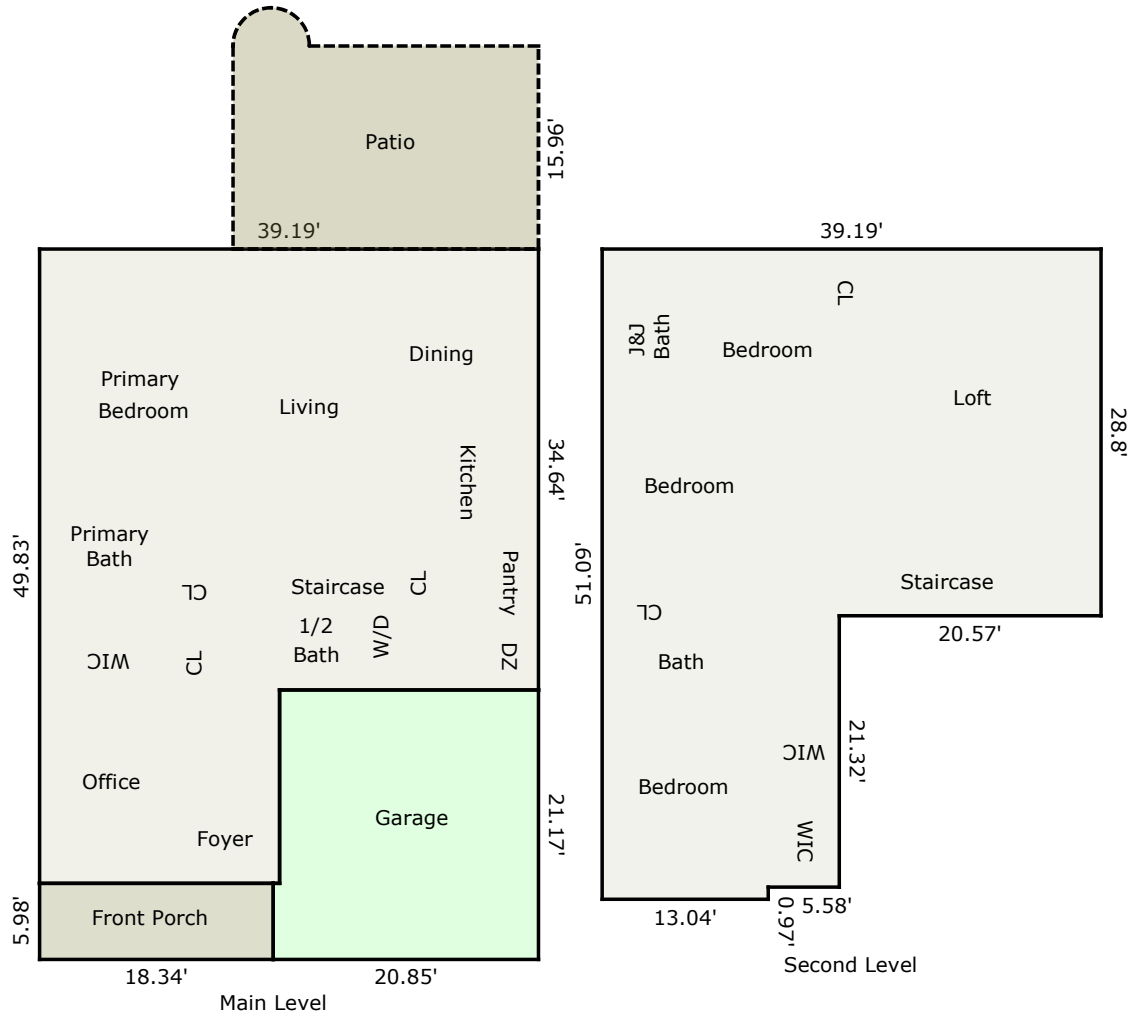

TOTAL Sketch by a la mode

Area Calculations Summary

Living Area	Calculation Details	
Main Living Area	1643.72 Sq ft	39.19 × 34.64 = 1357.54 15.19 × 18.84 = 286.18
Second Level	1538.3 Sq ft	39.19 × 28.8 = 1128.67 18.62 × 21.32 = 396.98 0.97 × 13.04 = 12.65
Total Living Area (Rounded):	3182 Sq ft	
Non-living Area		
Garage	433.8 Sq ft	21.17 × 20.35 = 430.81 0.5 × 5.98 = 2.99
Porch	109.67 Sq ft	5.98 × 18.34 = 109.67
Patio	397.18 Sq ft	24 × 15.96 = 383.04 Arc = 14.14