



599 Viewcrest Drive Northwest, Talus, Issaquah, King  
County, Washington, United States, 98027



Property summary

 **1** Garages

 **4** Bedrooms

 **3** Bathrooms

 **1** Half baths

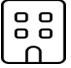
 **3** Floors

 **3,545** Gross living area sqft

 **4,852** Total sqft

599 Viewcrest Drive Northwest, Talus, Issaquah, King  
County, Washington, United States, 98027

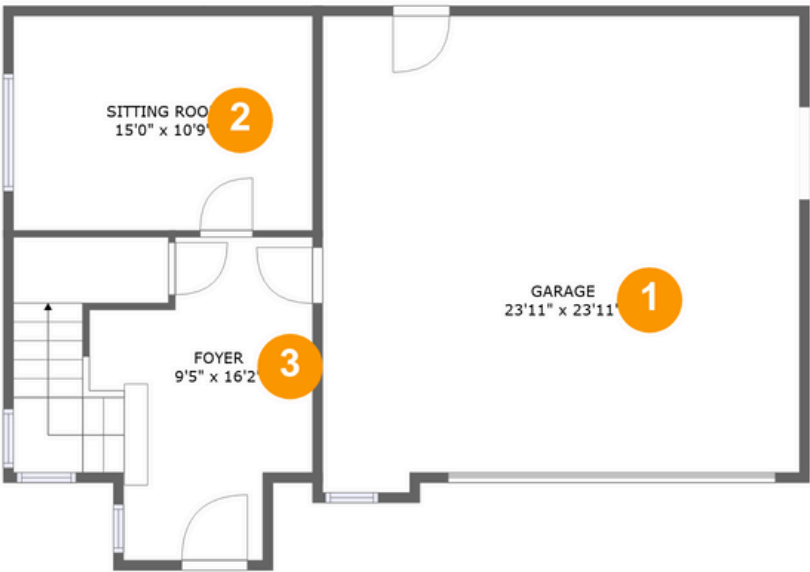

Room dimensions

Floor 1

Total sqft: 1007    Living area: 0

#		Dimensions	sqft	Counted as living area
1	Garage	23'11" x 23'11"	554 sq. ft	No
2	Sitting Room	15'0" x 10'9"	161 sq. ft	No
3	Foyer	9'5" x 16'2"	204 sq. ft	No

599 Viewcrest Drive Northwest, Talus, Issaquah, King  
 County, Washington, United States, 98027



## Room dimensions

Floor 2

Total sqft: 1909    Living area: 1761

#		Dimensions	sqft	Counted as living area
4	Kitchen	17'3" x 18'0"	286 sq. ft	Yes
5	Dining Area	13'3" x 11'5"	151 sq. ft	Yes
6	WC	7'3" x 5'4"	39 sq. ft	Yes
7	W.I.C.	5'0" x 7'5"	37 sq. ft	Yes
8	Hall	12'7" x 17'6"	341 sq. ft	Yes
9	Hall	4'2" x 14'0"	58 sq. ft	Yes
10	Living Room	17'5" x 17'6"	313 sq. ft	Yes
11	Hall	3'7" x 6'9"	24 sq. ft	Yes
12	Bedroom	13'2" x 13'0"	163 sq. ft	Yes
13	Balcony	18'11" x 3'5"	64 sq. ft	No
14	Open To Below	9'5" x 8'2"	70 sq. ft	No

Scan captured on Mon, 03 Mar 2025 23:06:21 GMT

Information is calculated by Cubicasa technology deemed highly reliable but not guaranteed.

# 599 Viewcrest Drive Northwest, Talus, Issaquah, King County, Washington, United States, 98027

#		Dimensions	sqft	Counted as living area
15	Bath	8'11" x 9'9"	81 sq. ft	Yes
16	Hall	15'4" x 4'9"	73 sq. ft	Yes

599 Viewcrest Drive Northwest, Talus, Issaquah, King  
 County, Washington, United States, 98027

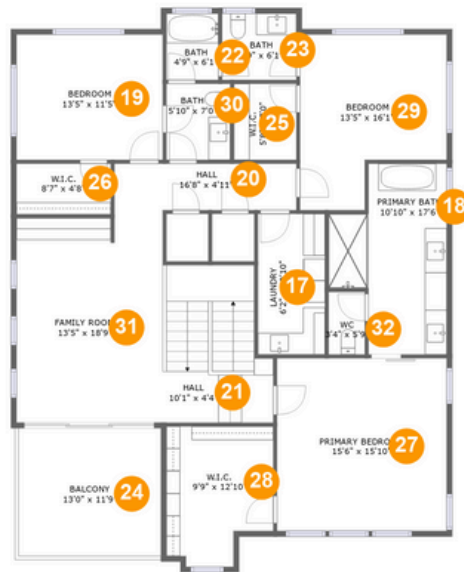

## Room dimensions

Floor 3

Total sqft: 1936    Living area: 1784

#		Dimensions	sqft	Counted as living area
17	Laundry	6'2" x 12'10"	79 sq. ft	Yes
18	Primary Bath	10'10" x 17'6"	150 sq. ft	Yes
19	Bedroom	13'5" x 11'5"	154 sq. ft	Yes
20	Hall	16'8" x 4'11"	74 sq. ft	Yes
21	Hall	10'1" x 4'4"	131 sq. ft	Yes
22	Bath	4'9" x 6'1"	29 sq. ft	Yes
23	Bath	6'9" x 6'1"	41 sq. ft	Yes
24	Balcony	13'0" x 11'9"	152 sq. ft	No
25	W.I.C.	5'8" x 7'0"	40 sq. ft	Yes
26	W.I.C.	8'7" x 4'8"	40 sq. ft	Yes
27	Primary Bedroom	15'6" x 15'10"	245 sq. ft	Yes

Scan captured on Mon, 03 Mar 2025 23:06:21 GMT

Information is calculated by Cubicasa technology deemed highly reliable but not guaranteed.

# 599 Viewcrest Drive Northwest, Talus, Issaquah, King County, Washington, United States, 98027

#		Dimensions	sqft	Counted as living area
28	W.I.C.	9'9" x 12'10"	112 sq. ft	Yes
29	Bedroom	13'5" x 16'1"	181 sq. ft	Yes
30	Bath	5'10" x 7'0"	41 sq. ft	Yes
31	Family Room	13'5" x 18'9"	250 sq. ft	Yes
32	WC	3'4" x 5'9"	19 sq. ft	Yes

599 Viewcrest Drive Northwest, Talus, Issaquah, King  
County, Washington, United States, 98027

1 Floor 1 - Garage

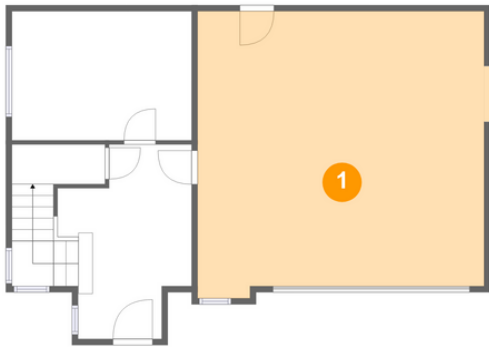

Dimensions: 23'11" x 23'11"  
Area: 554 sq. ft  
Counted as living area: No

Heated: No  
Finished: No  
Enclosed: Yes  
Contiguous: Yes  
Permitted: Yes  
Wet space: No  
Addition: No  
Conversion: No

2 Floor 1 - Sitting Room



Dimensions: 15'0" x 10'9"  
Area: 161 sq. ft  
Counted as living area: No

Heated: Yes  
Finished: Yes  
Enclosed: Yes  
Contiguous: No  
Permitted: Yes  
Wet space: No  
Addition: No  
Conversion: No

599 Viewcrest Drive Northwest, Talus, Issaquah, King  
County, Washington, United States, 98027

### 3 Floor 1 - Foyer

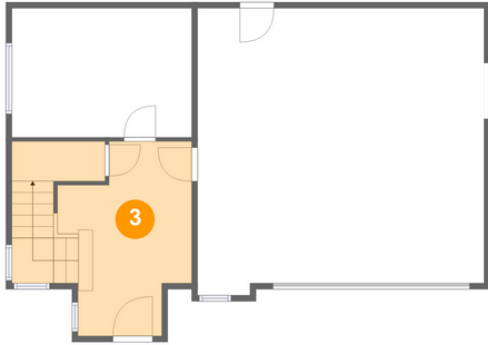

Dimensions: 9'5" x 16'2"  
Area: 204 sq. ft  
Counted as living area: No

Heated: Yes  
Finished: Yes  
Enclosed: Yes  
Contiguous: No  
Permitted: Yes  
Wet space: No  
Addition: No  
Conversion: No

### 4 Floor 2 - Kitchen



Dimensions: 17'3" x 18'0"  
Area: 286 sq. ft  
Counted as living area: Yes

Heated: Yes  
Finished: Yes  
Enclosed: Yes  
Contiguous: Yes  
Permitted: Yes  
Wet space: No  
Addition: No  
Conversion: No

### 5 Floor 2 - Dining Area



Dimensions: 13'3" x 11'5"  
Area: 151 sq. ft  
Counted as living area: Yes

Heated: Yes  
Finished: Yes  
Enclosed: Yes  
Contiguous: Yes  
Permitted: Yes  
Wet space: No  
Addition: No  
Conversion: No



599 Viewcrest Drive Northwest, Talus, Issaquah, King  
County, Washington, United States, 98027

## 6 Floor 2 - WC



Dimensions: 7'3" x 5'4"  
Area: 39 sq. ft  
Counted as living area: Yes

Heated: Yes  
Finished: Yes  
Enclosed: Yes  
Contiguous: Yes  
Permitted: Yes  
Wet space: Yes  
Addition: No  
Conversion: No

## 7 Floor 2 - W.I.C.



Dimensions: 5'0" x 7'5"  
Area: 37 sq. ft  
Counted as living area: Yes

Heated: Yes  
Finished: Yes  
Enclosed: Yes  
Contiguous: Yes  
Permitted: Yes  
Wet space: No  
Addition: No  
Conversion: No

## 8 Floor 2 - Hall



Dimensions: 12'7" x 17'6"  
Area: 341 sq. ft  
Counted as living area: Yes

Heated: Yes  
Finished: Yes  
Enclosed: Yes  
Contiguous: Yes  
Permitted: Yes  
Wet space: No  
Addition: No  
Conversion: No

599 Viewcrest Drive Northwest, Talus, Issaquah, King  
County, Washington, United States, 98027

### 9 Floor 2 - Hall



Dimensions: 4'2" x 14'0"  
Area: 58 sq. ft  
Counted as living area: Yes

Heated: Yes  
Finished: Yes  
Enclosed: Yes  
Contiguous: Yes  
Permitted: Yes  
Wet space: No  
Addition: No  
Conversion: No

### 10 Floor 2 - Living Room



Dimensions: 17'5" x 17'6"  
Area: 313 sq. ft  
Counted as living area: Yes

Heated: Yes  
Finished: Yes  
Enclosed: Yes  
Contiguous: Yes  
Permitted: Yes  
Wet space: No  
Addition: No  
Conversion: No

### 11 Floor 2 - Hall



Dimensions: 3'7" x 6'9"  
Area: 24 sq. ft  
Counted as living area: Yes

Heated: Yes  
Finished: Yes  
Enclosed: Yes  
Contiguous: Yes  
Permitted: Yes  
Wet space: No  
Addition: No  
Conversion: No

599 Viewcrest Drive Northwest, Talus, Issaquah, King  
County, Washington, United States, 98027

## 12 Floor 2 - Bedroom



Dimensions: 13'2" x 13'0"  
Area: 163 sq. ft  
Counted as living area: Yes

Heated: Yes  
Finished: Yes  
Enclosed: Yes  
Contiguous: Yes  
Permitted: Yes  
Wet space: No  
Addition: No  
Conversion: No

## 13 Floor 2 - Balcony



Dimensions: 18'11" x 3'5"  
Area: 64 sq. ft  
Counted as living area: No

Heated: No  
Finished: Yes  
Enclosed: No  
Contiguous: Yes  
Permitted: Yes  
Wet space: No  
Addition: No  
Conversion: No

## 14 Floor 2 - Open To Below



Dimensions: 9'5" x 8'2"  
Area: 70 sq. ft  
Counted as living area: No

Heated: No  
Finished: No  
Enclosed: No  
Contiguous: Yes  
Permitted: No  
Wet space: No  
Addition: No  
Conversion: No

599 Viewcrest Drive Northwest, Talus, Issaquah, King  
County, Washington, United States, 98027

### 15 Floor 2 - Bath



Dimensions: 8'11" x 9'9"  
Area: 81 sq. ft  
Counted as living area: Yes

Heated: Yes  
Finished: Yes  
Enclosed: Yes  
Contiguous: Yes  
Permitted: Yes  
Wet space: Yes  
Addition: No  
Conversion: No

### 16 Floor 2 - Hall



Dimensions: 15'4" x 4'9"  
Area: 73 sq. ft  
Counted as living area: Yes

Heated: Yes  
Finished: Yes  
Enclosed: Yes  
Contiguous: Yes  
Permitted: Yes  
Wet space: No  
Addition: No  
Conversion: No

### 17 Floor 3 - Laundry



Dimensions: 6'2" x 12'10"  
Area: 79 sq. ft  
Counted as living area: Yes

Heated: Yes  
Finished: Yes  
Enclosed: Yes  
Contiguous: Yes  
Permitted: Yes  
Wet space: No  
Addition: No  
Conversion: No

599 Viewcrest Drive Northwest, Talus, Issaquah, King  
County, Washington, United States, 98027

### 18 Floor 3 - Primary Bath



Dimensions: 10'10" x 17'6"  
Area: 150 sq. ft  
Counted as living area: Yes

Heated: Yes  
Finished: Yes  
Enclosed: Yes  
Contiguous: Yes  
Permitted: Yes  
Wet space: Yes  
Addition: No  
Conversion: No

### 19 Floor 3 - Bedroom



Dimensions: 13'5" x 11'5"  
Area: 154 sq. ft  
Counted as living area: Yes

Heated: Yes  
Finished: Yes  
Enclosed: Yes  
Contiguous: Yes  
Permitted: Yes  
Wet space: No  
Addition: No  
Conversion: No

### 20 Floor 3 - Hall



Dimensions: 16'8" x 4'11"  
Area: 74 sq. ft  
Counted as living area: Yes

Heated: Yes  
Finished: Yes  
Enclosed: Yes  
Contiguous: Yes  
Permitted: Yes  
Wet space: No  
Addition: No  
Conversion: No

599 Viewcrest Drive Northwest, Talus, Issaquah, King  
County, Washington, United States, 98027

### 21 Floor 3 - Hall



Dimensions: 10'1" x 4'4"  
Area: 131 sq. ft  
Counted as living area: Yes

Heated: Yes  
Finished: Yes  
Enclosed: Yes  
Contiguous: Yes  
Permitted: Yes  
Wet space: No  
Addition: No  
Conversion: No

### 22 Floor 3 - Bath



Dimensions: 4'9" x 6'1"  
Area: 29 sq. ft  
Counted as living area: Yes

Heated: Yes  
Finished: Yes  
Enclosed: Yes  
Contiguous: Yes  
Permitted: Yes  
Wet space: Yes  
Addition: No  
Conversion: No

### 23 Floor 3 - Bath



Dimensions: 6'9" x 6'1"  
Area: 41 sq. ft  
Counted as living area: Yes

Heated: Yes  
Finished: Yes  
Enclosed: Yes  
Contiguous: Yes  
Permitted: Yes  
Wet space: Yes  
Addition: No  
Conversion: No

599 Viewcrest Drive Northwest, Talus, Issaquah, King  
County, Washington, United States, 98027

### 24 Floor 3 - Balcony



Dimensions: 13'0" x 11'9"  
Area: 152 sq. ft  
Counted as living area: No

Heated: No  
Finished: Yes  
Enclosed: No  
Contiguous: Yes  
Permitted: Yes  
Wet space: No  
Addition: No  
Conversion: No

### 25 Floor 3 - W.I.C.



Dimensions: 5'8" x 7'0"  
Area: 40 sq. ft  
Counted as living area: Yes

Heated: Yes  
Finished: Yes  
Enclosed: Yes  
Contiguous: Yes  
Permitted: Yes  
Wet space: No  
Addition: No  
Conversion: No

### 26 Floor 3 - W.I.C.



Dimensions: 8'7" x 4'8"  
Area: 40 sq. ft  
Counted as living area: Yes

Heated: Yes  
Finished: Yes  
Enclosed: Yes  
Contiguous: Yes  
Permitted: Yes  
Wet space: No  
Addition: No  
Conversion: No

599 Viewcrest Drive Northwest, Talus, Issaquah, King  
County, Washington, United States, 98027

### 27 Floor 3 - Primary Bedroom



Dimensions: 15'6" x 15'10"  
Area: 245 sq. ft  
Counted as living area: Yes

Heated: Yes  
Finished: Yes  
Enclosed: Yes  
Contiguous: Yes  
Permitted: Yes  
Wet space: No  
Addition: No  
Conversion: No

### 28 Floor 3 - W.I.C.



Dimensions: 9'9" x 12'10"  
Area: 112 sq. ft  
Counted as living area: Yes

Heated: Yes  
Finished: Yes  
Enclosed: Yes  
Contiguous: Yes  
Permitted: Yes  
Wet space: No  
Addition: No  
Conversion: No

### 29 Floor 3 - Bedroom



Dimensions: 13'5" x 16'1"  
Area: 181 sq. ft  
Counted as living area: Yes

Heated: Yes  
Finished: Yes  
Enclosed: Yes  
Contiguous: Yes  
Permitted: Yes  
Wet space: No  
Addition: No  
Conversion: No



599 Viewcrest Drive Northwest, Talus, Issaquah, King  
County, Washington, United States, 98027

### 30 Floor 3 - Bath



Dimensions: 5'10" x 7'0"  
Area: 41 sq. ft  
Counted as living area: Yes

Heated: Yes  
Finished: Yes  
Enclosed: Yes  
Contiguous: Yes  
Permitted: Yes  
Wet space: Yes  
Addition: No  
Conversion: No

### 31 Floor 3 - Family Room



Dimensions: 13'5" x 18'9"  
Area: 250 sq. ft  
Counted as living area: Yes

Heated: Yes  
Finished: Yes  
Enclosed: Yes  
Contiguous: Yes  
Permitted: Yes  
Wet space: No  
Addition: No  
Conversion: No

### 32 Floor 3 - WC



Dimensions: 3'4" x 5'9"  
Area: 19 sq. ft  
Counted as living area: Yes

Heated: Yes  
Finished: Yes  
Enclosed: Yes  
Contiguous: Yes  
Permitted: Yes  
Wet space: Yes  
Addition: No  
Conversion: No