

BASEMENT
49'3" X 29'4"

TOTAL: 1856 sq. ft

BELOW GROUND: 0 sq. ft, FLOOR 2: 1856 sq. ft

EXCLUDED AREAS: BASEMENT: 1310 sq. ft, GARAGE: 384 sq. ft, BAY WINDOW: 11 sq. ft

MEASUREMENTS ARE DEEMED HIGHLY RELIABLE BUT NOT GUARANTEED.



TOTAL: 1856 sq. ft

BELOW GROUND: 0 sq. ft, FLOOR 2: 1856 sq. ft

EXCLUDED AREAS: BASEMENT: 1310 sq. ft, GARAGE: 384 sq. ft, BAY WINDOW: 11 sq. ft

MEASUREMENTS ARE DEEMED HIGHLY RELIABLE BUT NOT GUARANTEED.

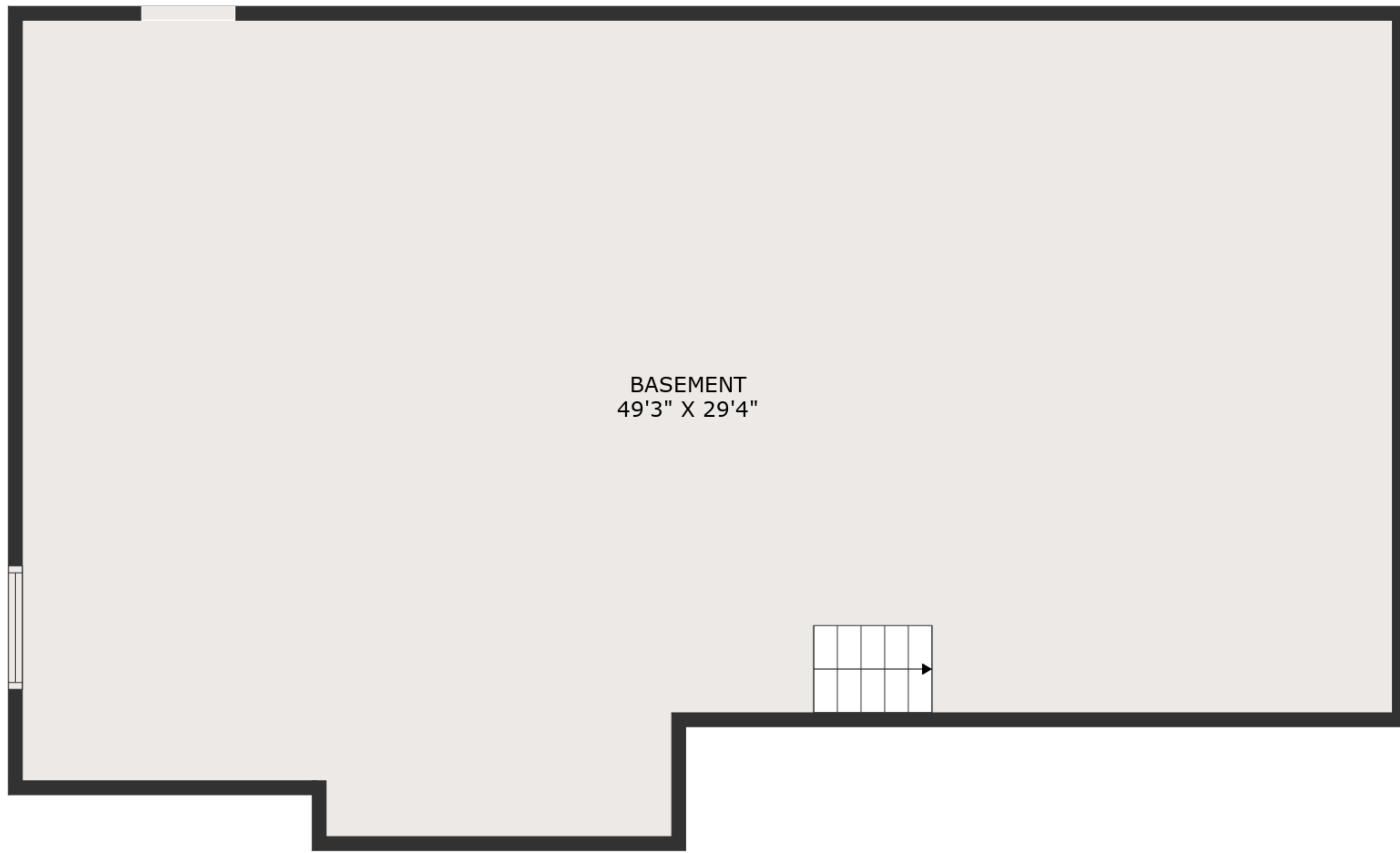

FLOOR 1



FLOOR 2

TOTAL: 1856 sq. ft
 BELOW GROUND: 0 sq. ft, FLOOR 2: 1856 sq. ft
 EXCLUDED AREAS: BASEMENT: 1310 sq. ft, GARAGE: 384 sq. ft, BAY WINDOW: 11 sq. ft

MEASUREMENTS ARE DEEMED HIGHLY RELIABLE BUT NOT GUARANTEED.