

LINE	BEARING	DISTANCE
L1	S 00°37'11\" E	45.54'
L2	S 00°20'16\" E	22.76'
L3	S 89°42'40\" W	50.01'
L4	S 00°22'54\" E	29.98'

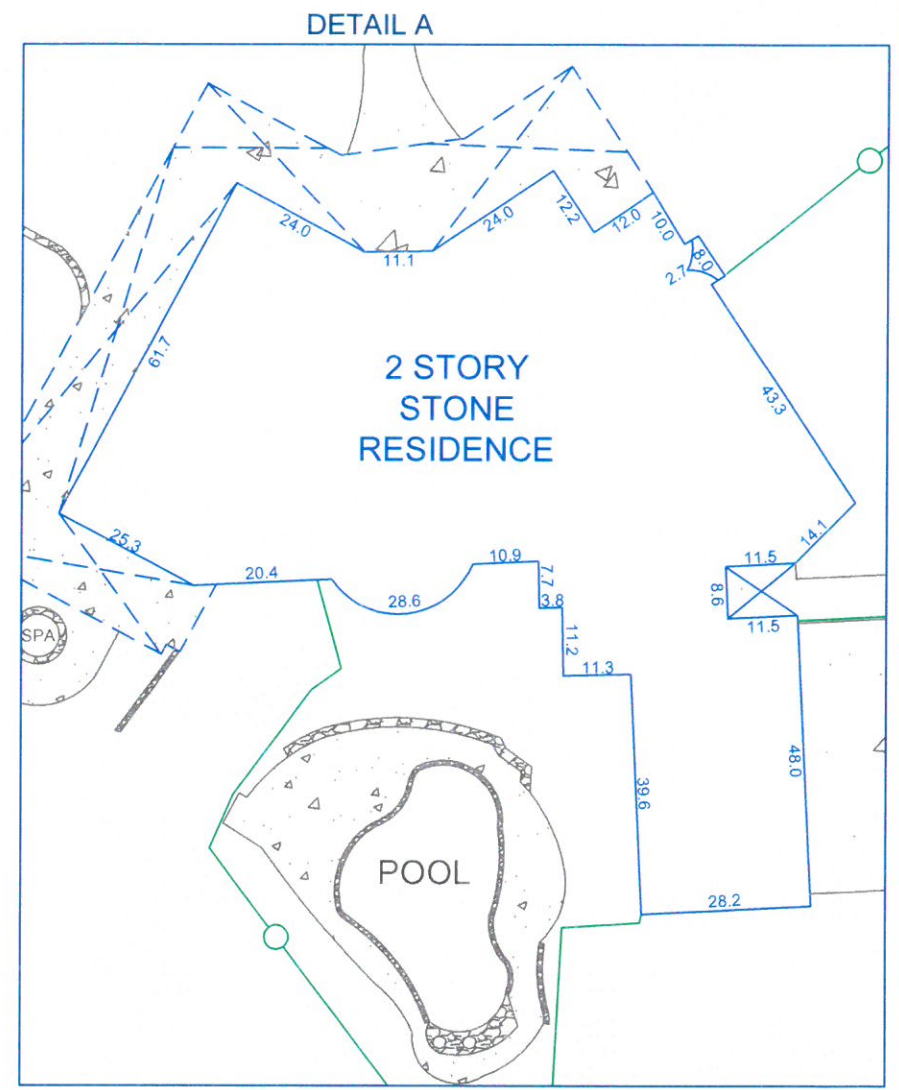

TO ALL PARTIES DIRECTLY INTERESTED IN THE PREMISES SURVEYED
 I have this date directed a careful and accurate survey made on the grounds of the property located at 120 Harbor Lane in the City of Hickory Creek, Denton County, Texas, being Lot 1XR1 in Block F, Steeplechase South Addition, an Addition to the Town of Hickory Creek, Denton County, Texas, according to the Minor Replat thereof, recorded in Document Number 2013-253, Plat Records of Denton County, Texas.

FLOOD STATEMENT: I have reviewed the F.E.M.A. Flood Insurance Rate Map for the Town of Hickory Creek, Community Number 481105 effective date 4-18-2011 and that map indicates as scaled, that this property is within "Non-Shaded Zone X" defined as "Areas determined to be outside the 0.2% annual chance flood (500-year)" as shown on Panel 535 G of said map.

NOTE: This survey is certified to Sendera Title, MICHAEL VANHUSS and American Mortgage & Equity Consultants, Inc. ISAOA/ATIMA.

NOTE: This survey correctly represents the results of an on-the-ground survey made under my direction and supervision on 8-9-2018. There are no visible or apparent intrusions or protrusions except as shown hereon.

- LEGEND**
- ⊞ = ELECTRIC TRANSFORMER
 - = POWER POLE
 - ⊙ = WATER METER
 - ⊕ = WATER VALVE
 - ⊙ = FIRE HYDRANT
 - ⊙ = CABLE RISER
 - B.L. = BUILDING LINE
 - P.U.E. = PUBLIC UTILITY EASEMENT
 - P.A.E. = PRIVATE ACCESS EASEMENT
 - IRF = IRON ROD FOUND
 - CAP/IRF = CAPPED IRON ROD FOUND
 - () = PLAT OR DEED CALL
 - ▭ = CONCRETE

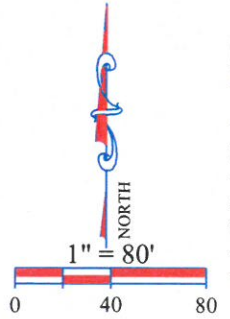

NOTE: Only the followings easements supplied to me by Sendera Title (GF#1802423-VVV), have been reviewed and addressed as follows:

- 10(g.) Volume 431, Page 365 Easement to Texas Power & Light Company; does affect by ingress and egress
- 10(h.) Instrument No. 1996-86573 Easement to Texas Power & Light Company; does affect as shown
- 10(i.) Instrument No. 2005-131570 Easement to Energy Transfer Fuel LP; does affect as shown
- 10(j.) Instrument No. 2011-73251, Easement Agreement between AS Gold, LP and Town of Hickory Creek, Texas; does affect



1720 WESTMINSTER
 DENTON, TX 76205
 (940)382-3446

JOB NUMBER: 130031
 DRAWN BY: MAY
 DATE: 8-10-2018
 R.P.L.S.
 KENNETH A. ZOLLINGER

Y:\JOBS\JOBS_2013\130031\DRAWING\130031-02.dwg 8/10/2018 12:05:56 PM